

Living  
made  
better

Sienna Alto  
Lewisham, SE13 7GH

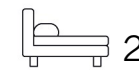

Asking Price £375,000

# Sienna Alto, Lewisham, SE13 7GH

Madison Brook

## Property Summary

A ninth-floor two-bedroom apartment in Sienna Alto, SE13, offering 716 sq. ft. with a private balcony. Features include a bright open-plan reception/kitchen with integrated appliances, principal bedroom with en-suite and built-in wardrobe, second bedroom with fitted storage, and a modern family bathroom. Residents benefit from a 24-hour concierge, roof terrace, and communal spaces. Located just 0.2 miles from Lewisham Station (DLR & Southeastern) and 0.3 miles from Lewisham Shopping Centre.

Service Charge: £2,994.61 pa | Ground Rent: £515.24 pa | Lease Remaining: 112 years

## Floorplan

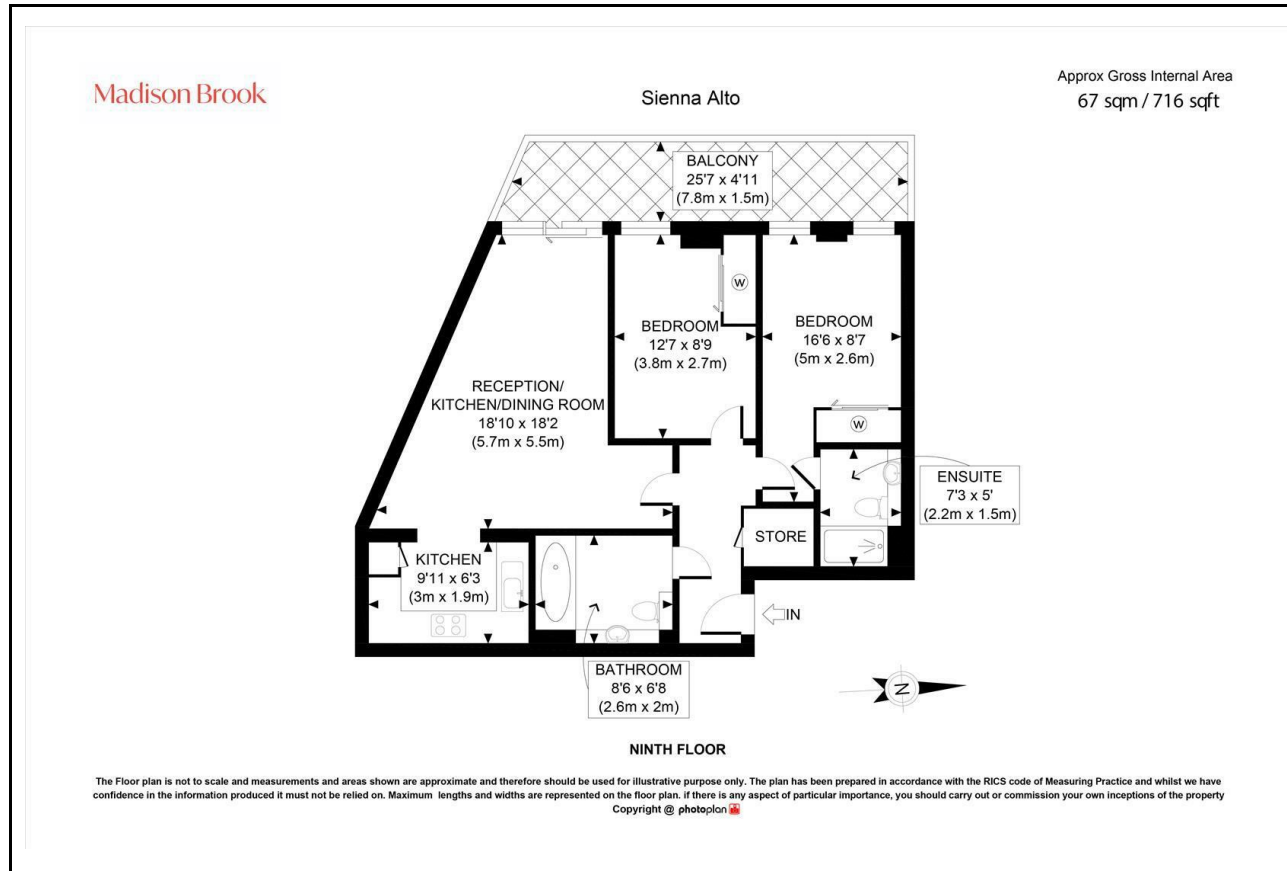

## Area Map

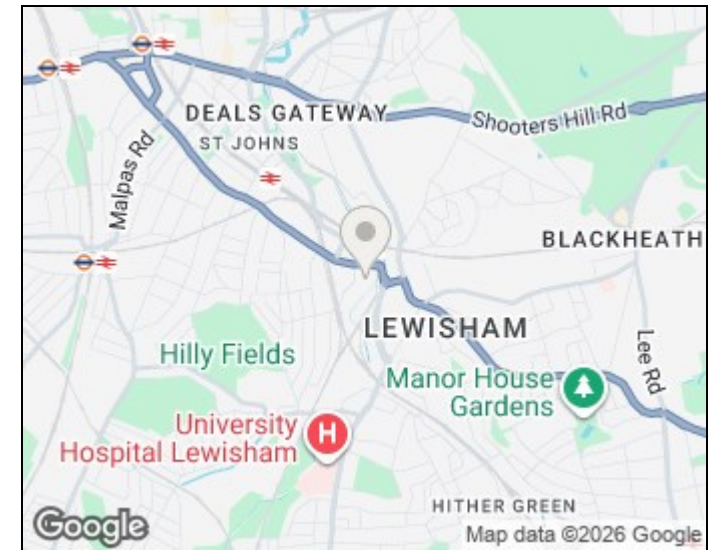

## Energy Efficiency Graph

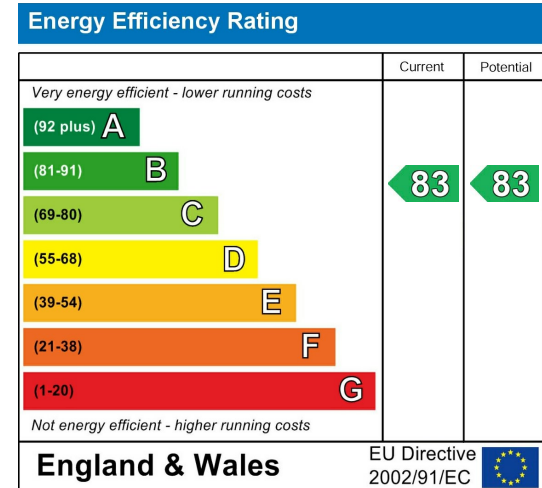

These particulars, whilst believed to be accurate are set out as a general outline only for guidance and do not constitute any part of an offer or contract. Intending purchasers should not rely on them as statements of representation of fact, but must satisfy themselves by inspection or otherwise as to their accuracy. No person in this firm's employment has the authority to make or give any representation or warranty in respect of the property.

43 Loampit Vale, Lewisham, London, SE13 7FT

Tel: 020 3946 6200 Email:

lewisham@madisonbrook.com

<https://madisonbrook.com/>