



3 Bed
Flat
located in

£2,100 Per month



TAYLOR
MICHAEL

Park Crescent, Brighton, BN2 3HA

Approximate Gross Internal Area = 80.6 sq m / 867 sq ft

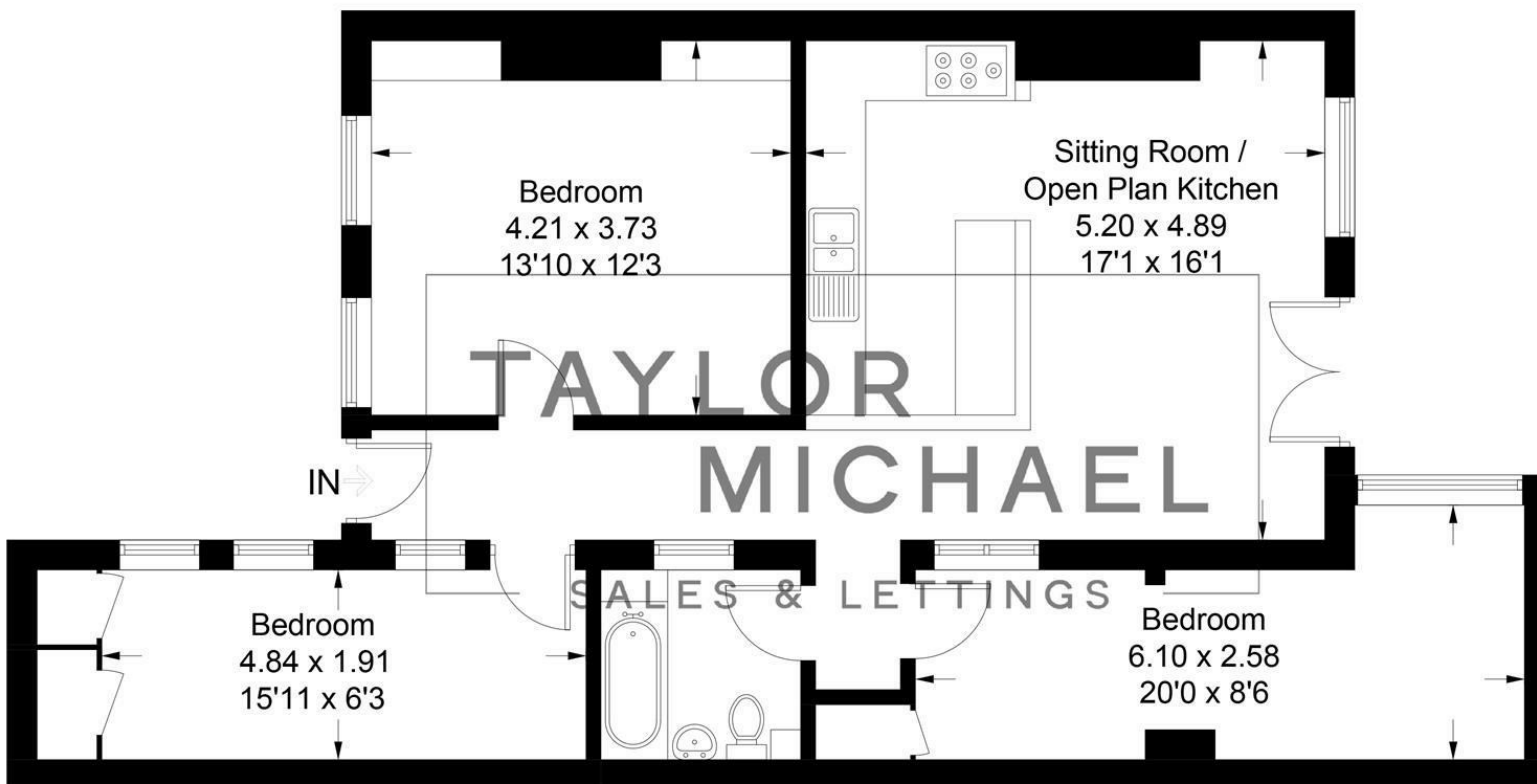

Lower Ground Floor

Illustration for identification purposes only, measurements are approximate, not to scale.
Imageplansurveys @ 2026

Energy Efficiency Rating		Current	Potential
Very energy efficient - lower running costs			
(92 plus)	A		
(81-91)	B		
(69-80)	C	70	80
(55-68)	D		
(39-54)	E		
(21-38)	F		
(1-20)	G		
Not energy efficient - higher running costs			
England & Wales		EU Directive 2002/91/EC	

DIRECTIONS

CONTACT

62 Church Road
Hove
East Sussex
BN3 2FP

E: lettings@taylormichael.agency
T: 01273 600100
<https://taylormichael.agency/>

TAYLOR
MICHAEL