



**POOLE
TOWNSEND**

Chestnut Grove, Ulverston

£175,000

3 1 0



- Excellent semi-detached home
- Great cul-de-sac location close to local amenities
- 2 light and bright reception rooms
- Kitchen requiring fitting
- 3 bedrooms
- Cash buyers only
- Gardens front and rear
- No upper chain
- Freehold
- Council tax band B



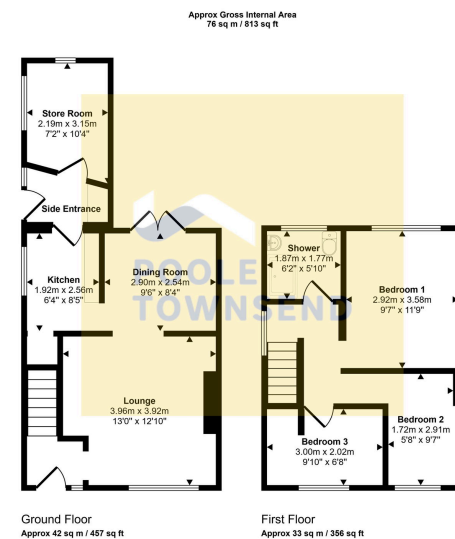

This floorplan is only for illustrative purposes and is not to scale. Measurements of rooms, doors, windows, and any items are approximate and no responsibility is taken for any error, omission or mis-statement. Icons of items such as bathroom suites are representations only and may not look like the real items. Made with Made Snappy 360.

Situated in a peaceful cul-de-sac overlooking an attractive open green, this three-bedroom home offers a quiet yet convenient setting close to local amenities including a leisure centre with gym and pool, the Old Farmhouse pub, Co-op store, schools, and bus routes. Offered to cash buyers due to the need for a kitchen installation, the property presents an excellent opportunity to personalise, with many improvements already completed alongside gas central heating and double glazing. Offered with no onward chain the accommodation includes a welcoming hall, front-facing lounge opening into a dining area with glazed doors to the rear garden, and a kitchen space ready for fitting with access to a rear hall and store. Outside, there is an enclosed front garden and a two-tier rear garden with lawn and pond, while upstairs offers three bedrooms—two with distant views towards Hoad and Morecambe Bay—and a modern shower room.

Visit us at
www.pooletownsend.co.uk
enquiries@pooletownsend.co.uk

We are open
 Monday – Friday 9.00 – 5.00
 Saturday 9.00 – 1.00

Barrow 01229 811811
 Ulverston 01229 588111
 Grange 015395 33316
 Kendal 01539 734455
 Milnthorpe 015395 62044