



5 Brook Terrace Hooley Lane.
Redhill

Guide Price **£380,000**



This modern two bedroom mid-terrace home offers an ideal opportunity for first-time buyers, professionals, or those seeking a convenient and stylish residence in a popular location. Upon entering the property, you are welcomed by a thoughtfully designed entrance hall that leads to a practical cloakroom with WC, providing every-day convenience for residents and guests alike. The heart of the home is the spacious open plan living room situated to the rear of the property, creating a bright and sociable space perfect for relaxing, dining, or entertaining. The kitchen is fitted with contemporary units and integrated appliances, ensuring a sleek and functional environment for cooking and meal preparation. The living area benefits from ample natural light, creating a warm and inviting atmosphere throughout the day. Upstairs, the property boasts two well-proportioned bedrooms, each featuring built-in wardrobes that offer generous storage solutions while maintaining a streamlined and clutter-free aesthetic. The main bathroom is tastefully appointed with modern fixtures and fittings, providing a comfortable and elegant space for daily routines. Additional features include double glazing and efficient heating, contributing to the property's excellent energy performance and year-round comfort. An allocated parking space is provided, ensuring convenience for residents and visitors. The property is situated in a highly sought-after location, just a short distance from local shops, amenities, and the train station, making it an excellent choice for commuters and those who value easy access to transport links. The surrounding area offers a vibrant community atmosphere with a range of services and facilities nearby, supporting a comfortable and practical lifestyle.

Council Tax band: TBD.. Tenure: Freehold





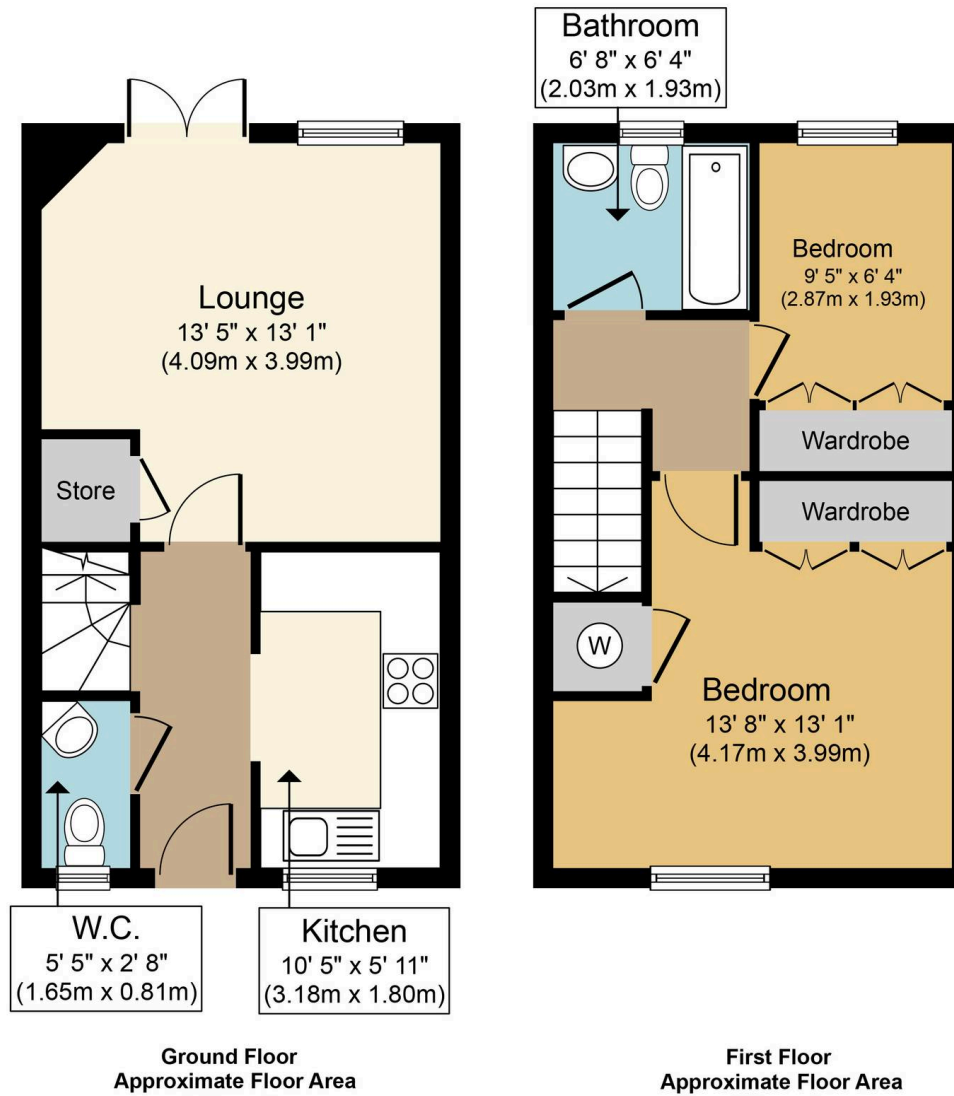

Hooley Lane, RH1



Approx. Gross Internal Total Floor Area 645 sq. ft. / 60 sq.m.

Whilst every attempt has been made to ensure the accuracy of the floor plan contained here, measurements of doors, windows, rooms and any other items are approximate and no responsibility is taken for any error, omission, or mis-statement. This plan is for illustrative purposes only and should be used as such by any prospective purchaser or tenant. The services, systems and appliances shown have not been tested and no guarantee as to their operability or efficiency can be given.