



## Malden Road, NW5

### £650,000

A two double bedroom flat in a period conversion with its own private entrance. The property has a large reception/dining room, is in great condition throughout and has a lovely secluded garden.

Malden Road is conveniently located off Prince of Wales Road, the nearest tube station being Chalk Farm (Northern line) and also close to Kentish Town West overground station, local bus services, shops & cafés.

### Features

- Two Bedrooms
- One Bathroom
- Private Garden
- Share Of Freehold
- Private Entrance
- Great Location

# Malden Road, London, NW5

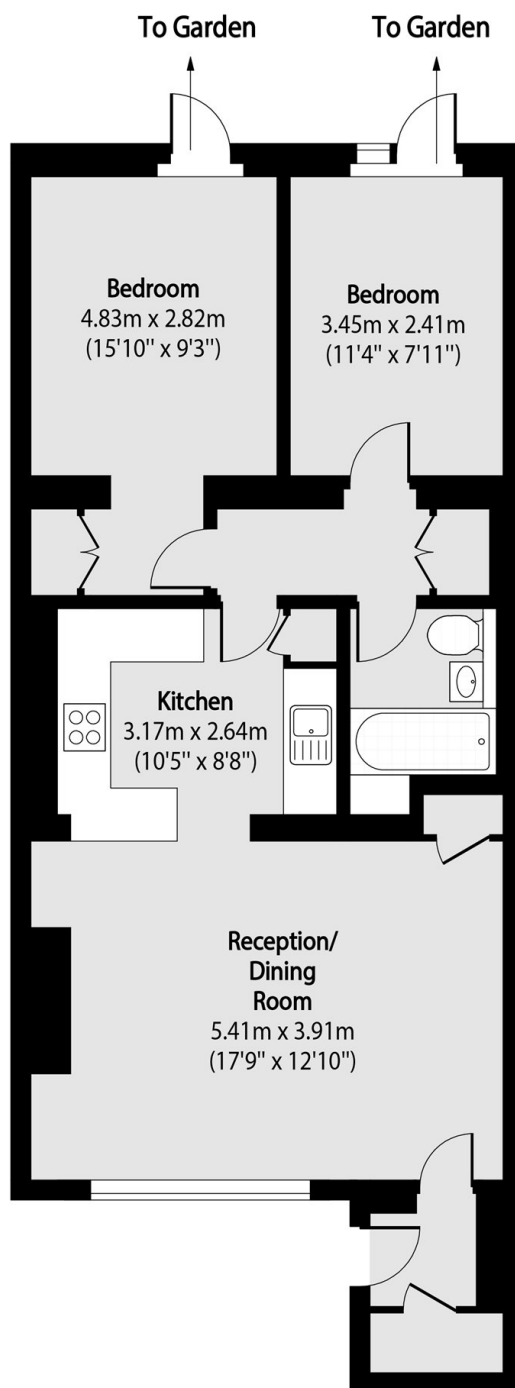

Total area (approx): 65.59 sq m (706 sq. ft)