



Guide Price
£210,000

Leasehold

1x  1x  1x 

**Ringstead Road, Sutton,
Surrey, SM1**

OVER 60?

Secure this property
for up to **59% less!**

cubitt & west
Helping you move forwards



Main features

- Easy to access ground floor apartment
- Immaculate condition throughout
- Garage en-bloc
- Walking distance to Sutton Town centre & High Street
- 149 years remaining on the lease

Accommodation

GROUND FLOOR

Entrance Hall

Lounge/Diner: 17'7 x 10'6 (5.36m x 3.20m)

Kitchen: 8'5 x 5'7 (2.57m x 1.70m)

Bedroom: 10'3 x 8'3 (3.13m x 2.52m)

Bathroom

OUTSIDE

Garage

Communal Gardens

Ground Floor

Approx. 42.7 sq. metres (459.8 sq. feet)

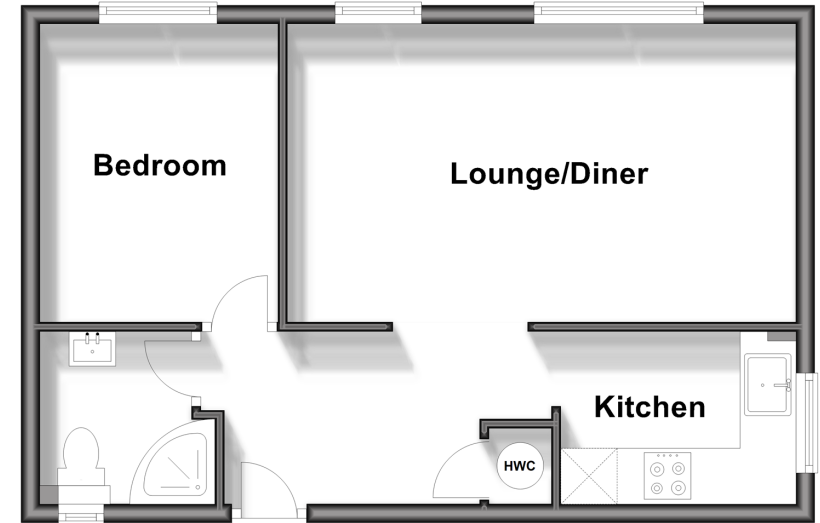

Call Sutton - 020 8661 0330 ■ cubittandwest.co.uk

- Legal advice should be taken to verify fixtures/fittings, planning, alterations and/or lease details
- Appliances & services are untested, dimensions are approximate and floor plans are not to scale
- Through a Homewise Home For Life Plan people aged 60+ can secure this property for up to 59% less, by purchasing a Lifetime Lease.



22015555/20250703/LJ/KWK