

abbotFox



ROUTE NOTICE
NO PARKING
PLEASE LEAVE
CLEAR

7

11

Town End, Mundesley, NR11
£200,000

“

We are a team of genuine individuals who hold a deep passion for both property and marketing. Collectively, we bring over 70 years of experience in the property market of Norfolk and Suffolk. Our affection for both counties runs deep, and we are enthusiastic about sharing our passion with you.

Colin McKenzie | **Branch Partner**







THE DETAIL _____

abbotFox presents this charming two bedroom cottage, set within the heart of Mundesley and offering direct access to the cliff top.

Beautifully positioned to enjoy all the lifestyle benefits of this popular coastal village, this mid-terrace home offers a cosy lounge, practical kitchen diner and two well-proportioned bedrooms.

Outside, the private rear garden provides a peaceful retreat and enjoys the rare benefit of direct access onto the cliff top, opening to some of North Norfolk's most spectacular views and coastal walks.

An ideal choice for those seeking a permanent home, holiday retreat or investment within this ever-desirable village, this cottage demands an internal viewing to be appreciated.







THE HIGHLIGHTS _____

- Mid-terrace cottage
- Two double bedrooms
- Direct access to cliff top
- Spectacular coastal views
- No onward chain
- Viewing advised

26.2 sq.m. (282 sq.ft.) approx.

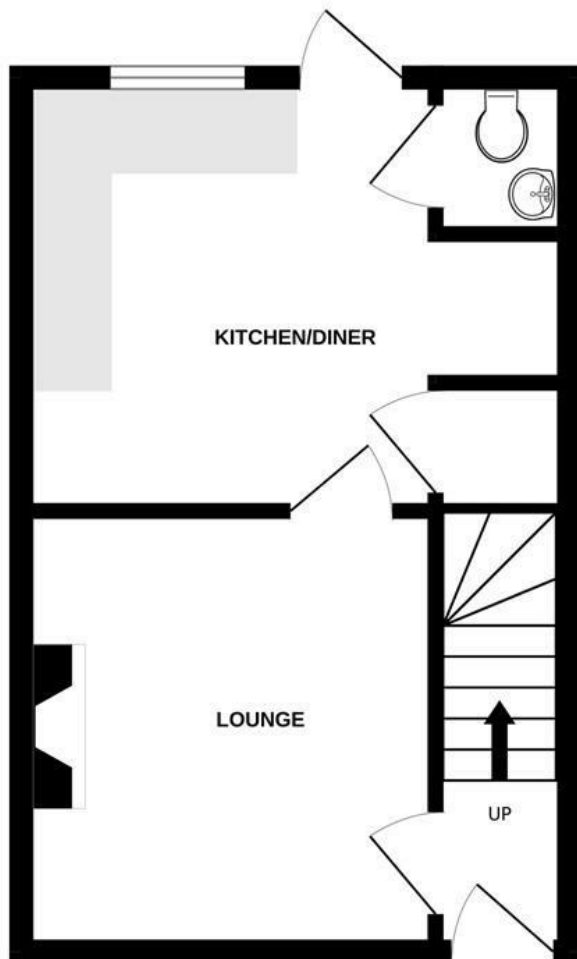

26.7 sq.m. (287 sq.ft.) approx.

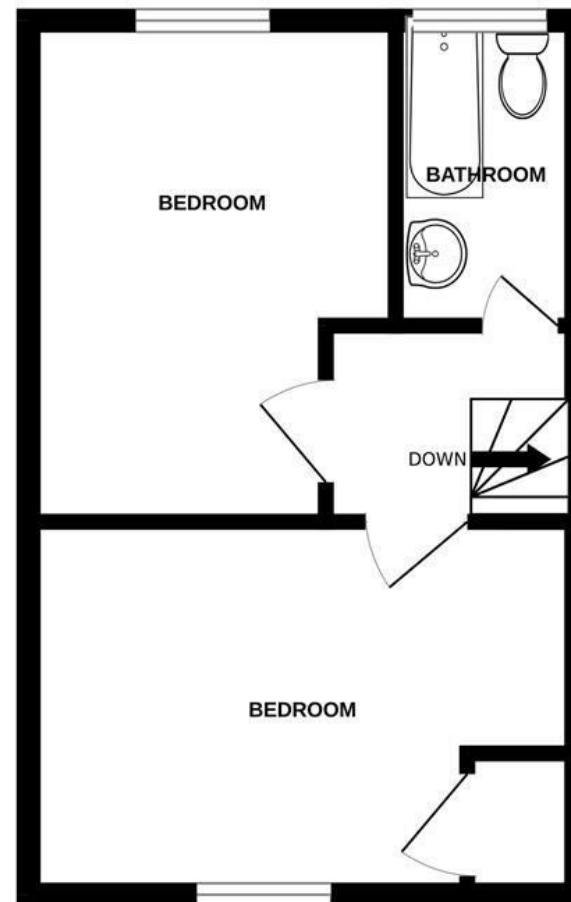

TOTAL FLOOR AREA : 52.9 sq.m. (569 sq.ft.) approx.

Whilst every attempt has been made to ensure the accuracy of the floorplan contained here, measurements of doors, windows, rooms and any other items are approximate and no responsibility is taken for any error.

Let's talk

01603 660000

sales@abbotfox.co.uk

@abbotfox

EPC RATING -

Disclaimer – In accordance with the Property Misdescriptions Act, the company abbotFox gives notice that all descriptions, references to condition, necessary permissions for use and other details are given in good faith and believed to be correct, but any purchaser should not rely on them as statements of fact, and must satisfy themselves by inspection or other means, as to their accuracy.