



3 Bed
Flat - Purpose Built
located in

Guide price £400,000



TAYLOR
MICHAEL

Drive Lodge, 68-70 The Drive, Hove, BN3 3PS

Approximate Gross Internal Area = 91.3 sq m / 983 sq ft

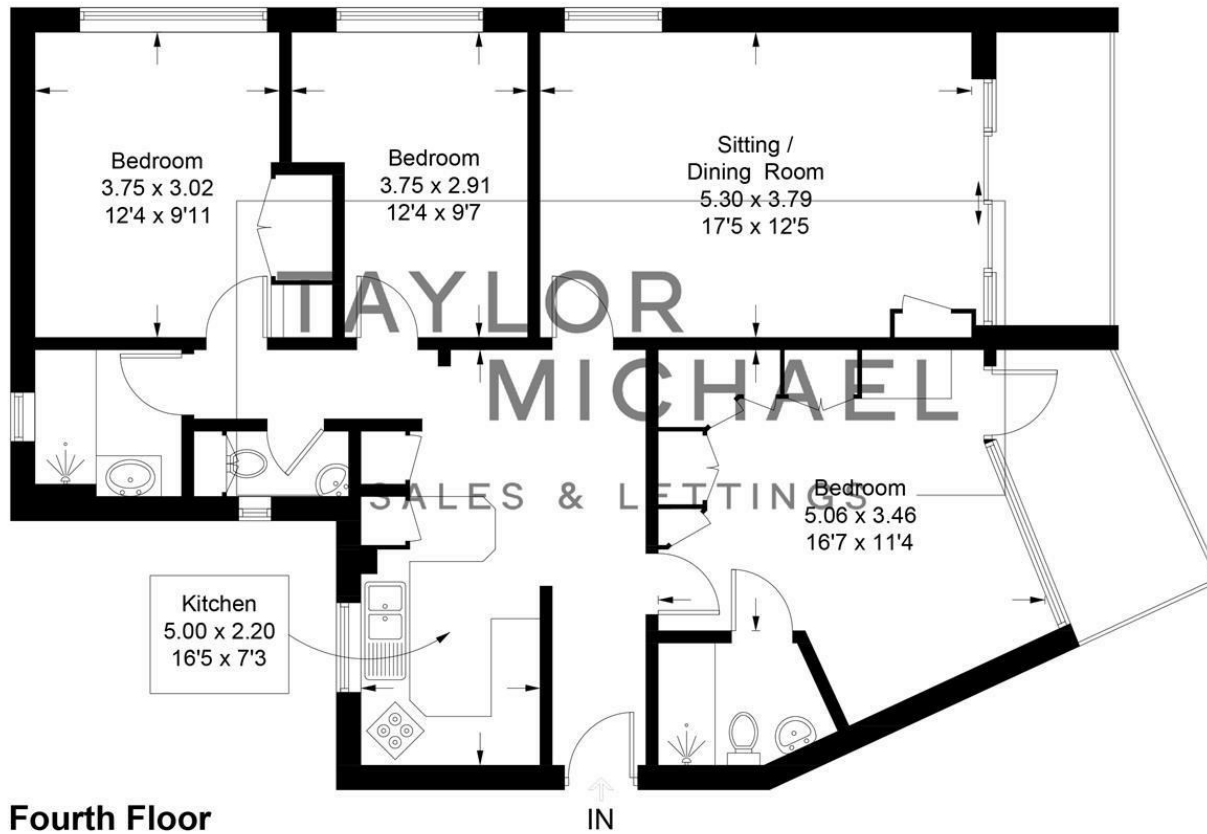
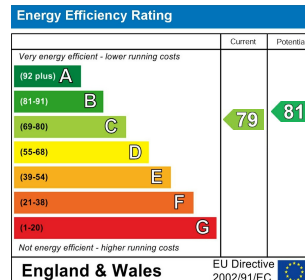

Illustration for identification purposes only, measurements are approximate, not to scale.
Imageplansurveys @ 2026



DIRECTIONS

CONTACT

62 Church Road
Hove
East Sussex
BN3 2FP

E: lettings@taylormichael.agency
T: 01273 600100
<https://taylormichael.agency/>

TAYLOR
MICHAEL