



Caernarvon Close, Mitcham, CR4

Offers In Excess Of £200,000

TA
UK[®]

Key Features

- No Onward Chain
- Bright Triple Aspect Kitchen/Reception Room
- Modern Kitchen with Breakfast Bar
- One Double Bedroom
- Home Office/Study Room
- Convenient for Transport Links/Amenities
- EPC Rating D



Offering No Onward Chain is this one double bedroom, top floor flat with triple aspect Kitchen/Reception Room and study.





No Onward Chain! Located in Caernarvon Close, this bright and well-presented one double bedroom top-floor flat offers generous space, modern living and a rare triple-aspect layout that fills the home with natural light throughout the day.

The standout feature is the open-plan kitchen/reception room, benefiting from windows on three sides and a stylish breakfast bar, creating a sociable and airy space ideal for relaxing or entertaining. The property also includes a well-proportioned double bedroom, a modern bathroom, and the added advantage of a separate study — perfect for home working, hobbies or additional storage.

Situated in a residential cul-de-sac close to Mitcham Common, local transport links and everyday amenities, this flat is an excellent choice for first-time buyers, downsizers or investors seeking a practical and comfortable home in a well-connected location.



Approximate Gross Internal Area 494 sq ft - 46 sq m

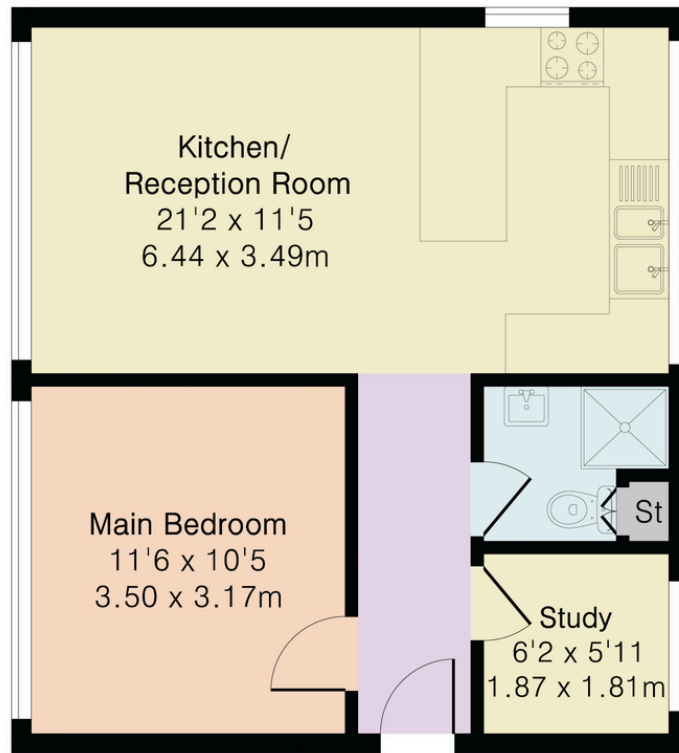

Second Floor

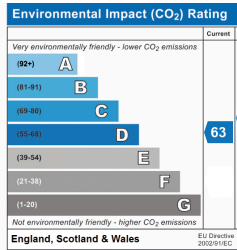
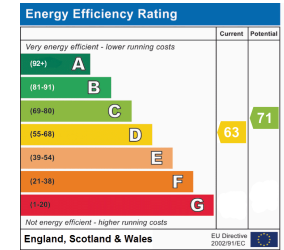

Tenure Type: Leasehold
 Council Tax Band: C
 Council Authority: Merton