



## Petersfield Road, W3

£499,950

A ground floor maisonette spanning over 750 sq ft of living space within a quite residential road on the borders of Chiswick. The property has two good size double bedrooms, with the principle bedroom having direct access to an en suite bathroom. At the rear of the property is a separate kitchen with the reception leading out onto a low maintenance garden. Petersfield Road is within the catchment area of Ark Primary School.

Situated on the borders of Chiswick, the property benefits from superb transport links via Acton Town and Turnham Green Underground stations, as well as Acton Central Overground. Families will appreciate its location, within the catchment area for Ark Primary School (rated Outstanding by Ofsted).

### Features

- Two Bedrooms
- Two Bathroom
- Maisonette
- Freehold
- Own Entrance
- Private Garden

Petersfield Road,  
London, W3

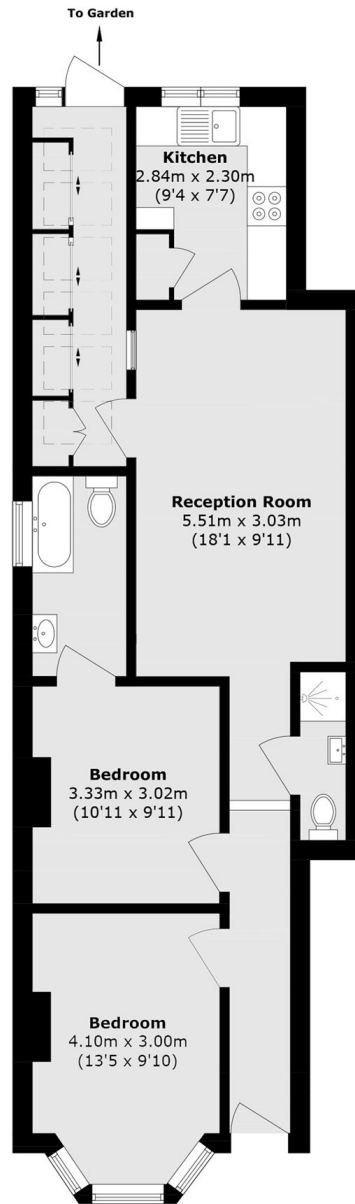

**Ground Floor**

Total area (approx.): 70.2 sq. m (755.6 sq. ft)