



GARDEN HOUSE, W2

£680,000

One double bedroom
Communal gardens
Fantastic location
988 Years left on lease
Excellent transport links
EPC- C

@marshandparsons
marshandparsons.co.uk

MARSH &
PARSONS



ABOUT THE PROPERTY

A modern and bright raised ground floor flat set within a period building overlooking a garden square.

The property is wonderfully positioned just off Westbourne Grove, with its superb selection of boutique shops, cafés and restaurants right on the doorstep, while the expansive green open spaces of Hyde Park are just moments away. Further enhancing its appeal is access to private communal gardens, along with excellent transport links nearby at Notting Hill Gate, providing convenient access to the Central line and beyond.



STEP INSIDE GARDEN HOUSE

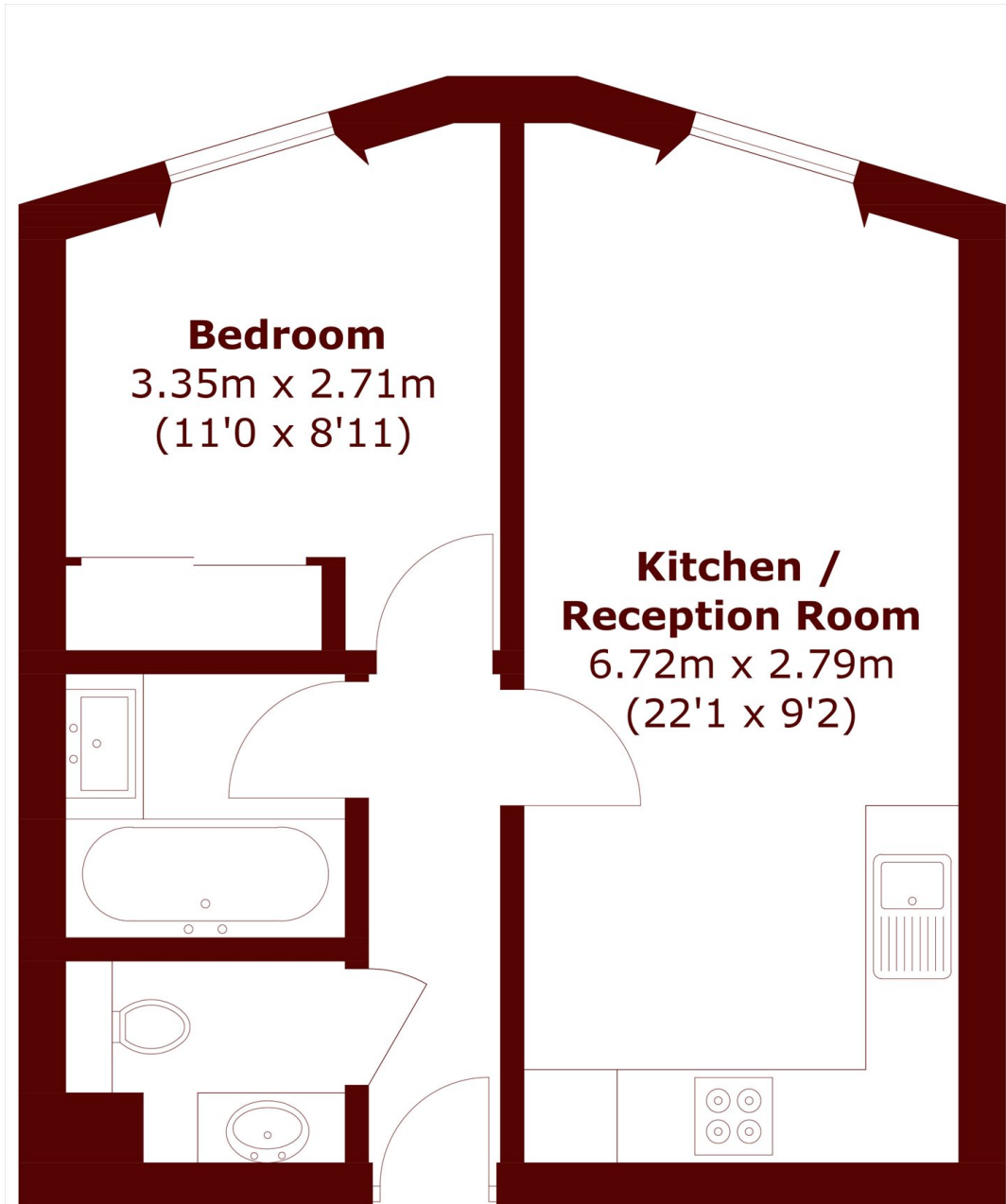

Total area (approx.): 37.1 sq. m (399.3 sq. ft)

Notting Hill
020 7313 2890

Energy Rating: C We aim to make our particulars both accurate and reliable. However, they are not guaranteed; nor do they form part of an offer or contract. If you require clarification on any points then please contact us, especially if you're traveling some distance to view. Please note that appliances and heating systems have not been tested and therefore no warranties can be given as to their good working order

**MARSH &
PARSONS**