



**HENDERSON
CONNELLAN**
ESTATE AGENTS

William Street, Kettering NN16

"A Walk In The Park"

3 1 2



"A Walk In The Park"

Lovely Park walks are virtually on the door step of this attractive period, bay fronted Town House. Rockingham Pleasure Park offers the tranquillity of a tree lined boulevard, Victorian Band Stand, Bowling Green as well as a play area and outdoor gym, the town centre, Park Road Primary school and a wealth of amenities are within easy reach. The interior is accessed via a period front door with stained glass leaded inserts, the entrance hall leads to a living room with bay window and gas fire, there is a separate dining room and the brand new designer kitchen has an integrated oven, hob and extractor. Upstairs there are three bedrooms, two in which are double in size and a principal shower room. Outside the fore garden is enclosed by brick walling and the rear garden offers a good degree of privacy. Come and see for yourself.

NB Please note some photographs have been digitally enhanced to create dressed rooms.

Living Room - 3.58m x 3.58m (11'9" x 11'9")

Dining Hall - 3.68m x 3.58m (12'1" x 11'9")

Kitchen - 4.47m x 2.57m (14'8" x 8'5")

Outbuilding - 3.58m x 1.7m (11'9" x 5'7")

Bedroom 1 - 5.18m x 3.58m (17'0" x 11'9")

Bedroom 2 - 3.58m x 3.38m (11'9" x 11'1")

Bedroom 3 - 2.57m x 2.49m (8'5" x 8'2")

Shower Room - 1.91m x 1.63m (6'3" x 5'4")





- Three bedrooms
- Gas central heating
- UVPC double glazed windows
- Modernised by the current owners
- Spacious accomodation throughout
- NO CHAIN
- EPC RATING: D
- COUNCIL TAX: B

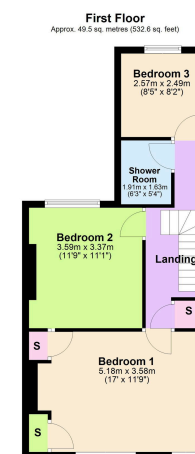
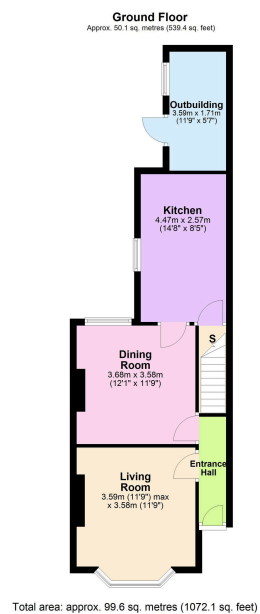

Disclaimer: These particulars do not form part of any offer or contract and should not be relied upon as statements or representations of fact. Any areas, measurements of distances are approximate. The text, photographs and plans are for guidance only and are not necessarily comprehensive.

15-16 Market Place, Kettering,
Northamptonshire, NN16 0AJ

