





MALLINSON  
& CO

INNOVATIVE PROPERTY EXPERTS



**Oakwood Road, Royston, Barnsley, S71 4EZ**

**Offers Over £475,000**

 4  3  2



- DETACHED
- 4 BEDROOMS
- BESPOKE OPEN PLAN LIVING KITCHEN & UTILITY
- 2 EN SUITE BEDROOMS
- BEAUTIFULLY PRESENTED THROUGHOUT
- INTEGRAL GARAGE & DRIVEWAY
- PRIVATELY ENCLOSED REAR GARDEN
- VIEWS OVER PLAYING FIELDS
- HIGH QUALITY FIXTURES & FITTINGS
- CLOSE TO LOCAL AMENITIES, SCHOOLING & TRANSPORT LINKS TO BARNSELY & WAKEFIELD





A TRULY IMPRESSIVE AND CONTEMPORARY THREE-STOREY FAMILY HOME! ... OAKWOOD HOUSE OFFERS EXCEPTIONAL OPEN-PLAN LIVING, STRIKING ARCHITECTURAL FEATURES AND GENEROUS ACCOMMODATION THROUGHOUT. DESIGNED WITH MODERN LIFESTYLES IN MIND, THE PROPERTY ENJOYS FAR-REACHING VIEWS OVER ADJACENT PLAYING FIELDS TO THE REAR AND BENEFITS FROM HIGH-QUALITY FINISHES INCLUDING UNDERFLOOR HEATING, BESPOKE KITCHEN AND BATHROOMS, AND FEATURE GLAZING. SET BEHIND A SUBSTANTIAL DRIVEWAY WITH INTEGRAL GARAGE, THIS OUTSTANDING HOME DELIVERS SPACE, STYLE AND VERSATILITY IN EQUAL MEASURE.

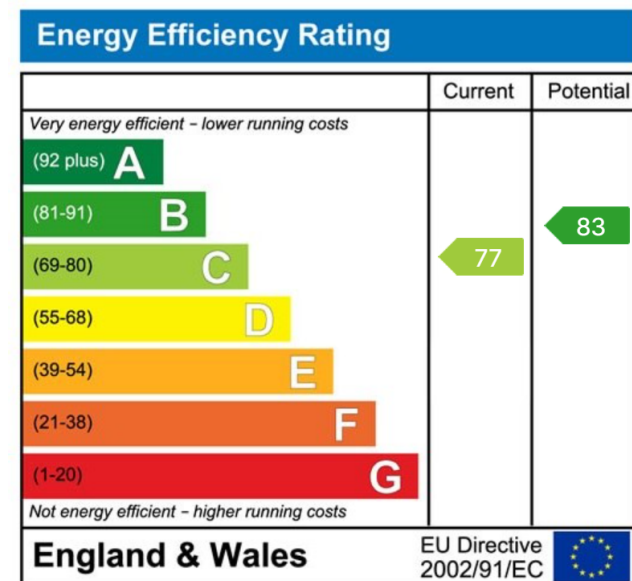
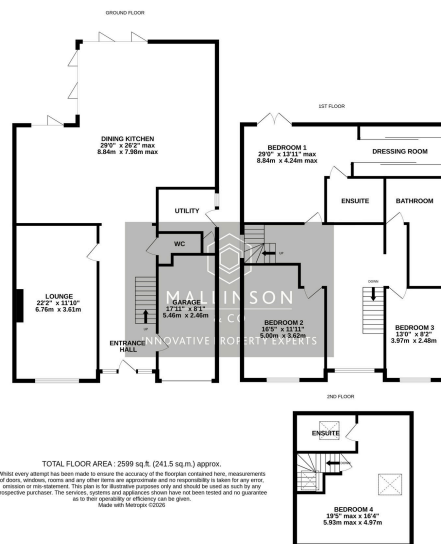

INNOVATIVE  
PROPERTY  
EXPERTS

**Mallinson & Co**

Office: 01226 414 150

Email: [ben@mallinsonandco.co.uk](mailto:ben@mallinsonandco.co.uk)

Web: [www.mallinsonandco.co.uk](http://www.mallinsonandco.co.uk)

Suite 6, Penistone 1, St. Mary's Street, Penistone, S36 6DT