

30



W
WHITES

30, Belle Vue Road, Salisbury, SP1 3YG

A beautifully presented, three bedroom, unfurnished character property situated within the city centre with modern kitchen and bathroom and enclosed gardens.

- Mid terrace period house.
- City centre location.
- Open plan living room.
- Modern fitted kitchen.
- Three bedrooms.
- Modern bathroom with shower over the bath.
- Enclosed rear garden with shed.
- Gas central heating.
- Double glazing.
- EPC Band D.

£1,400 PCM





About The Property

A beautifully presented, three bedroom, unfurnished character property situated within the city centre with modern kitchen and bathroom and enclosed gardens.

Accommodation comprises:

Entrance porch. Bright and spacious living room with bay window and under stairs storage cupboard. Modern fitted kitchen with gas hob, electric oven, dishwasher and washing machine, space for a fridge/freezer and French doors onto the garden.

Upstairs; bedroom one, double with bay window. Bedroom two, double with feature fireplace. Modern family bathroom with thermostatic shower over the bath. Bedroom three, single/study.

Outside; enclosed rear garden with terrace and steps down onto the lawn. Storage shed.

The property benefits from gas central heating, UPVC double glazing and on street permit parking.





Location

To delete all this text quicky - open the text box, then hold CRT and A - this will highlight all text in the box. Then you can press delete.

[Copy village description Mimi has given you into here (from the word document)].

For more info on the villages / to help with the timings below, you can also look at the villages on our website - they give you lots of useful information like pub names, shops, etc.

You can find them by searching the village name on our website's serach bar, and clicking on the village page.

---> for the box to the right - that should contain the hand drawn map of the area. You can add this by clicking 'New Selection' -> Library Image -> 'Handdrawn Area Map - XXX area'.

Once you have added the map to the brochure, hold down the Shift Key to resize it (this means it will resize proportionally, so will be much easier for you to fit in the box!). Once you have dragged the map to the correct size, take your finger off

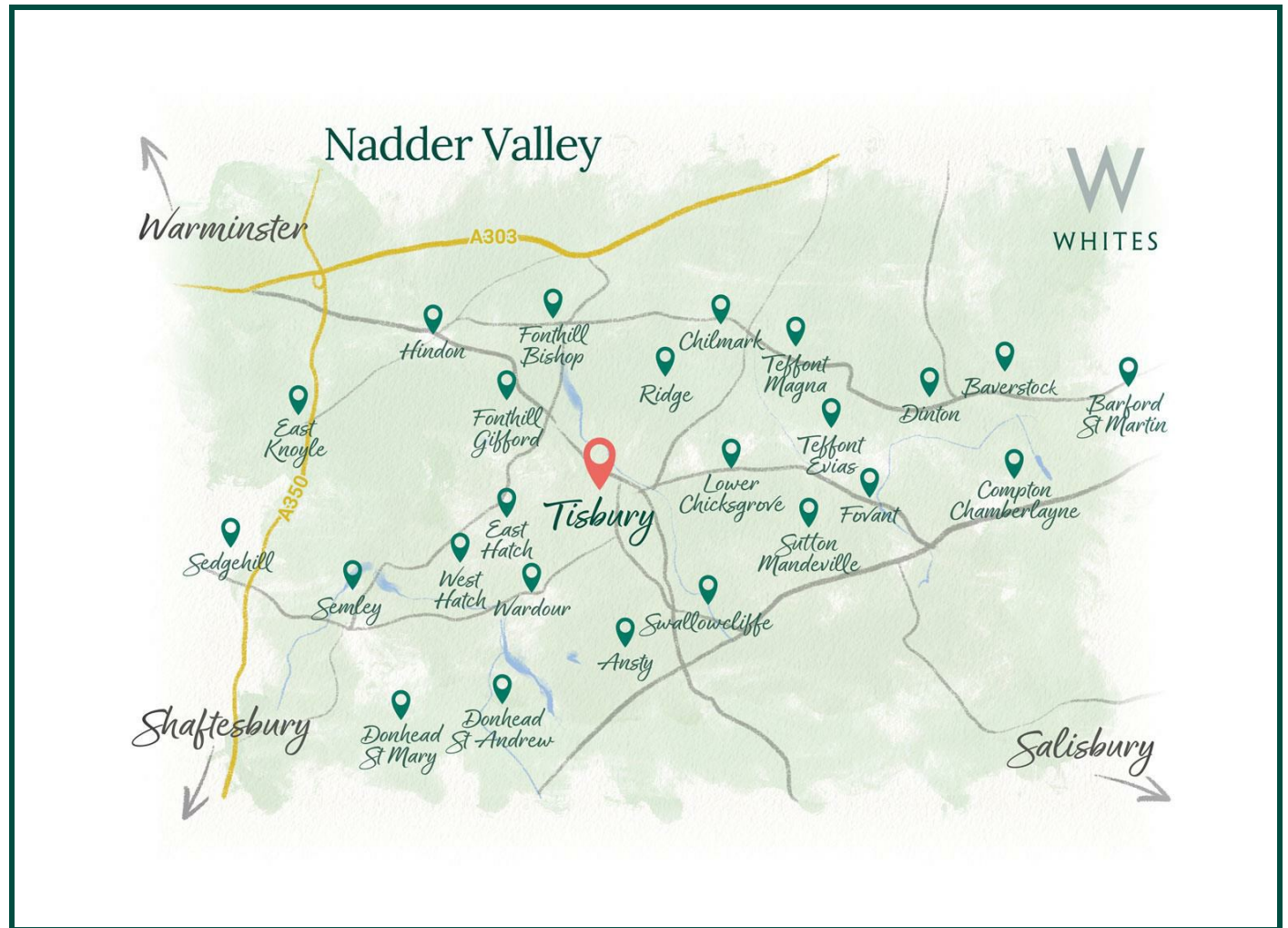

Southampton Central: 30 mins
Bath Spa: 1 hr
London Waterloo: 1 hr 28 mins



Salisbury: X mins
Bath: X hr X mins
London: X hr X mins



Local school: X mins
Local public house: X mins
Local amenities: X mins

Key Information

Local Authority:

Wiltshire Council

Council Tax:

Band: D - £XXXXX (2025/2026)

Property Type:

House - Terraced

Floor Area:



904.00 sq ft

Let Available Date:

10th April 2026 NB: This date is provisional and will only be confirmed once referencing has been successfully completed.

Furnish Type:

Unfurnished

Deposit:

£1,615

EPC:

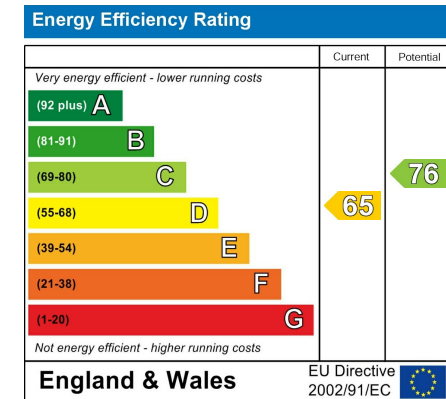

Belle Vue Road, Salisbury, SP1

Approximate Area = 904 sq ft / 83.9 sq m

For identification only - Not to scale

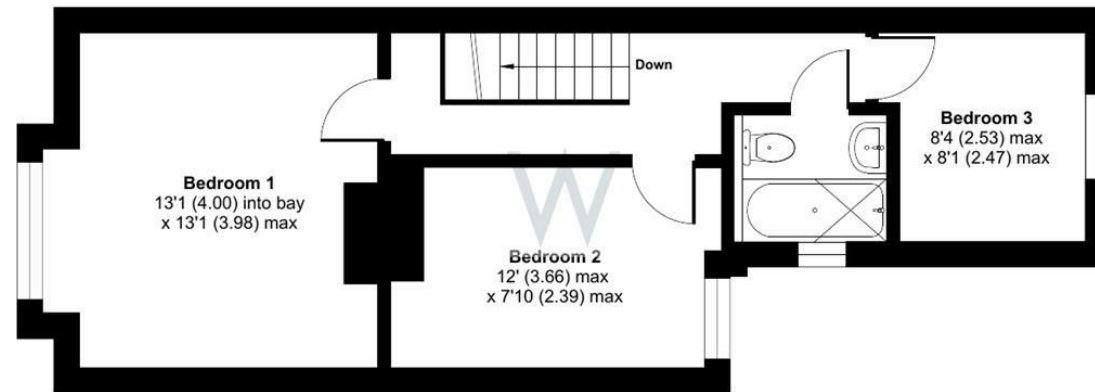

FIRST FLOOR

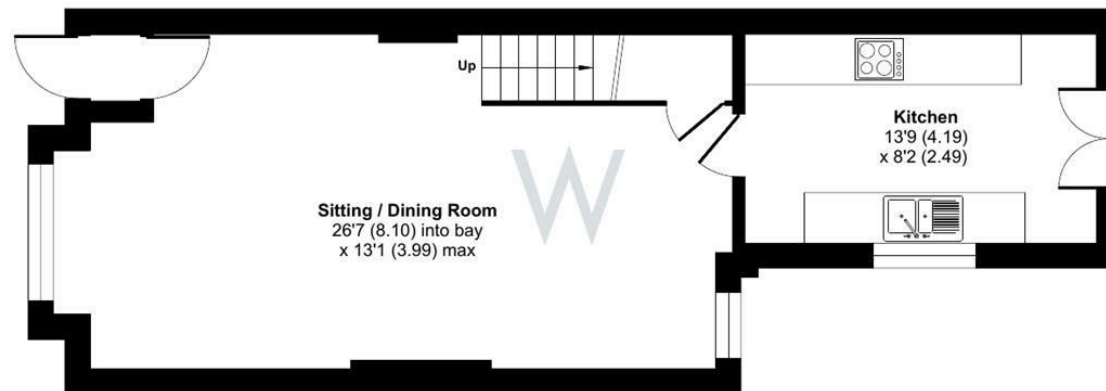

GROUND FLOOR



Floor plan produced in accordance with RICS Property Measurement Standards incorporating International Property Measurement Standards (IPMS2 Residential). © nichecom 2026. Produced for H W White Ltd. REF: 1431298

