



# HIVE

2 ROWAN CLOSE  
ST LEONARDS  
RINGWOOD  
BH24 2RE



*presented by*  
PAUL DEHON & ANJI HAZELL  
01202 122 252





## *Agent's introduction*

This spacious three bedroom detached bungalow is in need of updating, and presents an exciting opportunity for the new owner to put their stamp on it! The property is located in a small, peaceful cul-de-sac in the heart of St Leonards, close to the protected heathland of Lions Hill.













## *Property highlights*

Spacious living room

Double glazed conservatory

Open plan kitchen/dining room

En-suite shower room, bathroom and additional cloakroom

Landscaped low maintenance gardens with Purbeck stone-edged flower beds

Single garage with utility room to rear

No forward chain





PAUL DEHON

HIVE Partner for Ferndown/Ringwood

This bungalow offers spacious and versatile accommodation and will make a lovely home. The property is situated in close proximity to both Avon Country Park and the beautiful Moors Valley Country Park. The market town of Ringwood is just a couple of miles away offering a comprehensive range of shops, cafés, restaurants, and two leisure centres.



Scan the QR code for my latest property listings and social channels.

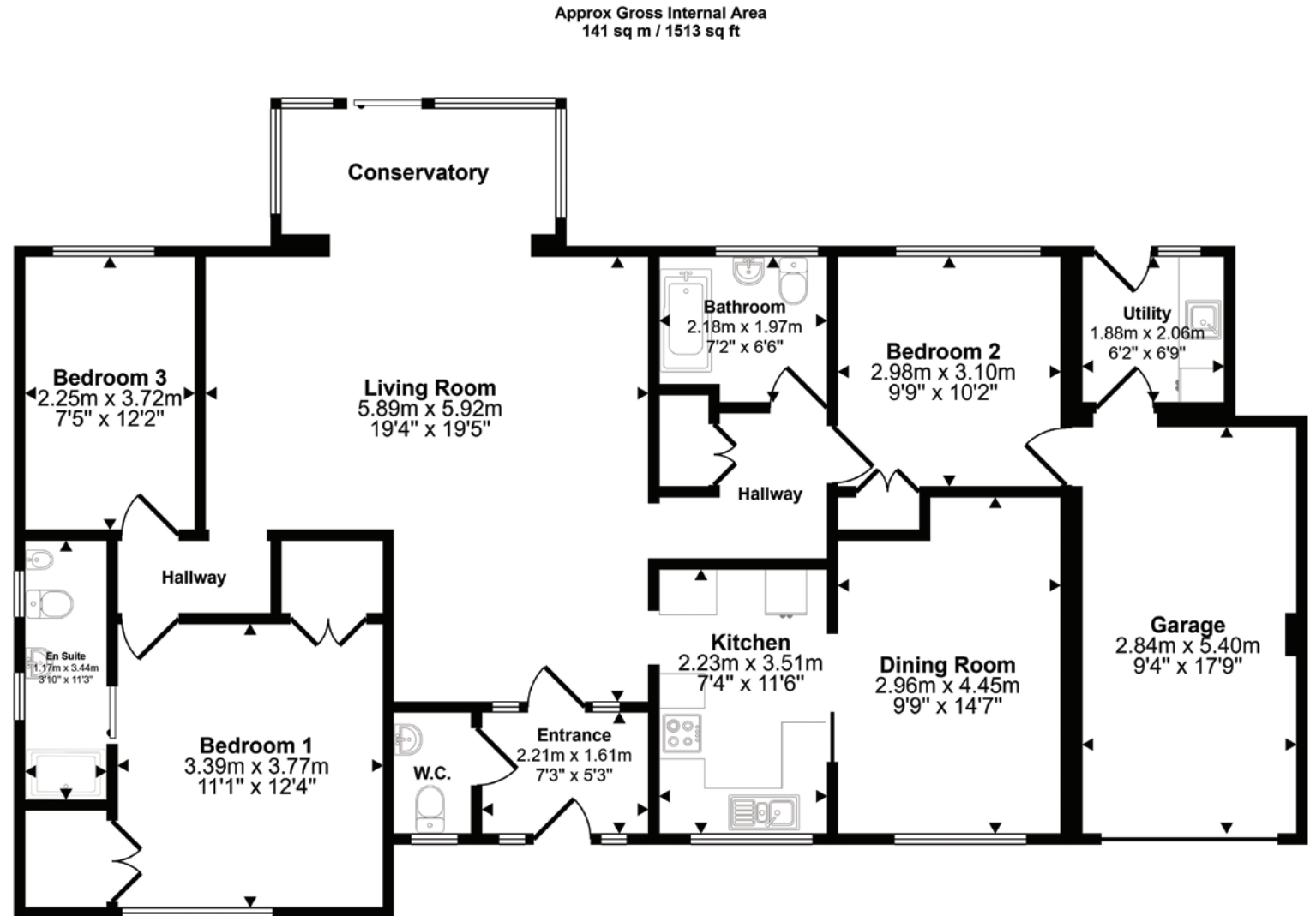

Floorplan

This floorplan is only for illustrative purposes and is not to scale. Measurements of rooms, doors, windows, and any items are approximate and no responsibility is taken for any error, omission or mis-statement. Icons of items such as bathroom suites are representations only and may not look like the real items. Made with Made Snappy 360.









**HIVE & Partners, Ringwood, Ferndown, West Parley, Verwood & Wimborne,** c/o The Hive, Wilson House, 2 Lorne Park Road, Bournemouth BH1 1JN  
01202 122 252 | [www.hiveandpartners.co.uk](http://www.hiveandpartners.co.uk)