



8 The Close, Hampton Lucy, Warwick, CV35 8AY

- Village Location
- Terraced House
- Beautifully Presented Throughout
- Living Room
- Kitchen-Diner
- Utility Space and Downstairs Cloakroom
- Three Bedrooms
- Dressing Room/Study/Nursery
- Rear Garden
- EPC Rating



£335,000

ACCOMMODATION

Door from front elevation into lobby with cloakroom fitted with wc, basin and obscure window to front. The utility room is accessed from the lobby through a sliding door and is fitted with a range of units, wall mounted boiler and space for washing machine. Door out to the rear garden. Having been renovated the kitchen-dining area is beautifully presented, with the kitchen area offering a range of wall and base units with acrylic soap stone Carrara worktop over. Inset sink and drainer with window to front aspect, half size pantry drawers and swing out units, integrated dishwasher, integrated microwave. Space for fridge freezer and oven. The dining area offers sliding doors out onto the rear garden and wall mounted radiator. Door through into the living room with window to rear, vertical wall mounted radiator and door to the hallway, additional front door and stairs leading to first floor landing with two windows to front aspect. The first floor landing has two loft hatches and door to airing. Bedroom one with window to rear, wall mounted radiator and door into an additional space which is perfect for a study, nursery or dressing room. Bedroom two has window to rear and wall mounted radiator. Bedroom three with window to the front and wall mounted radiator. The modern bathroom is fitted with a wc, vanity base unit, bath with shower attachment and rainfall shower, a range of fitted storage cupboards and a heated towel rail.

OUTSIDE

The rear garden enclosed with fencing and lovingly designed by the current vendors, with a decking area, artificial lawn, wild garden area with pond and mature borders. Shed.

To the front there is a gravelled area for off road parking, pathway leading to the accommodation and two magnolia trees.

GENERAL INFORMATION

TENURE: The property is understood to be freehold. This should be checked by your solicitor before exchange of contracts.

SERVICES: We have been advised by the vendor that mains gas, electricity, water and drainage are connected to the property. However this should be checked by your solicitor before exchange of contracts. Gas central heating to radiators.

RIGHTS OF WAY: The property is sold subject to and with the benefit of any rights of way, easements, wayleaves, covenants or restrictions etc. as may exist over same whether mentioned herein or not.

COUNCIL TAX: Council Tax is levied by the Local Authority and is understood to lie in Band C.

CURRENT ENERGY PERFORMANCE CERTIFICATE RATING: C. A full copy of the EPC is available at the office if required.

VIEWING: By Prior Appointment with the selling agent.





Ground Floor

Floor area 48.3 m² (519 sq.ft.)

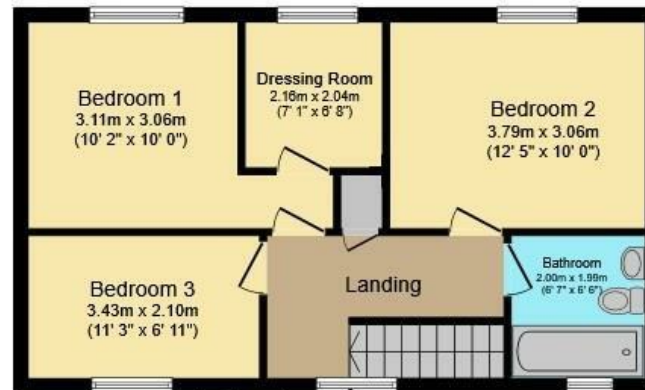

First Floor

Floor area 48.3 m² (519 sq.ft.)

TOTAL: 96.5 m² (1,039 sq.ft.)

This floor plan is for illustrative purposes only. It is not drawn to scale. Any measurements, floor areas (including any total floor area), openings and orientations are approximate. No details are guaranteed, they cannot be relied upon for any purpose and do not form any part of any agreement. No liability is taken for any error, omission or misstatement. A party must rely upon its own inspection(s). Powered by www.Propertybox.io

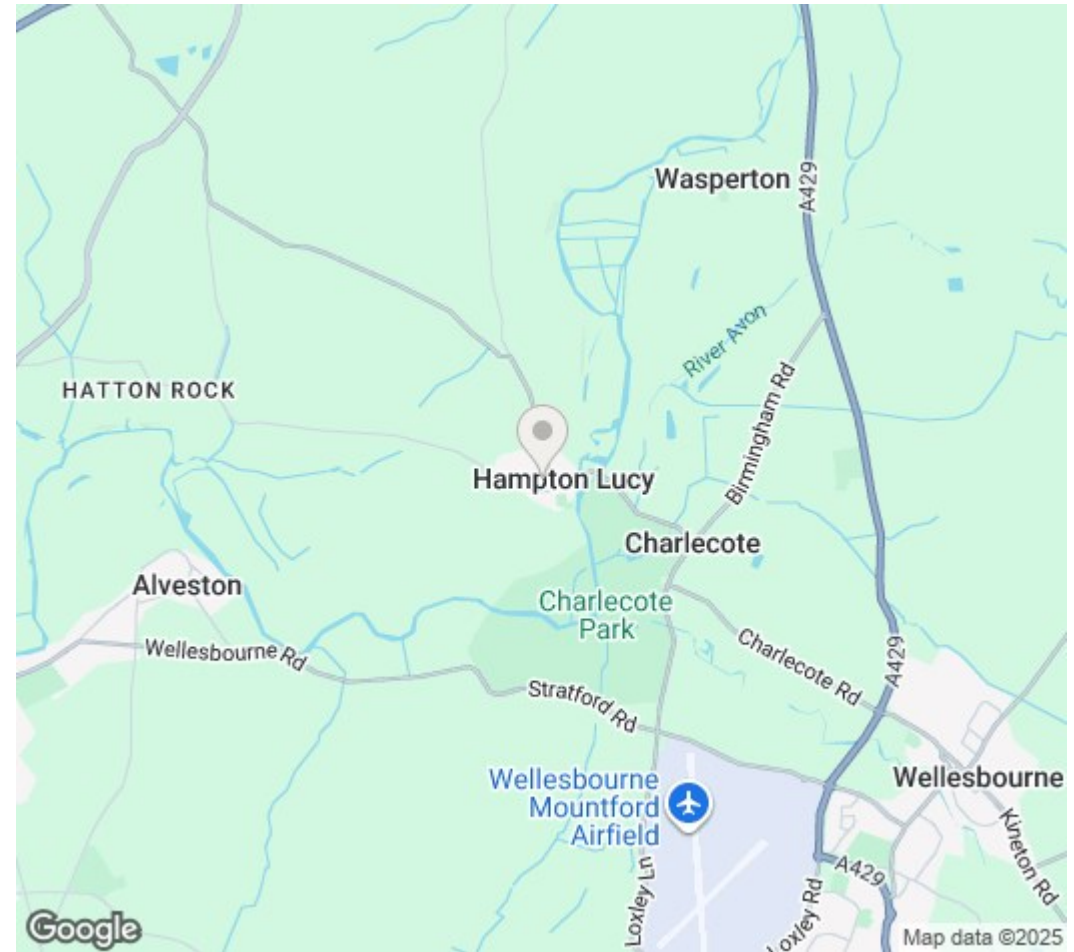

DISCLAIMER: Peter Clarke & Co LLP themselves and for the vendors or lessors of this property whose agents they are, give notice that the particulars are set out as a general outline only for the guidance of intending purchasers or lessors, and do not constitute part of an offer or contract; all descriptions, dimensions, references to condition and necessary permission for use and occupation, and other details are given without responsibility and any intending purchasers or tenants should not rely on them as statements or presentations of fact but must satisfy themselves by inspection or otherwise as to the correctness of each of them. Room sizes are given on a gross basis, excluding chimney breasts, pillars, cupboards, etc. and should not be relied upon for carpets and furnishings. We have not carried out a detailed survey and/or tested services, appliances and specific fittings. No person in the employment of Peter Clarke & Co LLP has any authority to make or give any representation of warranty whatever in relation to this property and it is suggested that prospective purchasers walk the land and boundaries of the property, prior to exchange of contracts, to satisfy themselves as to the exact area of land they are purchasing.

Multi-award winning offices
serving South Warwickshire & North Cotswolds

Warwick Road, Wellesbourne, Warwickshire, CV35 9ND
01789 841114 | wellesbourne@peterclarke.co.uk | www.peterclarke.co.uk

Peter Clarke

