



Admiralty Avenue

London, E16

Asking Price £500,000

Positioned within the sought-after Royal Wharf development, this well-presented 2 bedroom apartment offers contemporary living in a vibrant riverside setting.

CHESTERTONS



Admiralty Avenue

London, E16

- 753sq ft 2nd floor 2 bedroom apartment with balcony.
- Private Balcony
- Modern kitchen with fully integrated appliances
- Floor-to-ceiling doors leading to a private balcony
- 24-hour concierge service for residents
- Access to gym, swimming pool and spa facilities
- Short walk to Pontoon Dock DLR station



Positioned within the sought-after Royal Wharf development, this well-presented 2 bedroom apartment offers contemporary living in a vibrant riverside setting.

The property features a bright and spacious open-plan living and dining area, enhanced by stylish wooden flooring throughout. Floor-to-ceiling doors flood the space with natural light and open directly onto a private balcony, perfect for relaxing or entertaining. The modern kitchen is fully fitted with a range of sleek, integrated appliances, providing both functionality and a clean, streamlined finish.

The bedrooms are generously sized and offer a comfortable retreat, complete with soft carpeting for added warmth and comfort. The apartment is finished to a high standard throughout, making it ideal for both homeowners and investors alike.

Tenure: Leasehold 986 years approx. remaining.

Service Charge: £4,374 pa approx.

Ground Rent: £600 pa.

Local Authority: Newham

Council Tax Band: E

Score	Energy rating	Current	Potential
92+	A		
81-91	B	85 B	85 B
69-80	C		
55-68	D		
39-54	E		
21-38	F		
1-20	G		

Chestertons Canary Wharf & Greenwich Sales

Harbour Island
 28 Harbour Exchange Square
 London
 E14 9GE
 canarywharf@chestertons.co.uk
 020 7510 8300
 chestertons.co.uk

Commodore House, Admiralty Avenue, E16

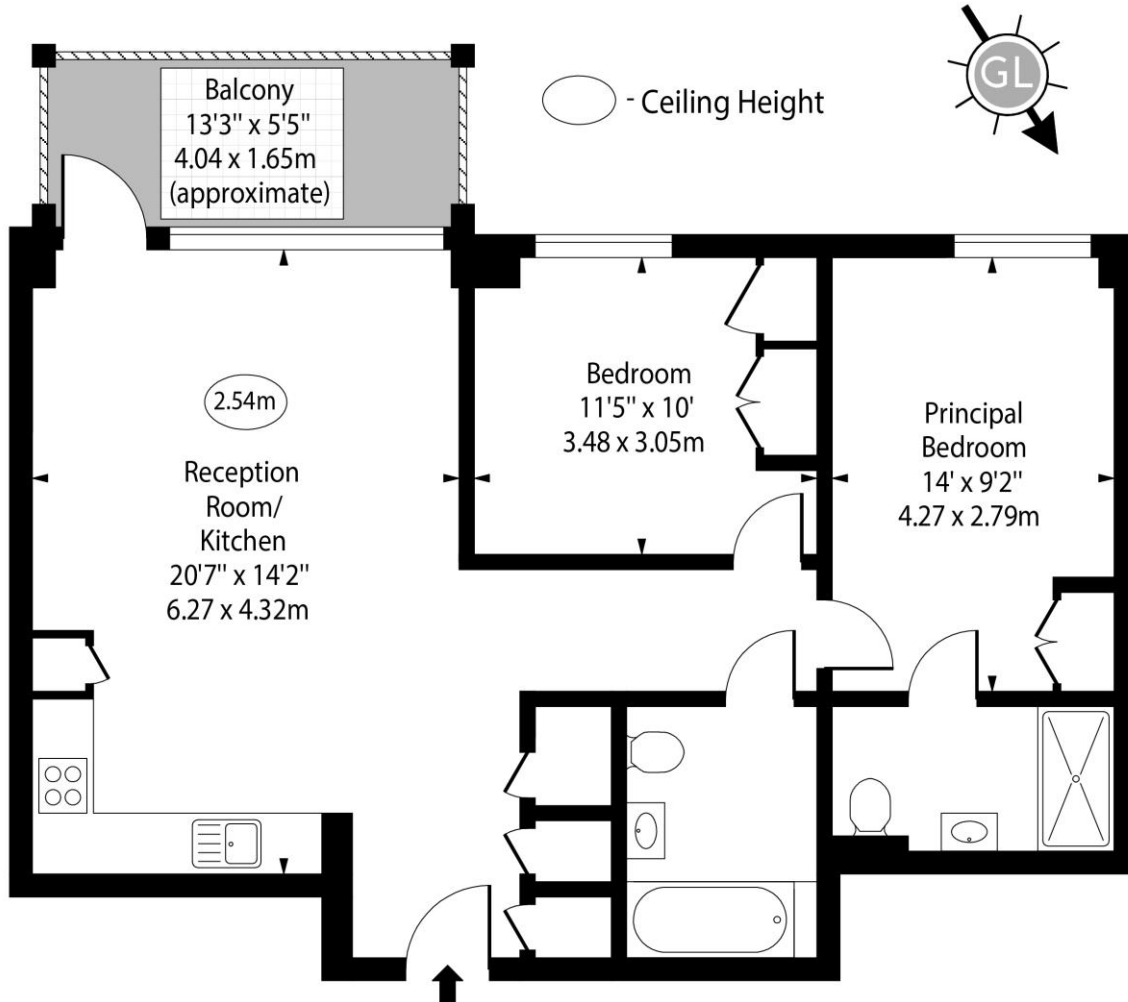

Second Floor

Approx Gross Internal Area 753 Sq Ft - 69.95 Sq M

Every attempt has been made to ensure the accuracy of the floor plan shown. However, all measurements, fixtures, fittings, and data shown are approximate interpretations and for illustrative purposes only. Measured according to the RICS. Not To Scale.

www.goldlens.co.uk

Ref. No. 031234.1K

