



- A natural stone cottage enjoying a quiet and tucked away position with views
- Entrance hallway with original balustrade staircase and understair cupboard
- Open plan lounge dining room with windows to front and rear
- Fitted kitchen with a good range of units, ground floor shower room
- Three good sized bedrooms, gas central heating and double glazing
- Gardens to front and rear, main roof recently replaced, no onward chain



"A traditional natural stone property forming part of a terrace of eight cottages which enjoys an elevated and tucked away location with views across the Somer Valley and offered for sale with no onward chain!"

The accommodation comprises entrance hallway with the original balustrade staircase and handy under stair cupboard. Open plan lounge dining room with windows to front and rear. Fitted kitchen with a range of units and door to rear. On the first floor are three good sized bedrooms all with a pleasant aspect to front and rear. The property benefits from mains gas central heating and double glazing. The main roof has been completely replaced in recent years.

Outside, to front is a shared pathway leading to the front door and gardens. To the rear there is initially a yard area with which can be enclosed if required, leading on from this is a shared pathway and gradient garden currently laid to vegetable plots.

**Tenure:** Freehold.

**Council Tax Band:** B.

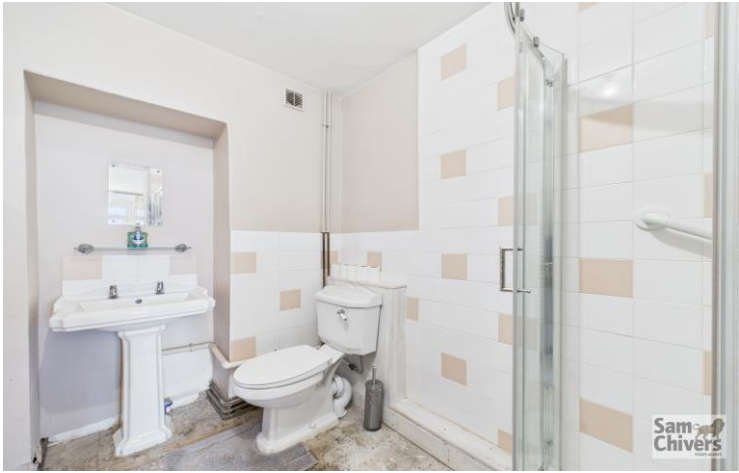

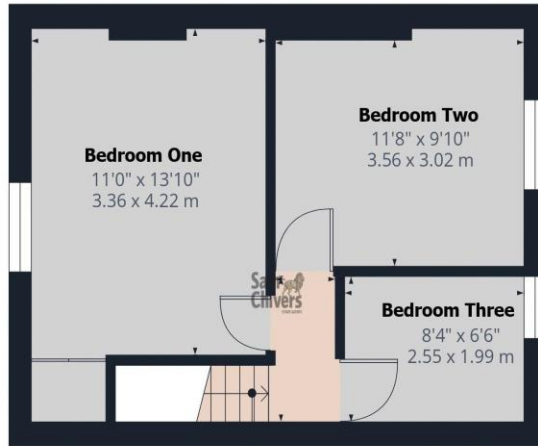

Approximate total area<sup>(1)</sup>  
830 ft<sup>2</sup>  
77 m<sup>2</sup>

(1) Excluding balconies and terraces

Calculations reference the RICS IPMS 3C standard. Measurements are approximate and not to scale. This floor plan is intended for illustration only.

GIRAFFE360



Find us online!



[www.samchiversproperty.co.uk](http://www.samchiversproperty.co.uk)



Facebook: Sam Chivers Estate Agents



Instagram: @samchiversestateagents

rightmove  Zoopla

Score	Energy rating	Current	Potential
92+	A		
81-91	B		84 B
69-80	C		
55-68	D	59 D	
39-54	E		
21-38	F		
1-20	G		

Sam Chivers Estate Agents can also provide mortgage and conveyancing recommendations should you require such a service. Please contact our office on:

01761 411020 or email us at [sales@samchiversproperty.co.uk](mailto:sales@samchiversproperty.co.uk)

These sales particulars provide an approximate guide and form no part of a contract. It is the purchaser's responsibility to satisfy themselves that the property has been accurately described and that all fixtures and apparatus are functioning correctly. Your home may be at risk if you do not keep up repayments secured against it.