

23 Robin Kerkham Way, Clenchwarton PE34 4BB

£179,995

 2  1  1



Ever wanted to put your own stamp on a property? Located in the popular village of Clenchwarton, just a short distance from King's Lynn, this spacious semi-detached home offers the ideal blank canvas. With plenty of potential and a generous layout, it's a fantastic opportunity to create a space that truly reflects your style. Bring your ideas to life and shape this house into your perfect home.

Key Features

- No onward chain
- Detached garage
- Close to local schools
- Off road parking
- Double glazed
- 2 Bedrooms
- Semi-detached house
- Village location
- Ideal first home
- Council tax band - B

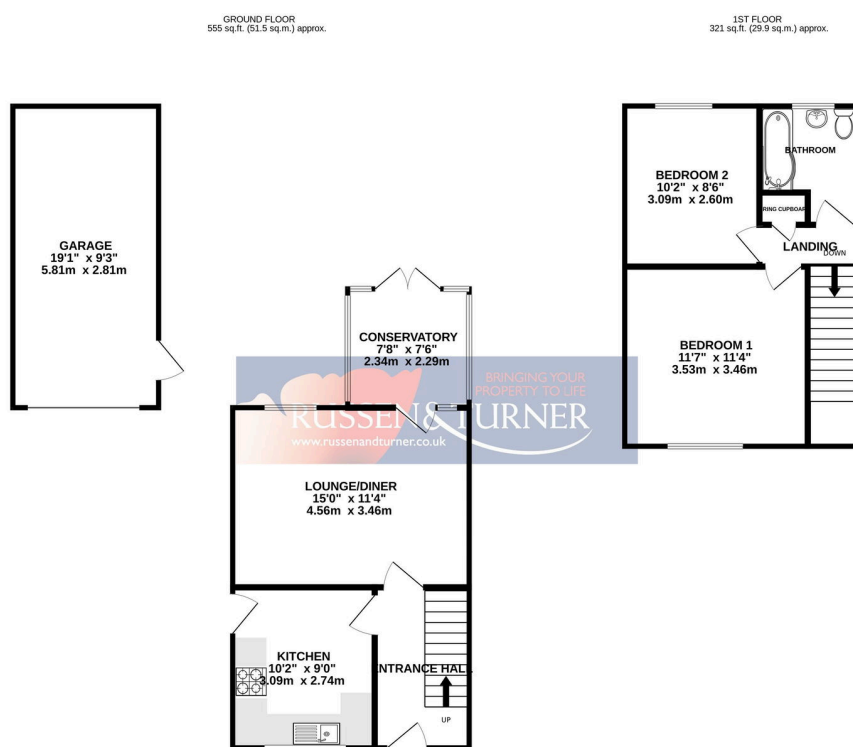

TOTAL FLOOR AREA: 876 sq.ft. (81.4 sq.m.) approx.
Whilst every attempt has been made to ensure the accuracy of the floorplan contained herein, measurements of doors, windows, rooms and any other items are approximate and no responsibility is taken for any error, omission or mis-statement. This plan is for illustrative purposes only and should be used as such by any prospective purchaser. The services, systems and appliances shown have not been tested and no guarantee as to their operability or efficiency can be given.
Made with Metropix ©2025