

## Thelton Avenue, Broadbridge Heath, Horsham, RH12 3AX

Offers Over £175,000

1 1 1



A very well-presented One Double Bedroom apartment in a Popular Village Location, featuring a bright Lounge/Diner with Juliet balcony, separate kitchen, Allocated Parking, communal gardens and a Long Lease.

Tenure: Leasehold  
Lease: 900+ Years  
Council Tax: B  
EPC: TBC

## Key Features

- Watch Our Video Tour
- Popular Village Location
- Communal Gardens
- 14'8 x 12'5 Living Room
- Ideal First Time Purchase or Investment
- One Double Bedroom
- 900+ Year Lease
- Allocated Parking
- Separate Kitchen
- Well Presented Throughout

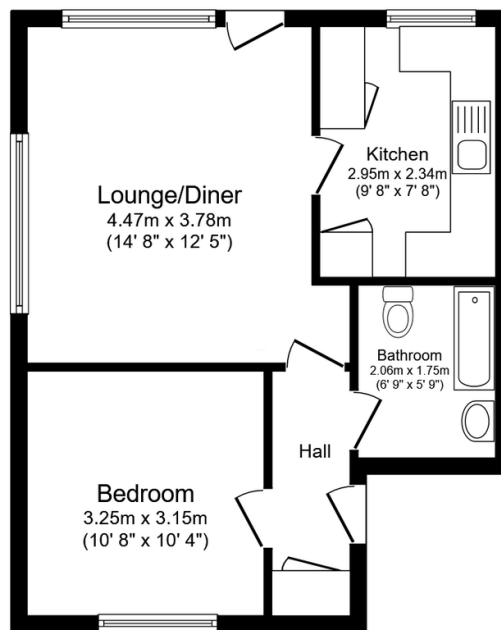

**Floor Plan**

Floor area 44.6 sq.m. (480 sq.ft.)

Total floor area: 44.6 sq.m. (480 sq.ft.)

This floor plan is for illustrative purposes only. It is not drawn to scale. Any measurements, floor areas (including any total floor area), openings and orientations are approximate. No details are guaranteed, they cannot be relied upon for any purpose and do not form any part of any agreement. No liability is taken for any error, omission or misstatement. A party must rely upon its own inspection(s). Powered by [www.Propertybox.io](http://www.Propertybox.io)