

Cotswold Court, Horsham, West Sussex, RH13 5ST

Asking Price £275,000

Council Tax Band: C



LOCATION

We are delighted to bring to the market this two bedroom, split-level maisonette in a highly convenient location within walking distance to Horsham town centre and train station. Positioned at far end of Cotswold Court, it has far reaching views across to Denne Hill and Horsham skyline and has well-maintained communal lawns out the front of the block.



Open House Horsham

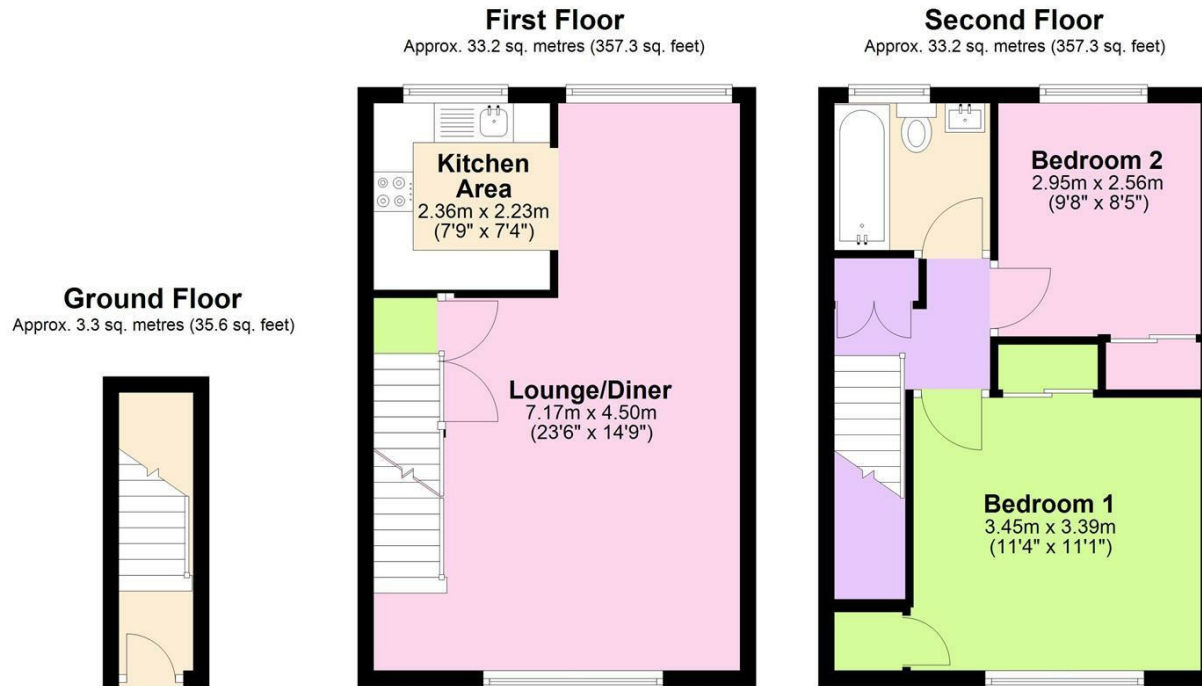

Total area: approx. 69.7 sq. metres (750.3 sq. feet)
Cotswold Ct



Energy Efficiency Rating		
	Current	Potential
Very energy efficient - lower running costs		
(92 plus) A		
(81-91) B		
(69-80) C	76	76
(55-68) D		
(39-54) E		
(21-38) F		
(1-20) G		
Not energy efficient - higher running costs		
England & Wales	EU Directive 2002/91/EC	