



**4 Trafalgar Place, Underdale, Shrewsbury, SY2 5EH**

2 bedroom apartment — £165,000 Leasehold

## 4 Trafalgar Place, Underdale, Shrewsbury, SY2 5EH

Coopergreenpooks.co.uk

£165,000 Leasehold — 2 bedroom apartment

sales@cgpooks.co.uk

Situated within a very popular residential area, this ground floor two bedroom apartment offers well-designed accommodation, benefitting from allocated parking, it's own private entrance, and a courtyard garden.

### KEY FEATURES

- Good-sized open plan kitchen/living/dining room with two windows to front
- A range of fitted units and space for appliances within the kitchen area
- Two generous bedrooms, both having built-in storage
- Separate family bathroom with shower
- Double glazed windows and electric heating
- Private south-west facing courtyard garden to front
- Allocated parking and additional visitor spaces
- Communal gardens, bike and bin storage for residents
- A fantastic location within a short walk of the town centre, train station, and beautiful riverside walks
- Sold vacant with no upward chain

Cooper Green Pooks  
3 Barker Street  
Shrewsbury  
SY1 1QF

www.cgpooks.co.uk  
sales@cgpooks.co.uk  
01743 276666



### Ground Floor

Approx. 60.5 sq. metres (651.6 sq. feet)

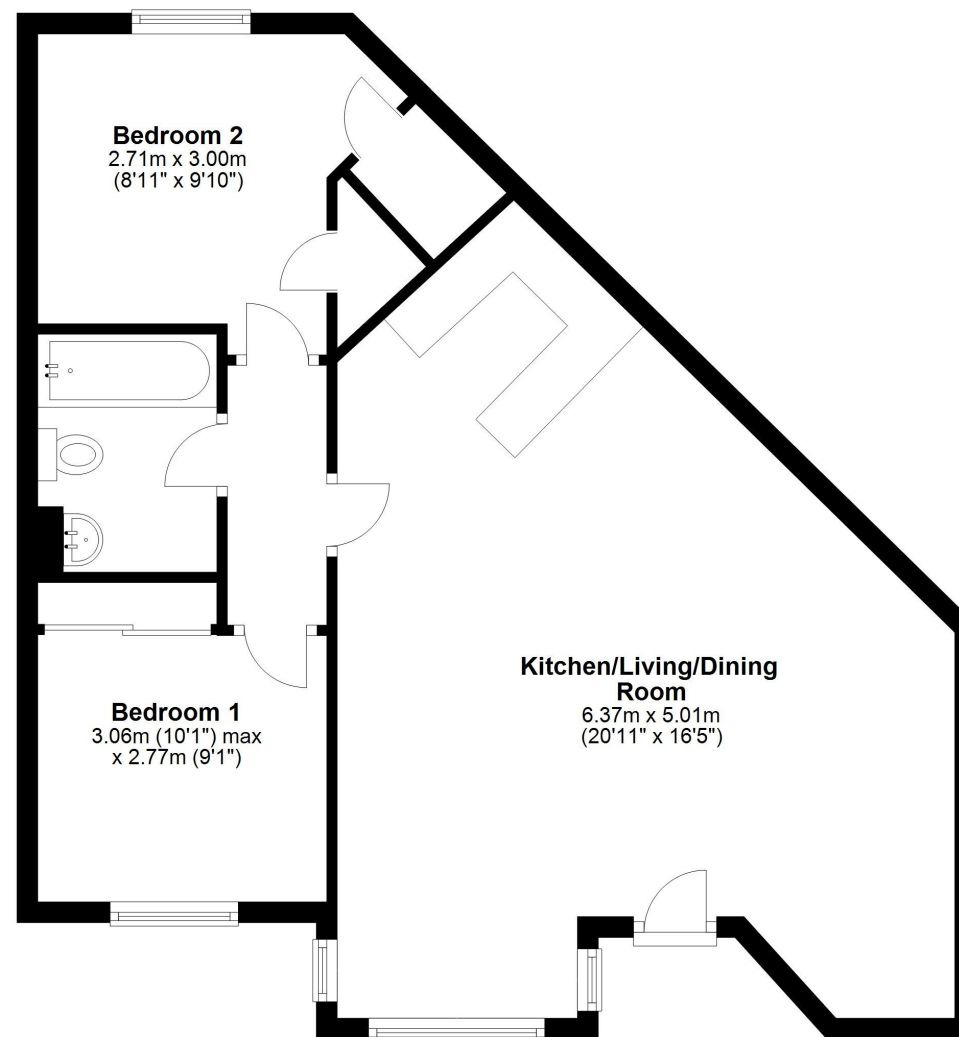

Total area: approx. 60.5 sq. metres (651.6 sq. feet)







# 4 Trafalgar Place, Underdale, Shrewsbury, SY2 5EH

£165,000 Leasehold — 2 bedroom apartment

sales@cgpooks.co.uk

rightmove

onTheMarket.com

RICS  
Regulated by RICS

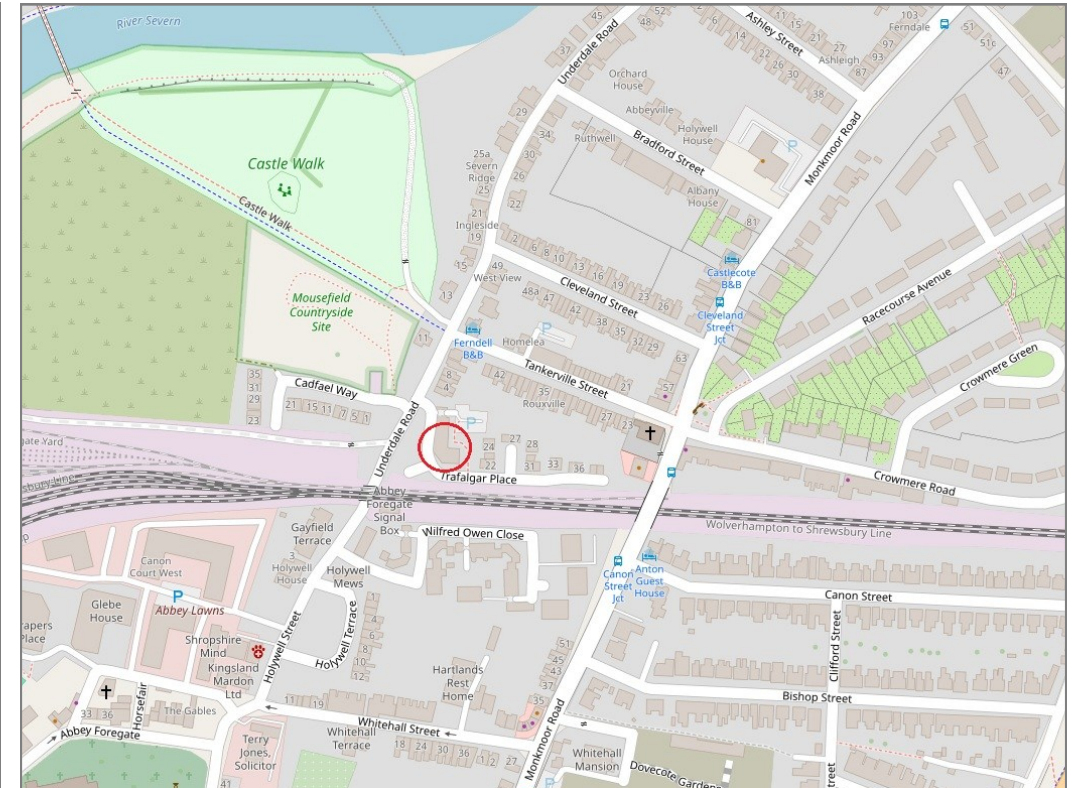

**BOUNDARIES NOT CONFIRMED**

Local Authority	<b>Shropshire Council</b>
Council Tax	<b>Band B</b>
EPC Band	<b>Band D</b>
Services	<b>Mains water, electricity and drainage are connected. Electric heating.</b>

Tenure	<b>Leasehold</b>
Lease Length	<b>199 years from July 1997</b>
Service Charge	<b>£134 pcm (£1,608 per annum)</b>
Ground Rent	<b>£25 per annum</b>

# 4 Trafalgar Place, Underdale, Shrewsbury, SY2 5EH

Coopergreenpooks.co.uk

£165,000 Leasehold — 2 bedroom apartment

sales@cgpooks.co.uk

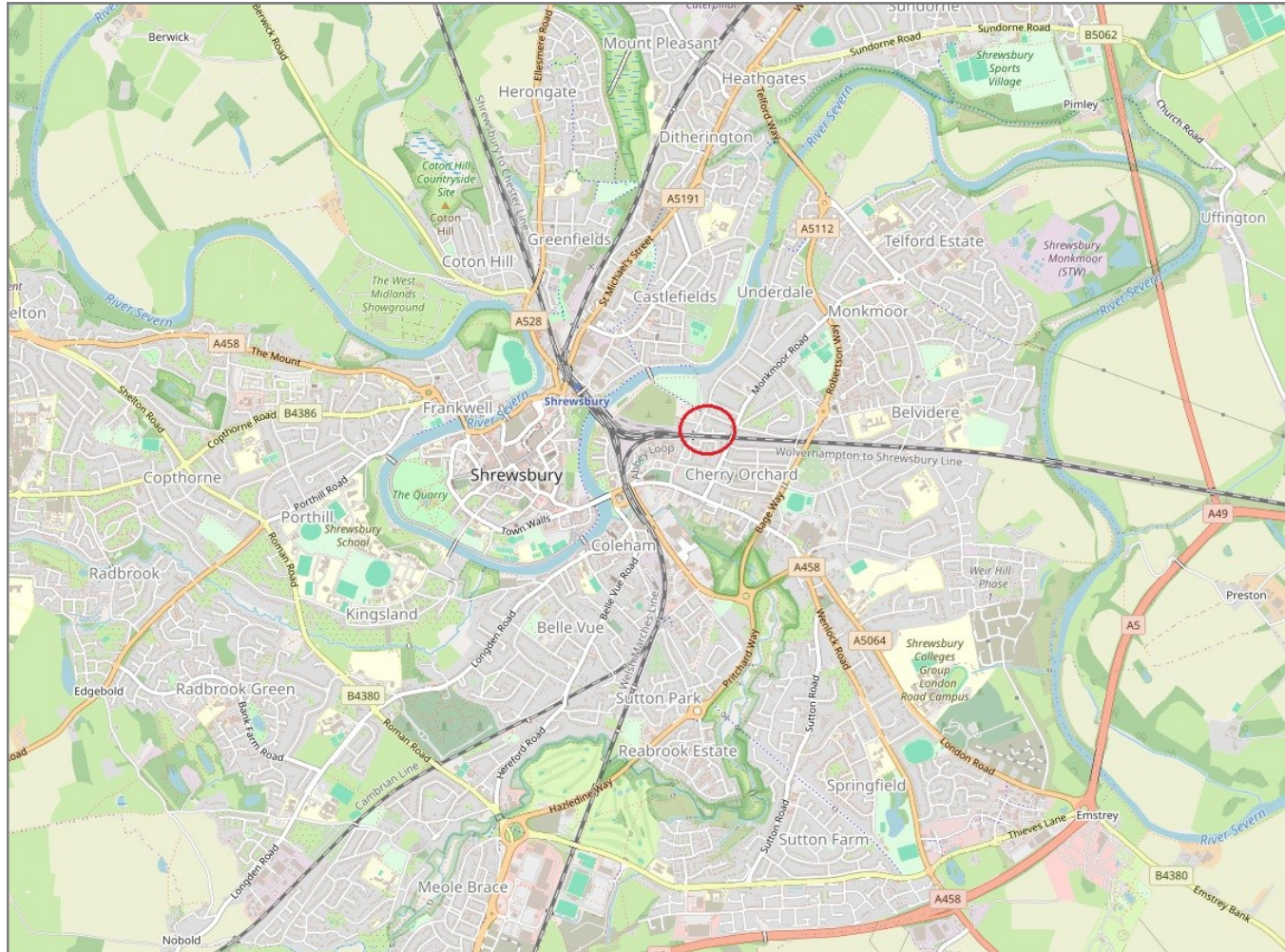

**IMPORTANT NOTICE:** Cooper Green Pooks for themselves and for the lessors or vendors of this property whose agents they are give notice that: 1 No appliances, services or service installations have been tested and no warranty as to suitability or serviceability is implied. Any prospective purchaser or lessee is advised to obtain verification from their surveyor or solicitor. 2. The particulars are set out as a general outline only for the guidance of the intended purchasers or lessees and do not constitute, nor constitute part of, an offer or contract. 3. All descriptions, reference to condition and necessary permissions for use and occupation and other details are given in good faith and are believed to be correct but any intending purchasers or lessees should not rely on them as statements or representation of fact but satisfy themselves by inspection or otherwise as to the correctness of each of them. 4. No person in the employment of Cooper Green Pooks has any authority to make or give any representation or warranty whatsoever in relation to this property. 5. All rentals and prices are quoted exclusive of Stamp Duty, legal and surveyors fees and any other associated purchasers or lessees costs. 6. Floor plans are indicative only and should not be relied on. 7. The plan showing the boundary of the property is indicative only and has not been checked against the legal title so should not be relied on. 8. All dimensions, floor areas and site areas are only approximate and should not be relied on. Dimensions are generally maximum room dimension.