



Gretton Street, Barleythorpe, Oakham

Bedrooms: 4 | Bathrooms: 2 | Receptions: 3

Located in a sought-after development, this detached family home offers well-presented accommodation, including a large rear extension

- Detached Family Home Situated In A Prime Location
- Enclosed Rear Garden
- Walking Distance To Amenities
- Four Comfortable Bedrooms
- Off Road Parking & Garage
- NO ONWARD CHAIN



Property Type: Detached House

Bedrooms: 4 | **Bathrooms:** 2 | **Receptions:** 3

Upon entering, you are welcomed by a spacious hallway with a doorway to the left leading to a snug/fifth bedroom and a doorway to the right opening into the modern open-plan breakfast kitchen with integrated appliances. A separate utility room with a downstairs cloakroom and back door provides access to the rear garden. To the rear of the property, a door from the hallway leads into the bright, open-plan dining and family room, featuring bi-fold doors onto the garden.

Stairs rise to the first floor, where the landing gives access to the master bedroom with ensuite shower room and fitted wardrobes, a second double bedroom, two smaller bedrooms, and the main family bathroom.

Outside, the property benefits from a garage and off-street parking. A side gate leads to the good-sized rear garden, which includes a decking area and a lawn. Conveniently situated close to amenities and schools, and within walking distance of the popular market town of Oakham.

Barleythorpe is a popular residential area on the outskirts of Oakham, offering a blend of modern homes and village charm. It benefits from easy access to Oakham's town centre, local schools, and amenities, while also being close to open countryside and Rutland Water. The area is ideal for families and commuters alike, with excellent transport links, including the nearby Oakham railway station providing services to Leicester and Peterborough.

To book a viewing call our area experts

www.mooresestateagents.com

Office@mooresestateagents.com

Moore's property hub 01572 757979 | Moore's Move to the Country
020 301 11361 | Melton 01664 491610 | Uppingham 01572 821935 |
Stamford 01780 484555 | Grantham Meet & Greet 01476 855618 |
Peterborough Meet & Greet 01733 788888 | A1 Meet and Greet Rochford



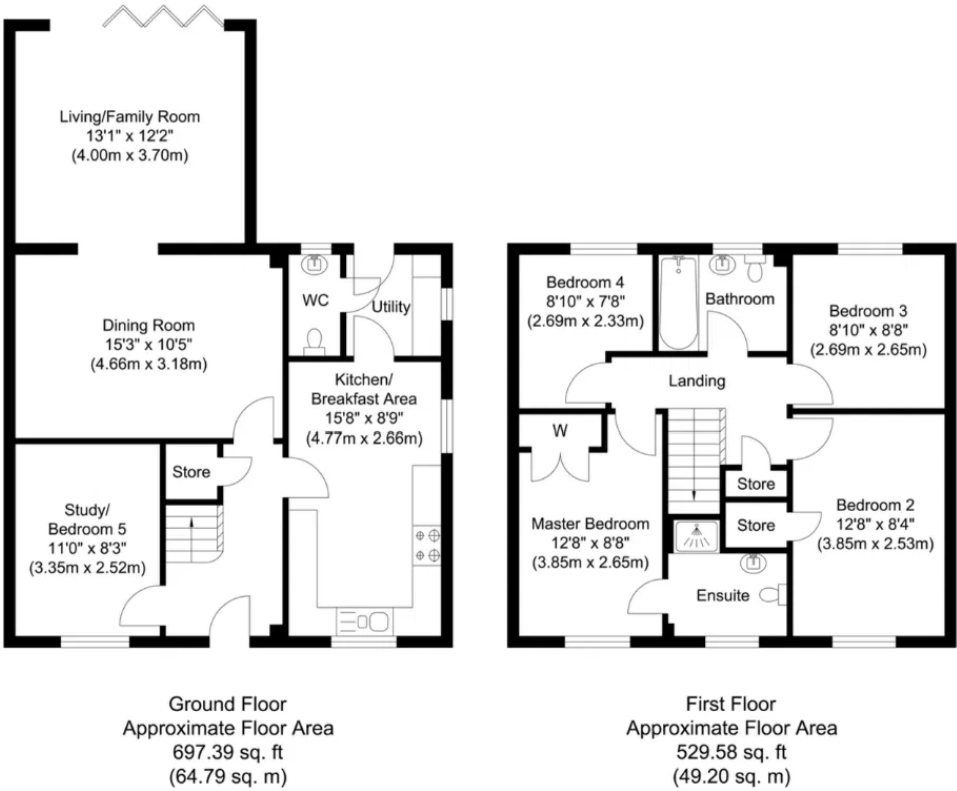

Illustration for identification purposes only, measurements are approximate, not to scale.

To book a viewing call our area experts:

Moores Property Hub	01572 757979
Moores Move to the Country	02030 111361
Melton	01664 491610
Uppingham	01572 821935
Stamford	01780 484555
Grantham Meet & Greet	01476 855618
Peterborough Meet & Greet	01733 788888
A1 Meet & Greet Stoke Rochford	

Score	Energy rating	Current	Potential
92+	A		
81-91	B	87 B	88 B
69-80	C		
55-68	D		
39-54	E		
21-38	F		
1-20	G		

Moore V Ltd trading as Moores Estate Agents gives notice that: 1. These particulars do not constitute an offer or contract or part thereof. 2. All descriptions, photographs and plans are for guidance only and should not be relied upon as statements or representations of fact. All measurements are approximate and not necessarily to scale. Any prospective purchaser must satisfy themselves of the correctness of the information within the particulars by inspection or otherwise, 3. Moore V Ltd trading as Moores Estate Agents does not have any authority to give any representations or warranties whatsoever in relation to this property including but not limited to planning/building regulations), nor can it enter into any contract on behalf of the Vendor. 4. Moore V Ltd trading as Moores Estate Agents does not accept responsibility for any expenses incurred by prospective purchasers in inspecting properties which have been sold, let or withdrawn. 5. If there is anything of particular importance to you, please contact this office and we will try to have the information checked for you.