

ALLDAY  
& MILLER



Stickleton Close, Greenford, UB6 9RQ  
£340,000







Stickleton Close, Greenford, UB6 9RQ

**£340,000**

- Ground Floor Maisonette
- Garage
- One Family Bathroom & W/C
- Peppercorn Ground Rent
- Good Condition Throughout
- Private Rear & Front Garden
- Two Double Bedrooms
- 136 Years Lease Remaining
- No Service Charges
- Off-Street Parking Available



## Description

The accommodation comprises a bright and welcoming reception room, a fitted kitchen with direct access to the rear garden, two well-proportioned bedrooms, a bathroom, and the added convenience of a separate WC. The property is generally well presented throughout and offers a comfortable and practical layout.

To the rear, the property benefits from a private garden, providing an excellent outdoor space for relaxing, entertaining, or enjoying outdoor dining.

## Situation

Nestled in the heart of Greenford, Stickleton Close offers a peaceful and welcoming residential setting while remaining exceptionally well-connected for commuting and everyday living. Families will benefit from a range of highly regarded schools nearby, including Ravenor Primary, Stanhope Primary, Edward Betham C of E Primary, and secondary options such as Greenford High School, William Perkin C of E High School and Dormers Wells High School. Transport links are excellent, with Greenford station providing access to the Central Line into Central London in around 30 minutes, nearby National Rail services, frequent local buses, and easy access to the A40 Western Avenue, the M25, and Heathrow Airport by car. Local amenities are plentiful, with Greenford Broadway offering shops, cafes, supermarkets, and eateries, while scenic green spaces such as Ravenor Park, the Grand Union Canal towpaths, Horsenden Hill, and Northala Fields provide plenty of outdoor recreation.



Floor Plans

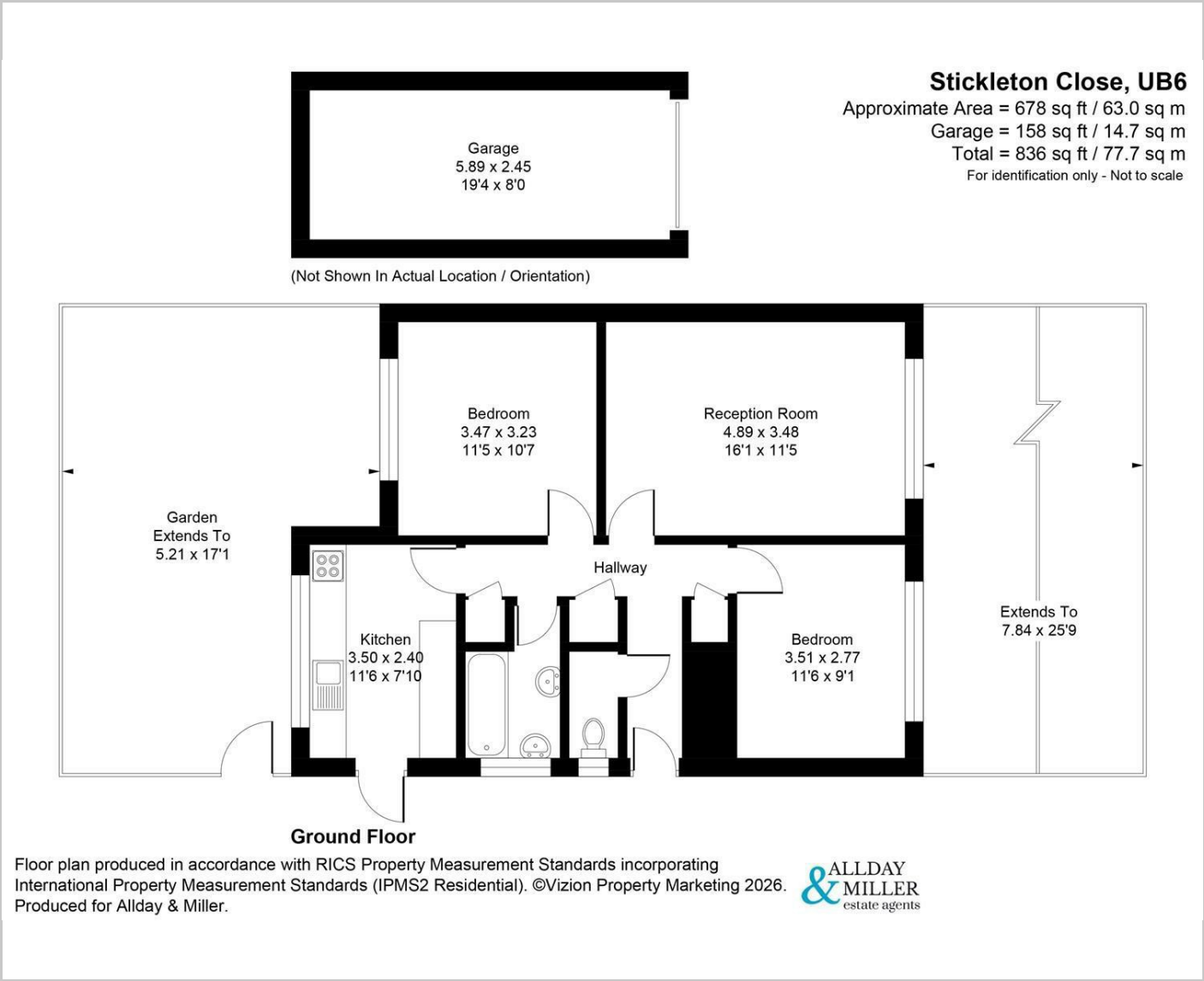

Area Map

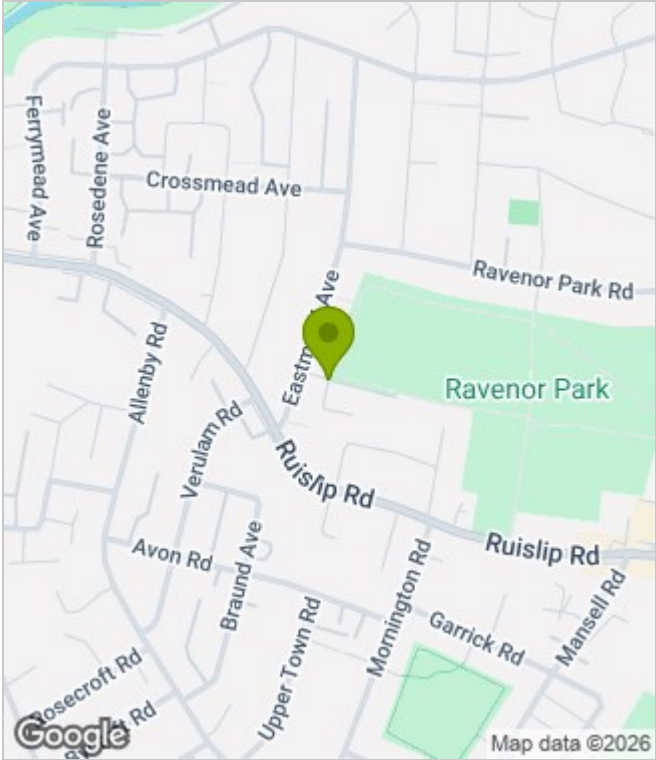

Energy Performance Graph

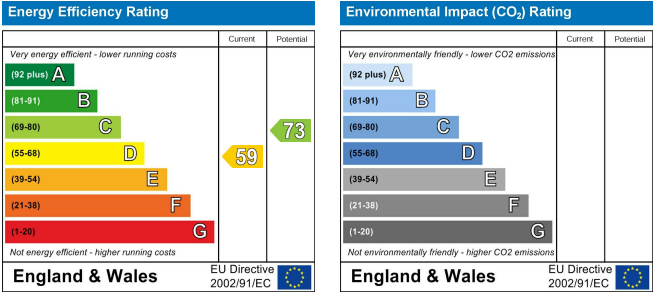

These particulars, whilst believed to be accurate are set out as a general outline only for guidance and do not constitute any part of an offer or contract. Intending purchasers should not rely on them as statements of representation of fact, but must satisfy themselves by inspection or otherwise as to their accuracy. No person in this firms employment has the authority to make or give any representation or warranty in respect of the property.