



alan
hawkins

Lillybrook Estate, Lyneham, SN15 4AA

01793 840 222 | alanhawkins.co.uk

alan
hawkins
PROPERTY SALES & LETTINGS



alan
haw
PROPERTY SA

- 2 Bedroom Park Home
- 36' x 20'
- Oil Fired Central Heating
- Very Well maintained
- Over 50's Only

- 1984 Omar Ashdale
- Garage & Driveway
- Combination Boiler
- No Onward Chain



alan
hawkins



alan
hawkins



alan
hawkins

32 Lillybrook Estate Lyneham, SN15 4AA

£135,000

A very well presented two double bedroom park home with garage situated on this much favoured family run site of Lillybrook, positioned on the fringes of the neighbouring villages of Lyneham and Bradenstoke.

Originally constructed in 1984, this well maintained and updated home, which measures 36 x 20 comprises an entrance/side porch, modern kitchen,

dining area and 19'10 living room, inner hallway, modern bathroom and two double bedrooms with built-in wardrobes.

Externally the property boasts surrounding gardens with a rear patio and a garage situated next to the home. Further benefits include oil fired central heating via a combination boiler and uPVC double glazing. Offered chain free, an early viewing is recommended.



Viewings

By appointment through Alan Hawkins Property Sales. Tel: 01793 840 222

Council Tax: Wiltshire Council

Tax Band A For year 2025/26 = £1,535.90
For information on tax banding and rates, please call Wiltshire Council

Tenure: Mobile homes Act 1983:
Ground Rent: £189.58 pcm (inc Garage) 2026

Heating - Oil
Electric - Mains
Water - Mains
Drainage - Mains
Internet - Up to 76 Mbps available download speed



GROUND FLOOR

698 sq.ft. (64.8 sq.m.) approx.

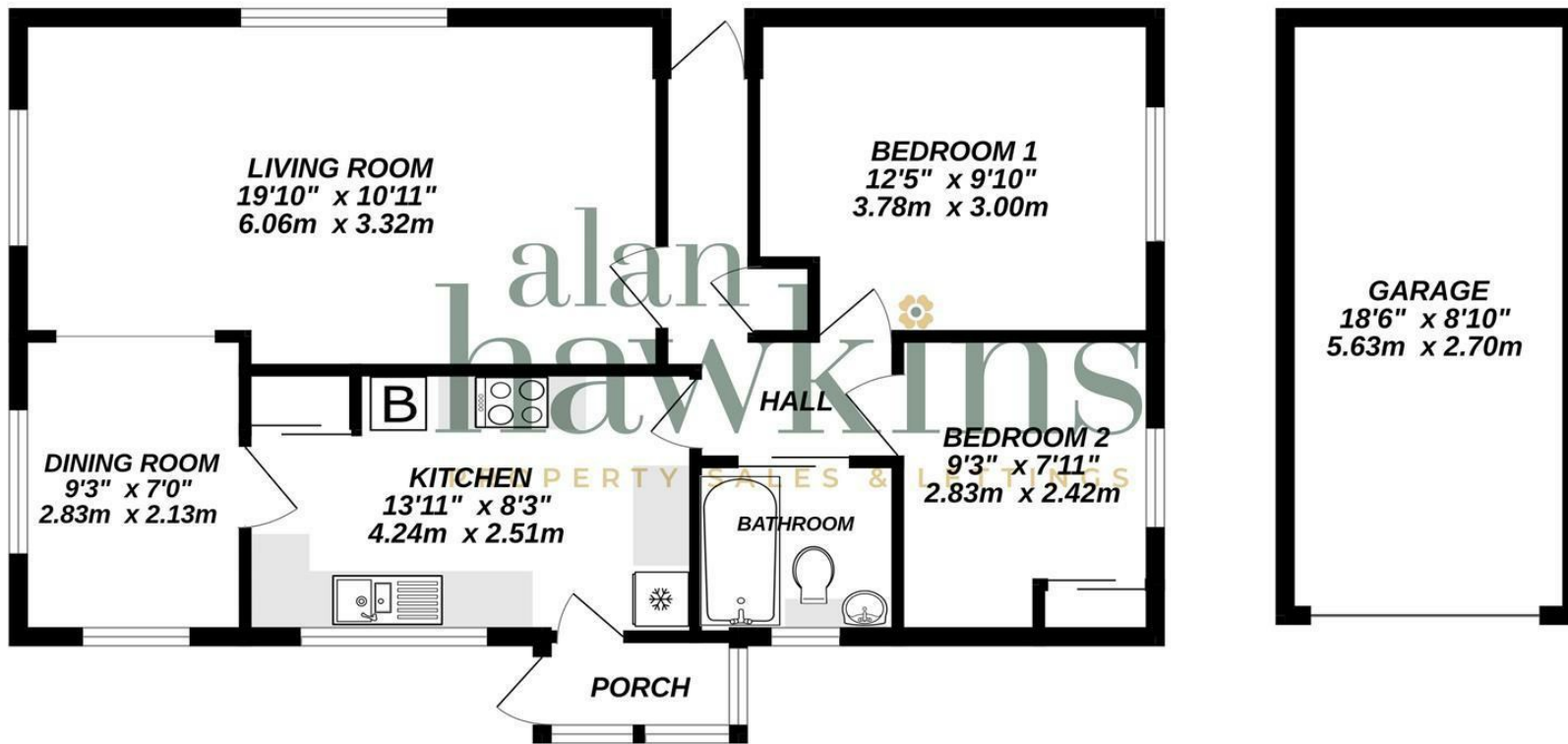

TOTAL FLOOR AREA : 698sq.ft. (64.8 sq.m.) approx.

Whilst every attempt has been made to ensure the accuracy of the floorplan contained here, measurements of doors, windows, rooms and any other items are approximate and no responsibility is taken for any error, omission or mis-statement. This plan is for illustrative purposes only and should be used as such by any prospective purchaser. The services, systems and appliances shown have not been tested and no guarantee as to their operability or efficiency can be given.
Made with Metropix ©2023