



Festubert Place, London, E3

BUTLER & STAG



**Guide Price £350,000 - £375,000**  
**Situated on the top floor and being in a corner position, this dual aspect apartment enjoys far reaching views towards Canary Wharf and the ever changing London city skyline. The floor to ceiling windows allow a wealth of natural light in to the apartment and the south-west facing, 180 degree roof terrace allows you to fully appreciate the sense of serene living.**



## Leasehold

- Top Floor
- Skyline City Views
- Close to Mile End & Bow Road Tube Station
- South / West Facing 180 Degree Roof Terrace
- Duel Aspect One Bedroom Apartment
- Resident Only Roof Top Gardens/Terrace

This property is composed of a large open plan kitchen and living area with sliding doors expanding out to the wraparound private terrace, a double-sized bedroom with fitted wardrobes and a sleek modern bathroom complete with a large storage cupboard. The development also enjoys two communal rooftop gardens which all residents can look to enjoy.

There are several transport links nearby with Bow Church DLR, Bow Road underground (District and Hammersmith & City) and Mile End underground (Central, District and Hammersmith & City) all easily accessible.





## Festubert Place

Approx. Gross Internal 45.5 Area Sq M ( 489.9 Sq Ft )

**BUTLER & STAG**

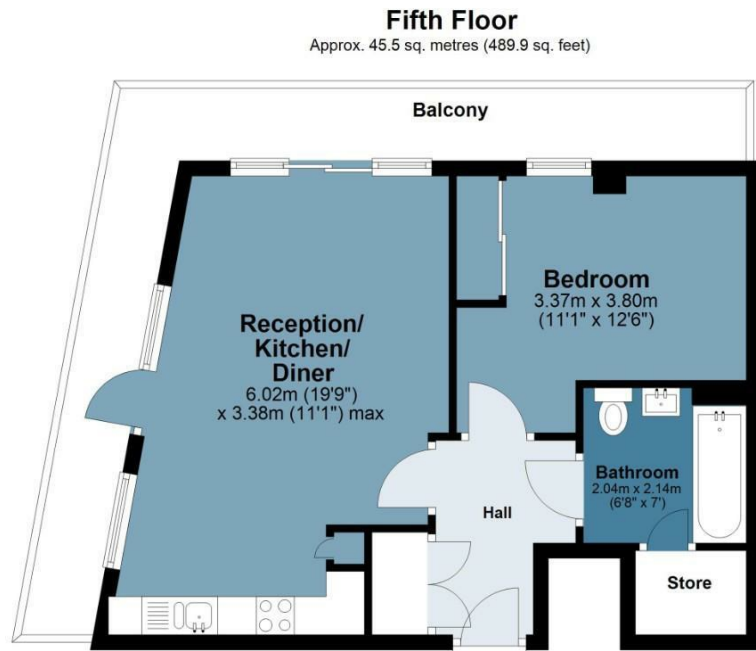

Measurements are approximate and for illustration purposes only. While we do not doubt the accuracy and completeness, we advise you conduct a careful independent assessment of the property to determine monetary value.  
© @modephotouk www.modephoto.co.uk

**BUTLER & STAG**

☎ 020 8102 1236

🏠 508 Roman Road, Bow, London, E3 5LU

✉ bow@butlerandstag.com

[www.butlerandstag.uk](http://www.butlerandstag.uk)

IMPORTANT NOTICE - These particulars have been prepared in good faith and they are not intended to constitute part of an offer or contract. We have not performed a structural survey on this property and the services, appliances and specific fittings have not been tested. All photographs, measurements, floor plans and distances referred to are given as a guide and should not be relied upon.