



The Park, Cheltenham, GL50 2SG

£270,000

🛏️ 2 🪑 1 🚗 1



Set within a stunning period building in the prestigious area of The Park, Cheltenham, this beautifully presented two-bedroom apartment offers approximately 820 sqft of light-filled and well-proportioned living space which also benefits from allocated off road parking,

The accommodation is thoughtfully laid out, beginning with an inviting entrance hall featuring hardwood flooring – a versatile space that can also be used as a dining area. The spacious living room (15'7 x 13'3) is double-fronted, allowing for an abundance of natural light and offering an elegant setting for both relaxing and entertaining.

The modern kitchen is positioned at the rear of the property and is fitted with some integrated appliances and ample storage, making it as practical as it is stylish.

The main bedroom is generously sized, complete with ample space for storage and a private en suite shower room. The second bedroom is also a comfortable double, enjoying peaceful views over the communal gardens. A well-appointed main bathroom, featuring a shower over the bath, wash basin, and WC, completes the accommodation.

This apartment blends period charm with modern convenience in one of Cheltenham's most desirable locations – ideal for professionals, downsizers, or anyone seeking refined living within easy reach of the town centre.

Council Tax: B

Share of Freehold

Lease: 989 Years Remaining

Annual Service Charge: £2192



Approximate Gross Internal Area 821 sq ft - 76 sq m

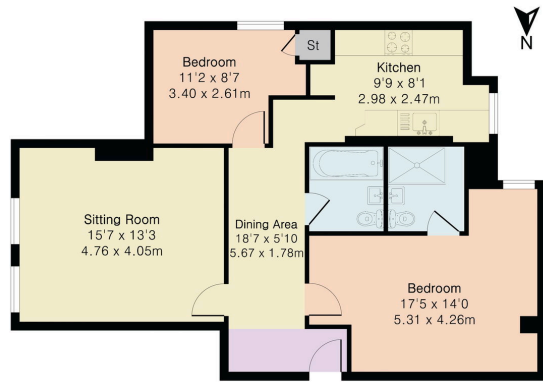

- Allocated Off Road Parking
- Gas Central Heating
- Beautifully Presented
- Share Of Freehold
- En Suite Shower Room
- Period Building
- Desirable Location
- Two Double Bedrooms

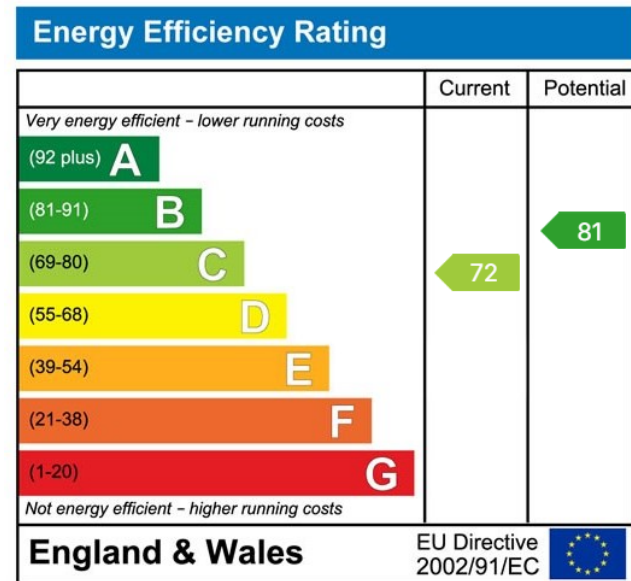

Elliot Oliver Sales
 101 Promenade, Cheltenham GL50 1NW
 01242 321091
 www.eosales.co.uk

