



Little Orchard Hargon Lane, Winthorpe Newark NG24 2NP

welcome to

Little Orchard Hargon Lane, Winthorpe Newark

* A GENEROUSLY SIZED DETACHED BUNGALOW WITH LOFT CONVERSION POTENTIAL! * This stunning detached bungalow is ideally located in the sought after village of Winthorpe with great access to the A1 and A46. Viewing recommended.



Entrance Hall

A substantial hallway from a obscured part glazed uPVC front door with cloaks cupboard, radiator and access into the dining room, living room, family bathroom and all three bedrooms.

Kitchen/Diner

20' 4" x 11' 9" (6.20m x 3.58m)

A range of WREN cream high gloss low and eye level units with part tiled walls, sink and drainer with waste disposal unit, gas hob, extractor, electric double oven, space for fridge/freezer and integrated dishwasher. In addition, there is a double glazed window to the rear and both sides, tiled flooring and uPVC door to the car port.

Dining Room

11' 9" x 13' 5" (3.58m x 4.09m)

Accessed from both the entrance hall and kitchen/diner with double glazed window to the side, carpeted flooring, storage cupboard and radiator.

Living Room

11' 9" x 15' 9" (3.58m x 4.80m)

A bright and spacious second living room leading off the dining room with double glazed window to the side, radiator, carpeted flooring, uPVC sliding patio doors to the rear and uPVC sliding patio doors to the side.

2nd Living Room

14' 8" x 11' 9" (4.47m x 3.58m)

A separate living room leading off the entrance hall with electric fire, radiator, carpeted flooring and double glazed bay window to the rear.

Family Bathroom

A four piece family bathroom with WC, vanity unit with wash hand basin and toilet, corner bath, extractor, heated towel rail and shower cubicle with mermaid board. In addition, the bathroom benefits from fully tiled walls and floor and two obscured double glazed windows to the front.

Bedroom Two

11' 8" MAX x 10' 6" MAX (3.56m MAX x 3.20m MAX)

A fantastic DOUBLE bedroom with double glazed window to the rear, radiator and carpeted flooring.

Bedroom Three

9' 9" x 6' 2" (2.97m x 1.88m)

A good size third bedroom with built in storage cupboard, double glazed window to the front, radiator and carpeted flooring.

Bedroom One

15' 8" MAX x 10' 9" MAX (4.78m MAX x 3.28m MAX)

A generously sized master bedroom with built in wardrobes, radiator, loft hatch access, carpeted flooring and uPVC sliding patio doors direct into the conservatory.

En-Suite

A modern fitted en-suite with vanity unit with WC and wash hand basin, double shower cubicle with mermaid board, heated towel rail and extractor. Additionally, the en-suite offers fully tiled walls and floor and an obscured double glazed window to the front.

Conservatory

Fully glazed conservatory leading off the master bedroom with double glazed door leading out to the garden and solid wood flooring.

Outside

Front Garden

The front of the property offers a sizeable block paved driveway offering off road parking and car port at the side of the bungalow with door leading directly into the kitchen/diner. In addition there are a number of well maintained flower beds with mature plants and shrubs. There is also access to the rear garden via a gate to the side of the bungalow.

Rear Garden

A generous rear enclosed garden with mainly laid to lawn, fish pond, paved patio area ideal for entertaining and a range of shrubs, plants and trees. The garden is not overlooked and is very private. The two timber sheds are included within the sale.

Car Port

Car port at the side of the property with block paving and uPVC door leading into the kitchen/diner.

Agent Note

The loft space spans the length of the property offering huge potential to convert into a range of different rooms making it ideal for large family (subject to relevant planning permissions). In addition, there is a small window to one elevation and access from the master bedroom.



view this property online williamhbrown.co.uk/Property/NWK104994





Ground Floor

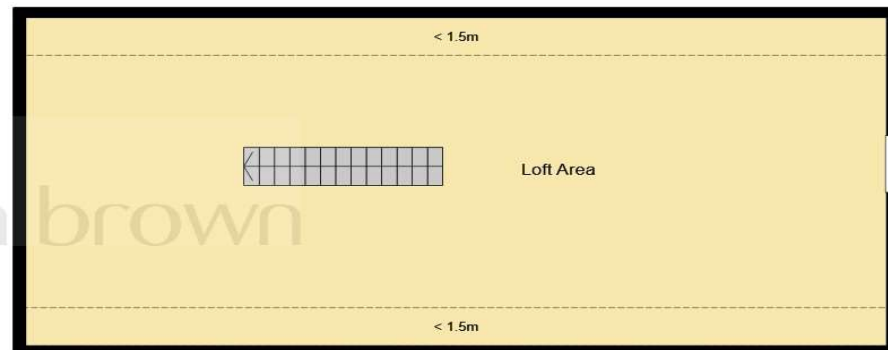

First Floor

This floor plan is for illustrative purposes only. It is not drawn to scale. Any measurements, floor areas (including any total floor area), openings and orientation are approximate. No details are guaranteed, they cannot be relied upon for any purpose and they do not form part of any agreement. No liability is taken for any error, omission or misstatement. A party must rely upon its own inspection(s). Powered by www.focalagent.com

welcome to

Little Orchard Hargon Lane, Winthorpe Newark

- SIZEABLE DETACHED BUNGALOW
- THREE BEDROOMS
- MODERN FITTED KITCHEN/DINER
- THREE RECEPTION ROOMS
- CONSERVATORY

Tenure: Freehold EPC Rating: D

Council Tax Band: E

offers in the region of

£425,000



Please note the marker reflects the
postcode not the actual property

view this property online williamhbrown.co.uk/Property/NWK104994



Property Ref:
NWK104994 - 0008

1. MONEY LAUNDERING REGULATIONS Intending purchasers will be asked to produce identification documentation at a later stage and we would ask for your co-operation in order that there is no delay in agreeing the sale. 2. These particulars do not constitute part or all of an offer or contract. 3. The measurements indicated are supplied for guidance only and as such must be considered incorrect. Potential buyers are advised to recheck measurements before committing to any expense. 4. We have not tested any apparatus, equipment, fixtures or services and it is in the buyers interest to check the working condition of any appliances. 5. Where an EPC, or a Home Report (Scotland only) is held for this property, it is available for inspection at the branch by appointment. If you require a printed version of a Home Report, you will need to pay a reasonable production charge reflecting printing and other costs. 6. We are not able to offer an opinion either written or verbal on the content of these reports and this must be obtained from your legal representative. 7. Whilst we take care in preparing these reports, a buyer should ensure that his/her legal representative confirms as soon as possible all matters relating to title including the extent and boundaries of the property and other important matters before exchange of contracts.

William H Brown is a trading name of Sequence (UK) Limited which is registered in England and Wales under company number 4268443, Registered Office is Cumbria House, 16-20 Hockliffe Street, Leighton Buzzard, Bedfordshire, LU7 1GN. VAT Registration Number is 500 2481 05.

william h brown



01636 640473



newark@williamhbrown.co.uk



47-48 Market Place, NEWARK,
Nottinghamshire, NG24 1EG



williamhbrown.co.uk