



29 Wood End Way, Chandler's Ford, SO53 4LN

£2,500 Per Month

Located in a quiet cul-de-sac on Wood End Way in Knightwood Park, this immaculate four-bedroom family home offers three spacious reception rooms, kitchen/breakfast room together with a utility and cloakroom. There are four bedrooms, three of them featuring built-in wardrobes and an en-suite to the master bedroom. A well-appointed family bathroom serves the remaining bedrooms. Additionally, a useful loft room adds versatility, perfect for a number of uses. The exterior of the property boasts a double-width driveway leading to a double garage.

ACCOMMODATION

Ground Floor

Reception hall:

Stairs to first floor.

Cloakroom:

Wash basin, WC

Sitting room:

17'10" x 11'1" (5.43m x 3.39m) Bay window.

Dining room:

11'1" x 9'0" (3.38m x 2.75m) Patio doors to conservatory.

Conservatory:

6'10" x 6'10" (2.08m x 2.08m) Double doors to outside.

Study:

10'0" x 9'11" (3.05m x 3.02m)

Kitchen/breakfast room:

15'3" x 11'9" (4.66m x 3.59m) Fitted with a comprehensive range of units, electric oven, gas hob with extractor hood over, integrated dishwasher, American style fridge freezer, understairs cupboard, space for table and chairs.

Utility room:

6'0" x 5'9" (1.84m x 1.76m) Space and plumbing for appliances, boiler, sink unit, door to outside.

First Floor

Landing:

Bedroom 1:

12'10" x 11'6" (3.90m x 3.50m) Built in wardrobe.

En-suite:

Suite comprising shower cubicle, wash basin, WC.

Bedroom 2:

11'11" x 8'11" (3.63m x 2.72m) Built in wardrobe.

Bedroom 3:

9'5" x 8'11" (2.88m x 2.72m) Built in wardrobe.

Bedroom 4:

8'11" x 8'6" (2.71m x 2.60m)

Bathroom:

Suite comprising bath with mixer tap, separate shower unit over, wash basin, WC.

Loft room:

16'4" x 16'1" (4.98m x 4.89m) Built in wardrobe/storage cupboard, access to eaves storage space.

Shower room:

Suite comprising shower cubicle, wash basin, WC.

OUTSIDE

Front:

To the front of the property is a double width driveway, side gate and path to rear garden.

Rear:

Approximately 35 ft x 35 ft. Adjoining the property is a full width paved terrace with retaining wall and steps up to a lawned area enclosed by fencing.

Double garage:

17'6" x 17" (5.33m x 5.19m) Loft storage space, door to rear.

OTHER INFORMATION

Available:

Immediately

Holding Deposit:

£576.92

Security Deposit:

£2884.00

Heating:

Gas central heating

Windows:

UPVC double glazing

Infant/Junior School:

Knightwood Primary School

Secondary School:

Thornden School

Local Council:

Test Valley Borough Council - 01264 368000

Council Tax:

Band F

Ground Floor = 765 sq ft / 71 sq m
 First Floor = 585 sq ft / 54.3 sq m
 Second Floor = 281 sq ft / 26.1 sq m
 Garage = 298 sq ft / 27.6 sq m
 Total = 1929 sq ft / 179 sq m
 For identification only - Not to scale

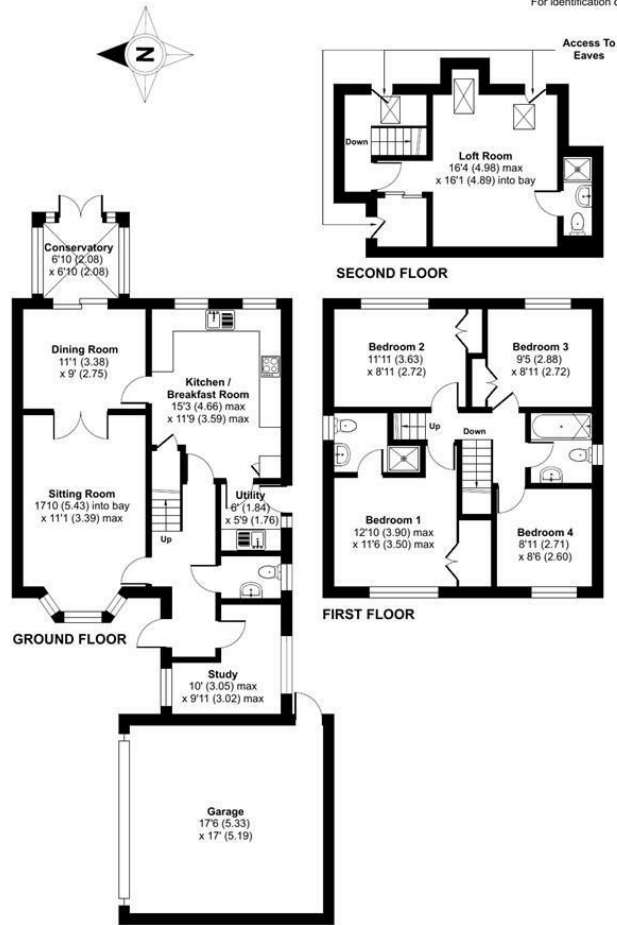

Energy Efficiency Rating		
	Current	Potential
Very energy efficient - lower running costs		
(92 plus) A		
(81-91) B		82
(69-80) C	74	
(55-68) D		
(39-54) E		
(21-38) F		
(1-20) G		
Not energy efficient - higher running costs		
England & Wales	EU Directive 2002/91/EC	

Floor plan produced in accordance with RICS Property Measurement 2nd Edition, Incorporating International Property Measurement Standards (IPMS2 Residential). © ritchicom 2026. Produced for Sparks Ellison. REF: 1433299

94 Winchester Road, Chandler's Ford, Hampshire, SO53 2GJ

Sales: t: 02380 255333 e: property@sparksellison.co.uk
 Lettings: t: 02380 018518 e: lettings@sparksellison.co.uk

While we endeavour to make our sales particulars fair, accurate and reliable, they are only a general guide to the property and, accordingly, if there is any point which is of particular importance to you please contact the office and we will be pleased to check it for you, especially if you are contemplating travelling some distance to view the property. These approximate room sizes are only intended as general guidance. You must verify the dimensions carefully before ordering carpets or any built in furniture. Please note we have not tested the services or any of the equipment or appliances in this property, accordingly we strongly advise prospective buyers to commission their own survey or service report before finalising their offer to purchase. These particulars are issued in good faith but do not constitute representations of fact or form part of any offer or contract. The matters referred to in these particulars should be independently verified by prospective buyers or tenants. Neither Sparks Ellison nor any of its employees or agents has any authority to make or give any representation or warranty whatever in relation to this property. Your home is at risk if you do not keep up repayments on a mortgage or other loan secured on it. Written quotations available on request. All loans secured on property. Life assurance usually required.



