

£1,600 pcm

Hatherley Road, Sidcup, DA14 4BD



- SPACIOUS & BEAUTIFULLY PRESENTED 2 BEDROOM 1ST FLOOR MAISONETTE
- GAS CENTRAL HEATING & DOUBLE GLAZED WINDOWS
- SPACIOUS LOUNGE DINER WITH WINDOWS TO REAR
- MODERN KITCHEN WITH A RANGE OF WALL & BASE UNITS
- 2 X DOUBLE SIZE BEDROOMS
- BATHROOM WITH OVERBATH SHOWER
- PRIVATE EASY MAINTENANCE GARDEN TO REAR
- GARAGE EN BLOC PROVIDING OFF STREET PARKING

To view all our homes: www.drewery.co.uk





SPACIOUS & BEAUTIFULLY PRESENTED 2 BEDROOM 1ST FLOOR MAISONETTE: UNFURNISHED

A spacious and well presented two bedroom first floor maisonette. Situated in a popular residential location which is close to all local amenities including: Sidcup High Street, schools, local parks, bus routes and is within a short walk of Sidcup mainline railway station.

The property benefits from gas central heating, double glazed windows and a neutral décor throughout.

The accommodation comprises: Entrance hallway to landing. Spacious lounge / diner with double glazed windows. Modern kitchen with a range of wall and base units, work surfaces, sink with drainer, oven, gas hob, fridge / freezer, washing machine and tumble dryer. Two spacious double bedrooms with the master benefitting from a large wardrobe. Modern bathroom with hand basin, bath with overbath shower and W.C. Externally there is a garage en-bloc, parking space and a private low maintenance garden to the rear.

The property is available early March.

Restrictions: no smokers, pets, students or sharers.

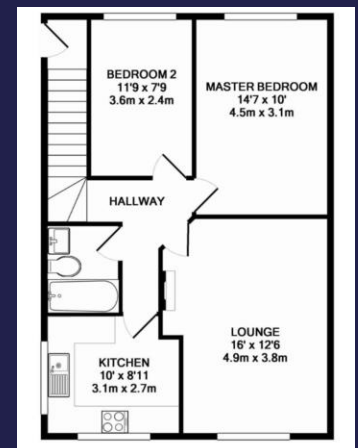

Energy Efficiency Rating TBC.
(TBC/TBC) EIR TBC/TBC

If you would like to view please contact Drewery Property Consultants on **020 8269 6600**

These particulars are intended to give a fair description of the property but their accuracy cannot be guaranteed. Intending tenants should not rely on them as statements of representation of fact, but must satisfy themselves by inspection or otherwise as to their accuracy. All measurements quoted are approximate. None of the appliances/services have been tested by ourselves.

*Important - Admin fees apply per applicant. Please visit our website www.drewery.co.uk (information for tenants - Fees & other costs) or contact our staff.