



Connells

Field Close
Sandridge St. Albans



Property Description

Situated in the highly sought-after Marshaswick area of St Albans, this well-presented two-bedroom mid-terrace home offers comfortable living in a quiet and family-friendly setting.

The property features a welcoming porch extension leading into a bright lounge, with a separate fitted kitchen providing practical and well-defined living space. Upstairs are two generous double bedrooms, complemented by a recently refurbished modern bathroom.

Externally, the home benefits from a private rear garden which is not overlooked, ideal for relaxing or entertaining, along with a front garden. A garage en bloc provides additional storage or parking convenience.

Field Close is situated in a quiet cul-de-sac location within the highly sought after area of Marshalswick in St Albans, renowned for its well-regarded schools. The Quadrant shopping centre in Marshalswick boasts a large selection of local shops and eateries including a Marks and Spencer food hall and then St Albans City Centre is less than two miles away and provides an excellent selection of shopping and leisure facilities along with a mainline railway station to London St Pancras.

Perfectly positioned for families, the property is located just 0.1 miles from Wheatfields Junior School and 0.4 miles from the highly regarded Sandringham School. With local amenities, green spaces and transport links nearby, this home represents an excellent opportunity for first-time buyers, downsizers or investors alike.



Hall

Kitchen

7' 3" max x 7' 2" max (2.21m max x 2.18m max)

Lounge

15' 8" max x 12' 8" max (4.78m max x 3.86m max)

Bedroom One

12' 8" max x 10' 8" max (3.86m max x 3.25m max)

Bedroom Two

12' 5" max x 7' max (3.78m max x 2.13m max)

Bathroom



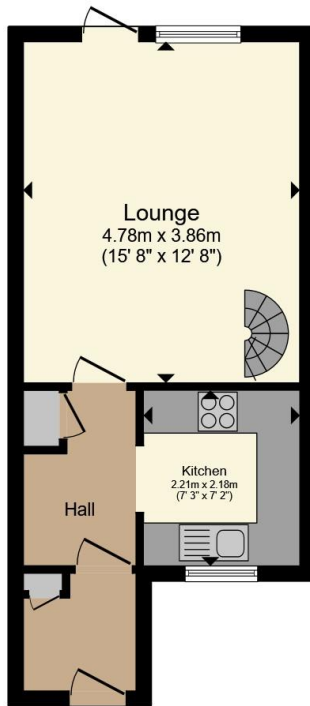

Ground Floor

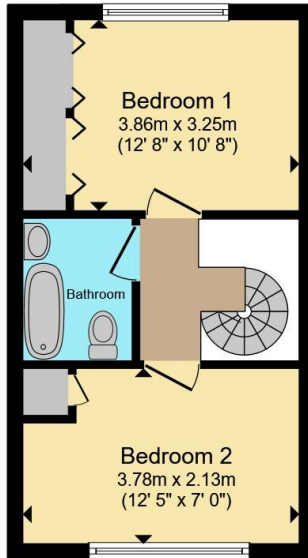

First Floor

Total floor area 59.4 m² (639 sq.ft.) approx

This floor plan is for illustrative purposes only. It is not drawn to scale. Any measurements, floor areas (including any total floor area), openings and orientation are approximate. No details are guaranteed, they cannot be relied upon for any purpose and they do not form part of any agreement. No liability is taken for any error, omission or misstatement. A party must rely upon its own inspection(s). Powered by www.propertybox.io



To view this property please contact Connells on

T 01727 851 100
E marshalswick@connells.co.uk

5 Wycombe Place The Quadrant Marshalswick
 ST ALBANS AL4 9RH

EPC Rating: C Council Tax Band: D

view this property online connells.co.uk/Property/MWK306187

Tenure: Freehold



1. MONEY LAUNDERING REGULATIONS Intending purchasers will be asked to produce identification documentation at a later stage and we would ask for your co-operation in order that there will be no delay in agreeing the sale. 2. These particulars do not constitute part or all of an offer or contract. 3. The measurements indicated are supplied for guidance only and as such must be considered incorrect. Potential buyers are advised to recheck measurements before committing to any expense. 4. We have not tested any apparatus, equipment, fixtures, fittings or services and it is in the buyers interest to check the working condition of any appliances.

Connells Residential is registered in England and Wales under company number 1489613, Registered Office is Cumbria House, 16-20 Hockliffe Street, Leighton Buzzard, Bedfordshire, LU7 1GN. VAT Registration Number is 500 2481 05.

See all our properties at www.connells.co.uk | www.rightmove.co.uk | www.zoopla.co.uk

Property Ref: MWK306187 - 0005