



Westover Road, Southampton SO16 9BL

welcome to

Westover Road, Southampton

Beautifully Presented 2-Bedroom Detached Bungalow – Westover Road, Redbridge, Southampton

Set in the ever-popular residential area of Redbridge, this beautifully maintained two-bedroom detached bungalow offers modern living, generous outdoor space and a move-in-ready finish throughout.



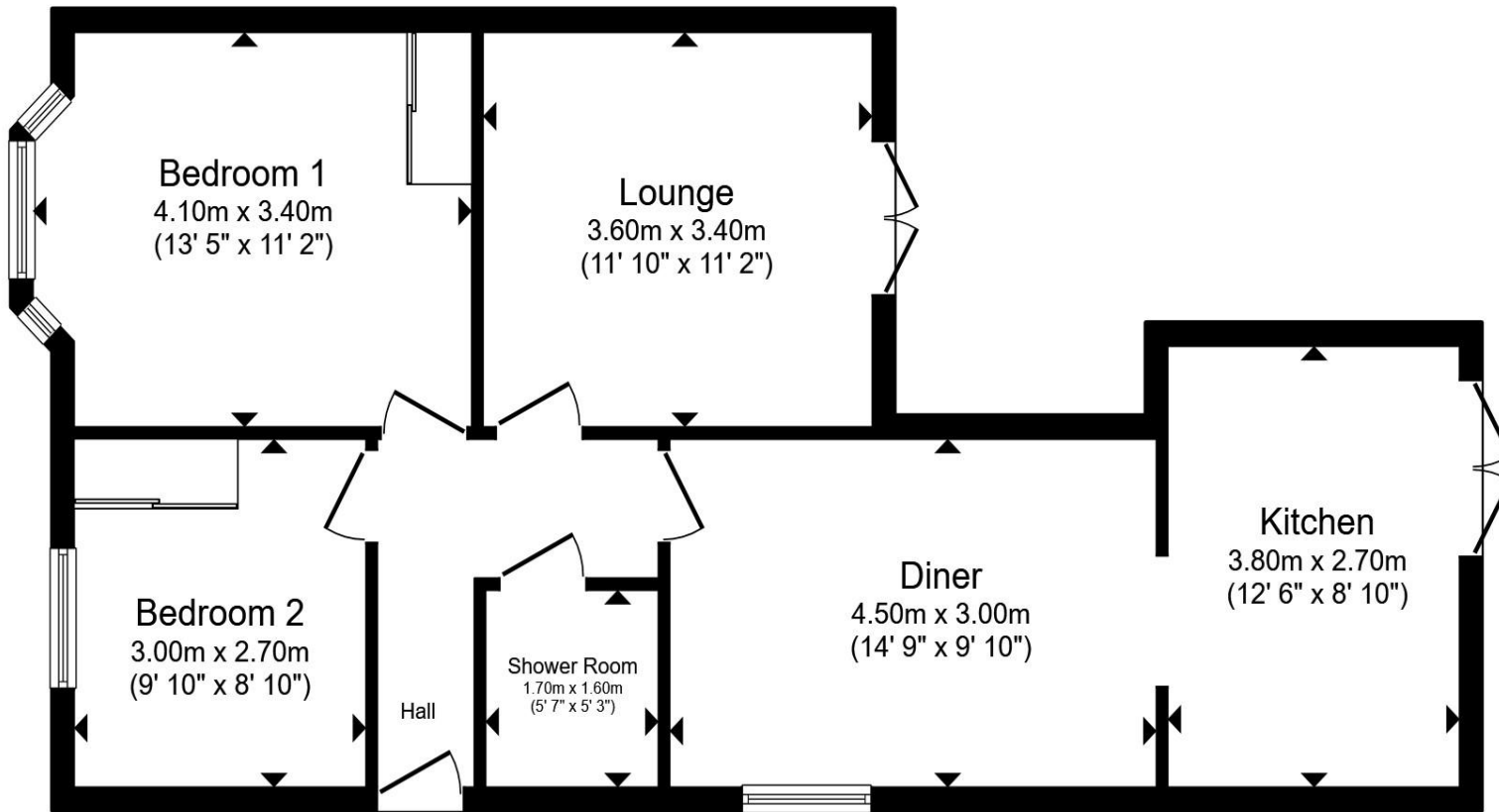

Floor Plan

Entrance Hall

Lounge

11' 10" x 11' 2" (3.61m x 3.40m)

Diner

14' 9" x 9' 10" (4.50m x 3.00m)

Kitchen

12' 6" x 8' 10" (3.81m x 2.69m)

Shower Room

5' 7" x 5' 3" (1.70m x 1.60m)

Bedroom One

13' 5" max into bay x 11' 2" max (4.09m max into bay x 3.40m max)

Bedroom Two

9' 10" max x 8' 10" (3.00m max x 2.69m)

Total floor area 67.0 m² (722 sq.ft.) approx

This floor plan is for illustrative purposes only. It is not drawn to scale. Any measurements, floor areas (including any total floor area), openings and orientation are approximate. No details are guaranteed, they cannot be relied upon for any purpose and they do not form part of any agreement. No liability is taken for any error, omission or misstatement. A party must rely upon its own inspection(s). Powered by www.propertybox.io



welcome to

Westover Road, Southampton

- Separate Lounge & Dining Rooms
- Large Driveway for Multiple Vehicles & On-Street Parking
- Two Double Bedrooms with Built In Wardrobes
- Exterior Repainted Last Year
- Fully Boarded Loft with Electrics & Lighting

Tenure: Freehold EPC Rating: C
Council Tax Band: C

offers in excess of
£350,000



Please note the marker reflects the
postcode not the actual property

view this property online fox-and-sons.co.uk/Property/SOU117946



Property Ref:
SOU117946 - 0004

1. MONEY LAUNDERING REGULATIONS Intending purchasers will be asked to produce identification documentation at a later stage and we would ask for your co-operation in order that there is no delay in agreeing the sale. 2. These particulars do not constitute part or all of an offer or contract. 3. The measurements indicated are supplied for guidance only and as such must be considered incorrect. Potential buyers are advised to recheck measurements before committing to any expense. 4. We have not tested any apparatus, equipment, fixtures or services and it is in the buyers interest to check the working condition of any appliances. 5. Where an EPC, or a Home Report (Scotland only) is held for this property, it is available for inspection at the branch by appointment. If you require a printed version of a Home Report, you will need to pay a reasonable production charge reflecting printing and other costs. 6. We are not able to offer an opinion either written or verbal on the content of these reports and this must be obtained from your legal representative. 7. Whilst we take care in preparing these reports, a buyer should ensure that his/her legal representative confirms as soon as possible all matters relating to title including the extent and boundaries of the property and other important matters before exchange of contracts.

Fox & Sons is a trading name of Sequence (UK) Limited which is registered in England and Wales under company number 4268443, Registered Office is Cumbria House, 16-20 Hockliffe Street, Leighton Buzzard, Bedfordshire, LU7 1GN. VAT Registration Number is 500 2481 05.

fox & sons



02380 225155



Southampton@fox-and-sons.co.uk



32 - 34 London Road, SOUTHAMPTON,
Hampshire, SO15 2AG



fox-and-sons.co.uk