

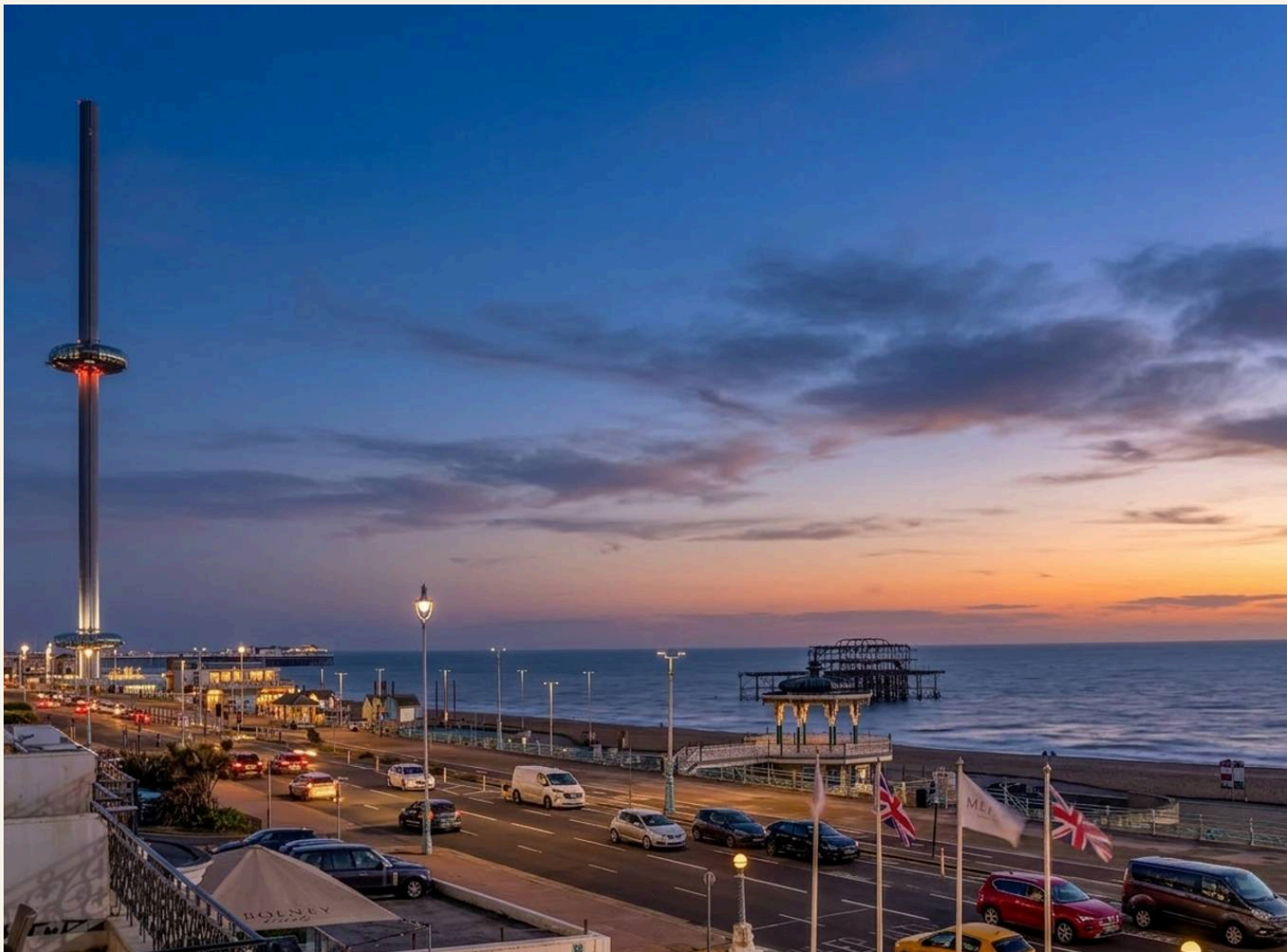

HW

ESTATE AGENTS

Cumberland Court, Kings Road
£325,000



Cumberland Court, Brighton

Seafront 1-bed apartment on Brighton's Kings Road with sea views, modern kitchen, double bedroom, allocated parking, and share of freehold. Close to city centre, beach, and transport links.

Council Tax band: C

Tenure: Share of Freehold

EPC Energy Efficiency Rating: C

EPC Environmental Impact Rating: C

- Guide Price: £325,000 - £350,000
- Seafront location
- Allocated parking
- Share of freehold
- Modern kitchen with integrated appliances
- Open plan living space
- Period Victorian architecture
- Modern bathroom with bath and shower
- Walking distance to Brighton station, city centre and amenities
- Chain free





Kings Road

Approx. Gross Internal Area:- 49.22 sq.m. 529.79 sq.ft.

HW

ESTATE AGENTS

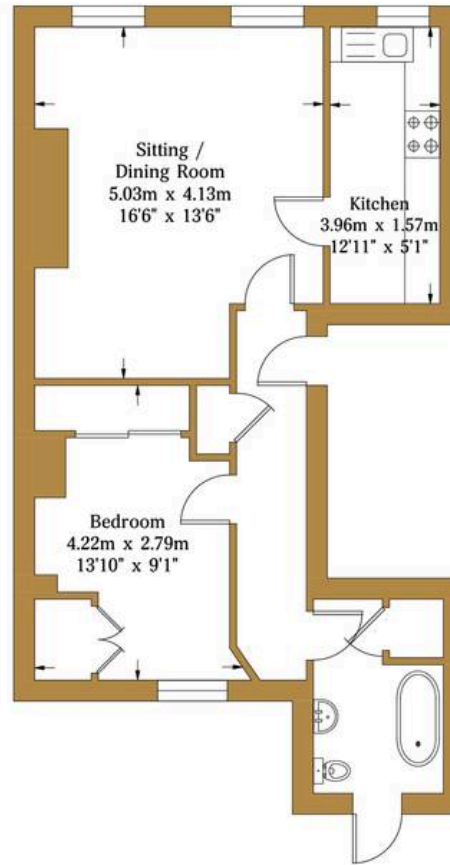

Second Floor
Approximate Floor Area
529.79 sq ft
(49.22 sq m)

Illustration for identification purposes only, measurements are approximate, not to scale.

© hwestateagents



HW Estate Agents

HW Estate Agents, 80 Goldstone Villas, Hove - BN3 3RU

01273 359000 · hove@hwestateagents.co.uk · www.hwestateagents.co.uk

HW

ESTATE AGENTS