



Everest Court

South Norwood Hill | London | London | SE25 6DR

£210,000



Everest Court

South Norwood Hill | London

London | SE25 6DR

£210,000

Nestled in the desirable area of South Norwood Hill, this charming flat offers a perfect opportunity for first-time buyers seeking a bright and airy living space. Spanning approximately 440 square feet, the property features a well-proportioned reception room that invites natural light, creating a warm and welcoming atmosphere.

The flat comprises one comfortable bedroom, separate kitchen and a modern bathroom, making it an ideal retreat for individuals or couples. The long lease adds to the appeal, providing peace of mind for potential homeowners.

Situated close to the vibrant Crystal Palace Triangle, residents will enjoy easy access to a variety of shops, cafes, and restaurants, enhancing the overall lifestyle experience. The location is well-connected, ensuring convenient transport links to central London and beyond.

- Bright and airy flat
- Close to Crystal Palace
- Long lease
- 440 sq ft living space
- Viewing recommended
- Sought after location
- Ideal for first-time buyers
- Spacious reception room
- Flat in South Norwood



Everest Court, SE25 6DR

Approx. Gross Internal Area 440.78 Sq Ft - 40.95 Sq M

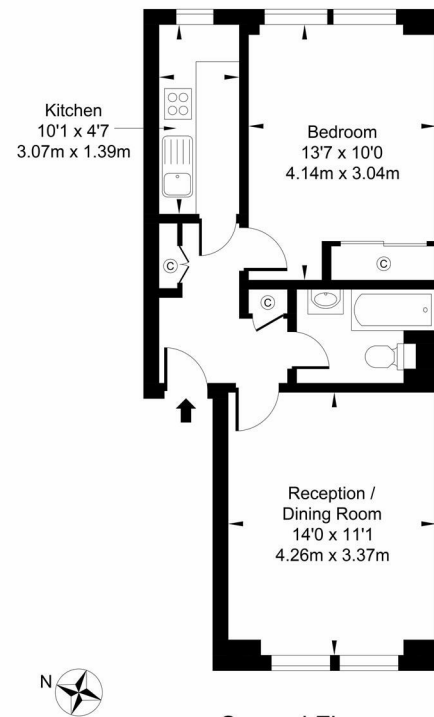

For Illustration Purposes Only - Not To Scale

This floor plan should be used as a general outline for guidance only. All Measurements are approximate and for illustration purposes only as defined by the RICS code of Measuring Practice © 2021.

Energy Efficiency Rating		Current	Potential
<i>Very energy efficient - lower running costs</i>			
(92 plus)	A		
(81-91)	B		82
(69-80)	C		
(55-68)	D	61	
(39-54)	E		
(21-38)	F		
(1-20)	G		
<i>Not energy efficient - higher running costs</i>			
England & Wales		EU Directive 2002/91/EC	

Council Tax Band B

EPC Rating D

467 Norwood Road
West Norwood
London
SE27 9DJ
02087610830

dean@movinginn.co.uk
www.movinginn.co.uk