



ASKING PRICE

**£600,000**

**Mackintosh Street**

Bromley, BR2 9GT

## PROPERTY SUMMARY

Sinclair Hammelton are proud to bring to the market this beautifully presented three/four-bedroom terraced house, tastefully modernised by the current owners. Conveniently located, the property offers excellent transport links, being approximately one mile from Bickley railway station, as well as close to local bus routes servicing Bromley South railway station, Petts Wood railway station and Orpington railway station.

The living accommodation comprises an entrance hallway leading to a modern open-plan kitchen/living/dining room, featuring a fully fitted kitchen with integrated appliances and built-in storage. On the first floor, there is a spacious reception room with access to a private balcony, along with bedroom three, which also benefits from balcony access.

The second floor offers two generous double bedrooms with built-in storage, with the principal bedroom further benefiting from an en-suite shower room.

Externally, the property benefits from allocated off-street parking, additional guest parking spaces, and a private, low-maintenance garden.

Viewing is highly recommended.

3



2



2









# Mackintosh Street, BR2

Approximate Gross Internal Area 112.1 sq m / 1208 sq ft

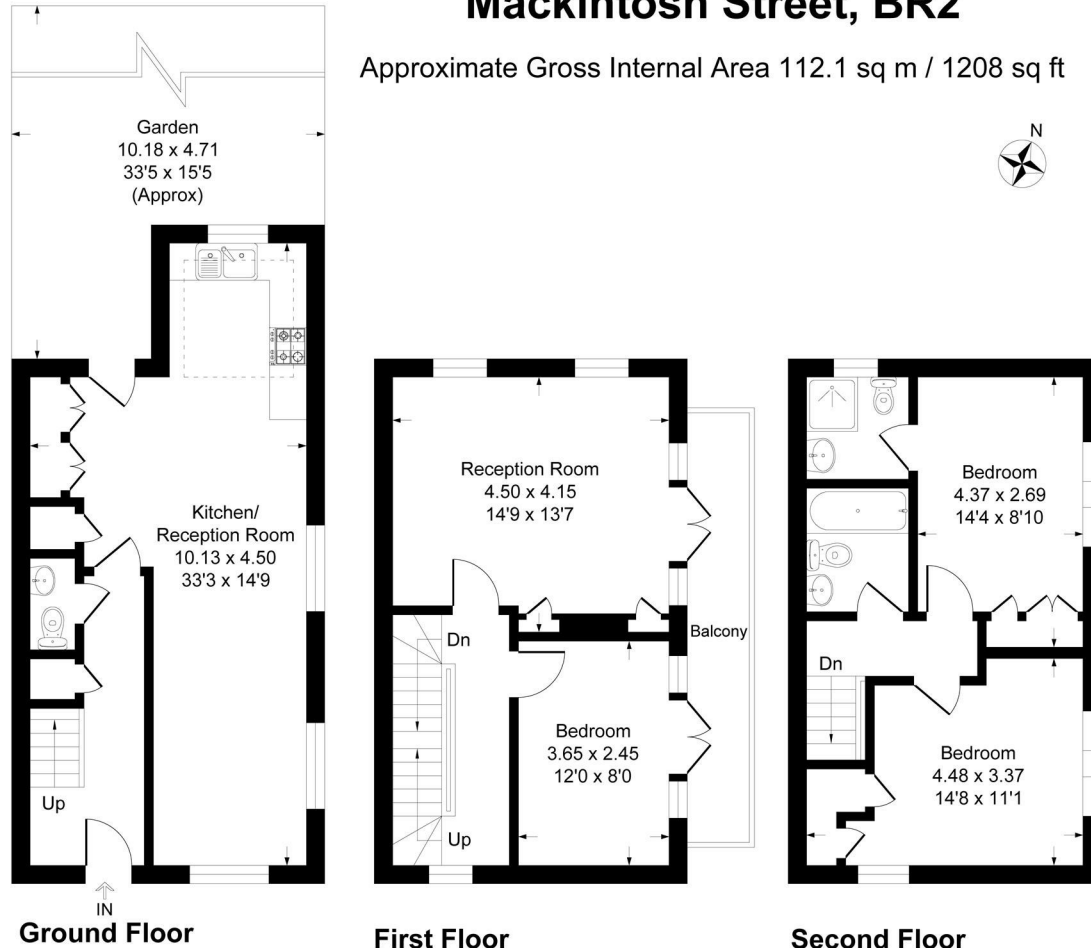

**Ground Floor**

**First Floor**

**Second Floor**



This plan is for layout guidance only. Not drawn to scale unless stated. Windows and door openings are approximate. Whilst every care is taken in the preparation of this plan, please check all dimensions, shapes and compass bearings before making any decisions reliant upon them.  
Produced By Planpix



## LOCAL AUTHORITY

**TENURE**  
Freehold

**EPC RATING:**  
C

**COUNCIL TAX BAND**  
E

**VIEWINGS**  
By prior appointment only

Energy Efficiency Rating		Current	Potential
<i>Very energy efficient - lower running costs</i>			
(92 plus) <b>A</b>			
(81-91) <b>B</b>			
(69-80) <b>C</b>		78	87
(55-68) <b>D</b>			
(39-54) <b>E</b>			
(21-38) <b>F</b>			
(1-20) <b>G</b>			
<i>Not energy efficient - higher running costs</i>			
<b>England &amp; Wales</b>		EU Directive 2002/91/EC	

Agents Note: Whilst every care has been taken to prepare these particulars, they are for guidance purposes only. All measurements are approximate and are for general guidance purposes only and whilst every care has been taken to ensure their accuracy, they should not be relied upon and potential buyers/tenants are advised to recheck the measurements



### OFFICE ADDRESS

23 High Street  
Bromley  
Kent  
BR1 1LG

### OFFICE DETAILS

0208 464 5566  
info@sinclairhammelton.co.uk