

# Towers Wills

Town & Country

📞 01935 577 032 | 01460 298 530 | ✉ info@towerswills.co.uk



23, Rivers Road, Yeovil, Somerset BA21 5RJ

**£270,000**

Towers Wills are delighted to welcome to the market this superbly presented and refurbished three-bedroom semi-detached home, situated in a popular residential area within close proximity to Yeovil town centre and a range of local amenities.

### **Accommodation:**

The property has undergone a comprehensive programme of refurbishment and thoughtful reconfiguration to create a beautiful and contemporary family home. Particular attention has been paid to the quality of fixtures and fittings throughout, resulting in an interior that is both stylish and practical.

The ground floor accommodation comprises a comfortable and well-proportioned lounge, along with a superb kitchen-diner which truly forms the hub of the home. This impressive space is ideal for modern family living and entertaining, benefitting from patio doors that open directly onto the rear garden, creating a seamless connection between indoor and outdoor living.

To the first floor, there are three well-balanced bedrooms together with a modern, well-finished bathroom suite.

### **Outside:**

Externally, the rear garden has been designed for ease of maintenance, featuring a small hardstanding area and the remainder laid to lawn. To the front of the property there is off-road parking for one vehicle, along with a single garage fitted with an up-and-over door.

Early viewing is strongly recommended to fully appreciate the high standard of accommodation on offer and the property's excellent location.

### **Agents Note:**

The current owner has advised that a brand new boiler was installed in August 2025.

## Key Features

- Semi-Detached
- Popular Location
- Recently Refurbished
- Three Bedrooms
- Driveway & Garage
- Gardens

## Contact Us

### **Towers Wills Estate Agents - Yeovil**

114, Hendford Hill

Yeovil

Somerset

BA202RF

T: 01935 577032

E: [info@towerswills.co.uk](mailto:info@towerswills.co.uk)





# Floor Plan

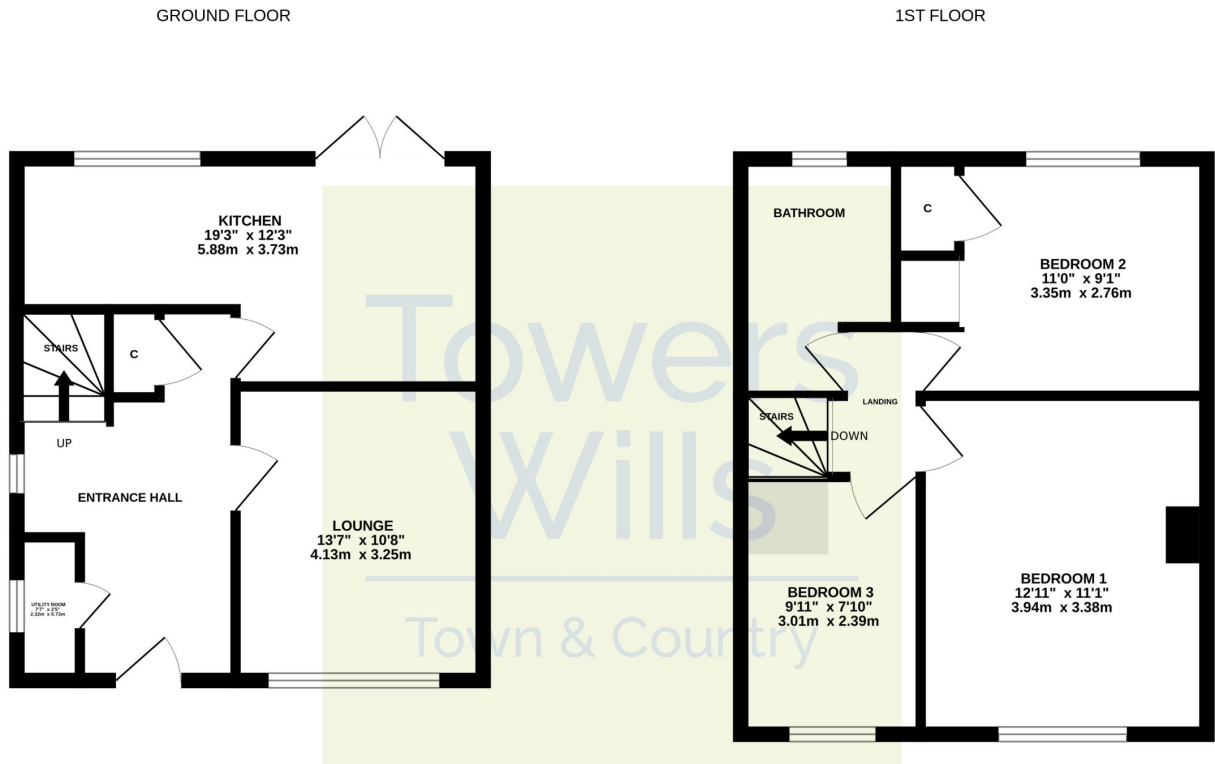

Whilst every attempt has been made to ensure the accuracy of the floorplan contained here, measurements of doors, windows, rooms and any other items are approximate and no responsibility is taken for any error, omission or mis-statement. This plan is for illustrative purposes only and should be used as such by any prospective purchaser. The services, systems and appliances shown have not been tested and no guarantee as to their operability or efficiency can be given.  
Made with Metropix ©2025

Please Note No tests have been undertaken of any of the services and any intending purchasers should satisfy themselves in this regard. Towers Wills Ltd for themselves and for the vendor of this property whose agents they are, give notice that, (i) these particulars do not constitute any part of an offer or contract, (ii) all statements contained within these particulars are made without responsibility on the part of Towers Wills or the vendor , (iii) whilst made in good faith, none of the statements contained within these particulars are to be relied upon as a statement of representation or fact , (iv) any intending purchaser must satisfy him/herself by inspection or otherwise as to the correctness of each of the statements contained within these particulars, (v) the vendor does not make or give either Towers Wills or any person in their employment any authority to make or give representation or warranty whatsoever in relation to this property.

Photographs / Floor Plans Photographs are reproduced for general information and it must not be inferred that any item is included for sale with this property. Please note floor plans are not to scale and are for identification purposes only. The photographs used in these particulars may have been taken with the use of a wide angle lens. If you have any queries as to the size of the accommodation or plot, please address these with the agent prior to making an appointment to view