

jordan fishwick

4 SEYMOUR HOUSE TUDOR ROAD WILMSLOW SK9 2HB
Guide Price £129,950

4 SEYMOUR HOUSE TUDOR ROAD WILMSLOW SK9 2HB

Set within a quiet and well maintained cul-de-sac, this attractive ground floor studio apartment offers smart, low-maintenance living in a highly convenient location. The accommodation is thoughtfully arranged to maximise space and functionality, featuring a bright open-plan living and sleeping area alongside a contemporary fitted kitchen with integrated appliances. The property also benefits from useful built-in storage, creating a practical and comfortable home. Ideally positioned for commuters, the apartment provides excellent access to the A34, M56 and surrounding motorway network, with Manchester Airport also within easy reach. Wilmslow town centre is nearby and offers a wide range of amenities including shops, cafés, restaurants and leisure facilities, while Wilmslow railway station provides direct services to Manchester city centre and London Euston. An ideal purchase for first-time buyers, investors or those seeking a conveniently located apartment in a desirable area.

GROUND FLOOR

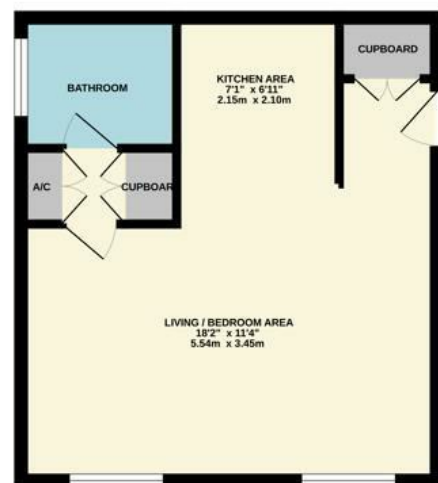

Measurements are approximate. Not for scale. Dimensions given in feet and inches.

- Studio Apartment
- Ground Floor
- Close Proximity To Amenities
- Bathroom
- Fitted Kitchen
- Cul de Sac position
- Parking

Energy Efficiency Rating		Current	Potential
Very energy efficient - lower running costs	(92 plus) A		
	(81-91) B		
	(69-80) C		
	(55-68) D		
	(39-54) E		
	(21-38) F		
	(1-20) G		
Not energy efficient - higher running costs			
England & Wales		EU Directive 2002/91/EC	

Environmental Impact (CO ₂) Rating		Current	Potential
Very environmentally friendly - lower CO ₂ emissions	(92 plus) A		
	(81-91) B		
	(69-80) C		
	(55-68) D		
	(39-54) E		
	(21-38) F		
	(1-20) G		
Not environmentally friendly - higher CO ₂ emissions			
England & Wales		EU Directive 2002/91/EC	