

20 Rhodes Avenue

Bishop's Stortford

Just a short walk to Bishop's Stortford train station, this oh-so-pretty three bedroom home is stacked with features to love. Welcome to Rhodes Avenue.

Council Tax band: D

Tenure: Freehold

- Beautiful three bedroom home
- Driveway
- Ideal first time buy
- Private landscaped garden
- Short walk to Bishop's Stortford train station
- Close to Bishop's Stortford town centre



Entrance Hall

Living Room

13' 7" x 11' 0" (4.14m x 3.36m)

Dining Room

10' 4" x 11' 0" (3.16m x 3.36m)

Kitchen

10' 0" x 11' 0" (3.06m x 3.36m)

Bedroom

9' 6" x 11' 0" (2.90m x 3.36m)

Bedroom

9' 8" x 8' 3" (2.94m x 2.51m)

Bedroom

8' 7" x 6' 11" (2.62m x 2.10m)

Bathroom





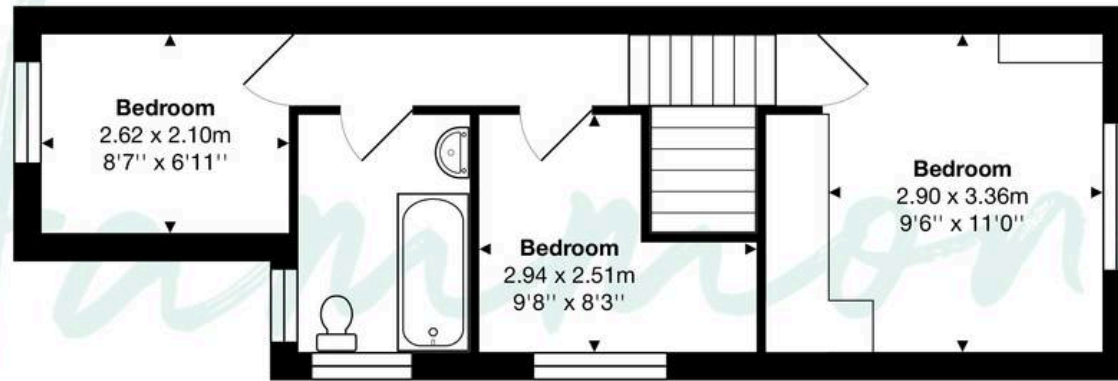

First Floor

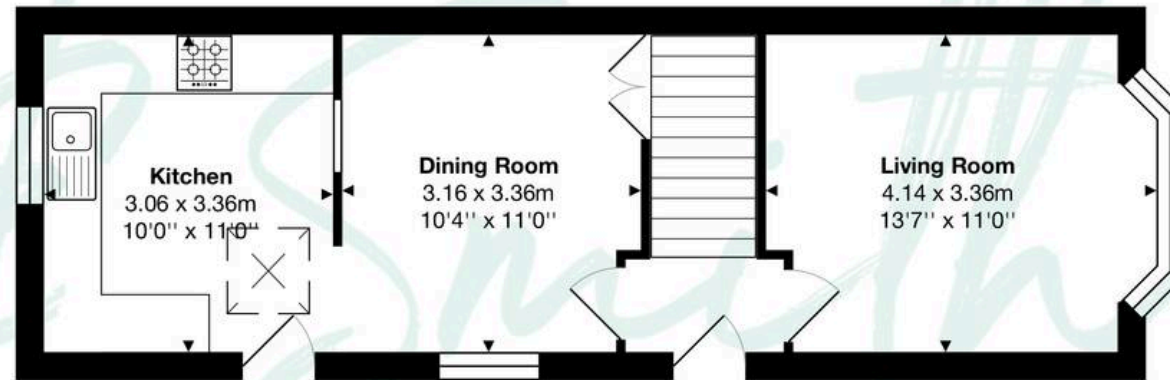

Ground Floor

Total Area: approx. 73.4 m² ... 790 ft²

THE FLOORPLAN IS FOR ILLUSTRATIVE PURPOSES ONLY AND IS NOT TO SCALE.
 Measurements and features are approximate and may differ from the actual property. Verify all details independently; no liability is accepted for errors or omissions.

Property marketing provided by www.fotomarketing.co.uk