



Pinkmove

Fosse Road

Guide Price £200,000 to £210,000

- No Chain
- Spacious Bungalow
- Low-Maintenance Rear Garden
- Excellent Transport Links
- Close to Schools & Amenities
- EPC Rating: D



2 1 1

Pinkmove

01633 746088
team@pinkmove.co.uk



Pinkmove

About the property

Situated in the highly sought-after Lliswerry area of Newport, this attractive bungalow offers an excellent opportunity to enjoy a blend of character, generous space and everyday convenience. The property benefits from superb connectivity and is ideally positioned close to a wide range of local amenities.

Entering the bungalow, a welcoming hallway provides access to a spacious lounge positioned to the left, offering a comfortable space for relaxing. Just off the hallway is the well-appointed kitchen, while two well-proportioned bedrooms are located beyond, providing flexible accommodation suitable for a range of buyers.

To the rear, the property boasts a spacious, low-maintenance garden, perfect for outdoor relaxation or entertaining friends and family. Fosse Road is well regarded for its proximity to reputable local schools, including Lliswerry Primary and High School, as well as excellent transport links via the Southern Distributor Road and M4, providing easy access to Cardiff, Bristol and further afield. Additional amenities such as local shops, leisure facilities, Spytty Retail Park and Newport city centre are all conveniently nearby.

Early viewing is highly recommended to fully appreciate what this property has to offer.



Pinkmove



Pinkmove



Accommodation

Lounge

Kitchen

Bedroom 1

Bedroom 2

Shower Room

01633 746088

team@pinkmove.co.uk

Pinkmove

Floorplan

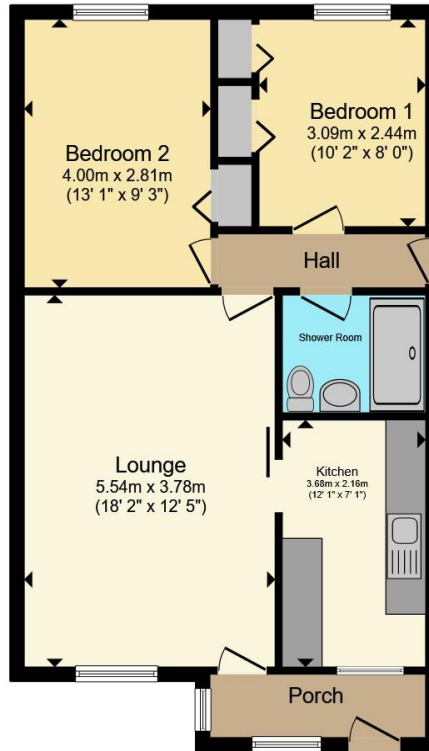

Total floor area 61.7 sq.m. (664 sq.ft.) approx

This floor plan is for illustrative purposes only. It is not drawn to scale. Any measurements, floor areas (including any total floor area), openings and orientation are approximate. No details are guaranteed, they cannot be relied upon for any purpose and they do not form part of any agreement. No liability is taken for any error, omission or misstatement. A party must rely upon its own inspection(s). Powered by www.focalagent.com

Pinkmove

Important Information

Note while we endeavour to make our sales details accurate and reliable, if there is any point which is of particular interest to you, please contact the office and we will be pleased to confirm the position for you. We have not personally tested any apparatus, equipment, fixtures, fittings or services and cannot verify they are in working order or fit for their purposes. Nothing in these particulars is intended to indicate that carpets or curtains, furnishings or fittings, electrical goods (whether wired or not). Gas fires or light fittings or any other fixtures not expressly included form part of the property offered for sale. This computer generated Floorplan, if applicable, is intended as a general guide to the layout and design of the property. It is not to scale and should not be relied upon for dimensions. Tenure: We cannot confirm the tenure of the property as we have not had access to the legal documents. The buyer is advised to obtain verification from their solicitor or surveyor.

Peter Alan Limited is registered in England and Wales under company number 2073153. Registered Office is Cumbria House, 16-20 Hockliffe Street, Leighton Buzzard, Bedfordshire, LU7 1GN. VAT Registration Number is 500 2481 05. For activities relating to regulated mortgages and non-investment insurance contracts, Peter Alan Limited is an appointed representative of Connells Limited which is authorised and regulated by the Financial Conduct Authority. Connells Limited's Financial Services Register number is 302221. Most buy-to-let

