



## Kildare Court, W2

£1,075,000



- Allocated Private Garage
- No Onward Chain
- Open Plan Kitchen
- Two Double Bedroom
- Duplex Apartment
- Quiet Street

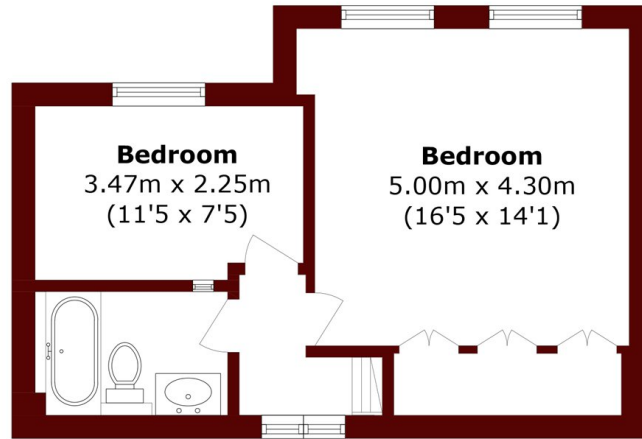

**Fourth Floor**

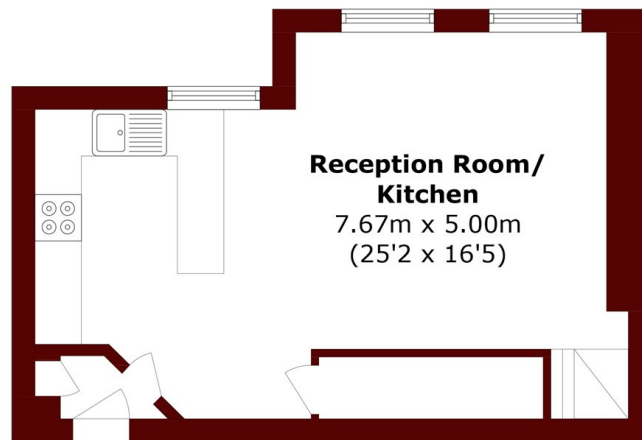

**Third Floor**

Total area (approx.): 70.0 sq. m (753.4 sq. ft)

**Marsh & Parsons Notting Hill**

2-6 Kensington Park Road,  
London, W11 3BU  
020 7313 2890