



James Close

Upton, Northampton

oriordanbond
SALES & LETTINGS



GROUND FLOOR
641 sq.ft. (59.5 sq.m.) approx.

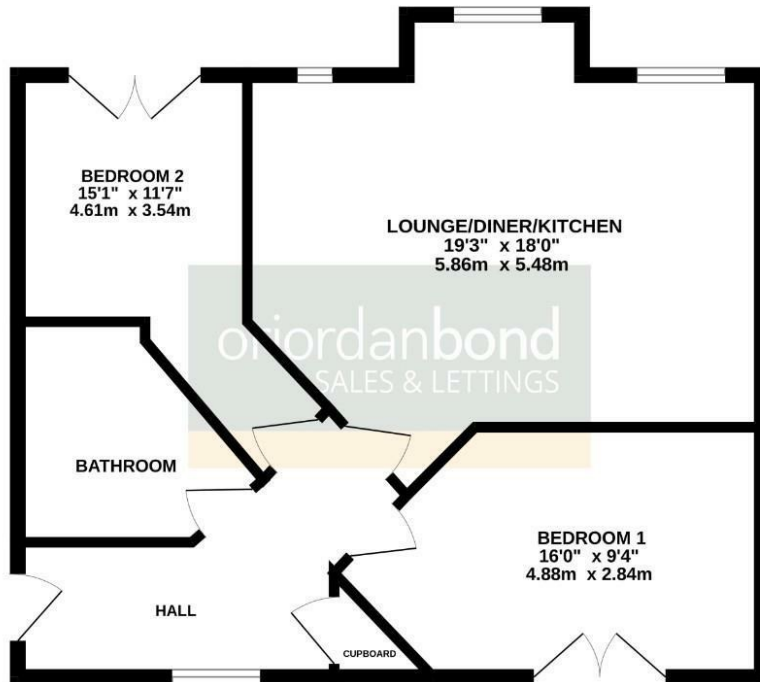

TOTAL FLOOR AREA: 641 sq.ft. (59.5 sq.m.) approx.
Whilst every attempt has been made to ensure the accuracy of the floorplan contained here, measurements of doors, windows, rooms and any other items are approximate and no responsibility is taken for any error, omission or misstatement. This plan is for illustrative purposes only and should be used as such by any prospective purchaser. The services, systems and appliances shown have not been tested and no guarantee, as to their operability or efficiency can be given.
Made with Mirograph CCDC.

James Close

Upton
NN5 4GY

ASKING PRICE £200,000

Constructed in 2022 by Messrs Morris Homes is this immaculate two bedroom apartment. Set on the first floor in the block, the property would make an ideal purchase for first time buyers offering generous living space, situated within the ever popular area of Upton, offering great travel links to the M1.

The accommodation comprises open plan living/kitchen with the kitchen benefitting from integrated appliances, two double bedrooms and a four-piece family bathroom. Benefits include gas radiator heating, uPVC double glazing, a secure intercom entry system and two allocated parking spaces (A/641/-)

Leasehold information: Lease remaining - 995 years (as of 2026) / Ground Rent - N/A / Service Charge - £2640 per annum

Additional information

- Council Tax Band: B
- Energy Efficiency Rating: B

Viewing

Viewing strictly by appointment – details below

Disclaimer

O'Riordan Bond Estate Agents Limited has not tested apparatus, equipment, fittings or services and so cannot verify they are in working order. The buyer is advised to obtain verification from their solicitor or surveyor.

O'Riordan Bond Duston Sales
01604 589007

duston@oriordanbond.co.uk

