



## LAMBOURN ROAD, SW4

£750,000

Share of freehold  
Private outside space  
960 year lease  
Split level apartment  
Old Town location  
Energy rating: C

@marshandparsons  
marshandparsons.co.uk

MARSH &  
PARSONS



# ABOUT THE PROPERTY

A superb two double bedroom split-level garden flat, offering close to 1,000 sq ft of beautifully arranged living space over two floors, with direct access to a large decked garden.

The property comprises a spacious reception room, a separate kitchen, two generous double bedrooms, and a family bathroom. Further benefits include excellent storage and direct access to a large private decked garden.

Lambourn Road is a peaceful residential street nestled in the heart of Clapham Old Town, just a short stroll from the expansive green spaces of Clapham Common. The area is exceptionally well-connected.



# STEP INSIDE LAMBOURN ROAD

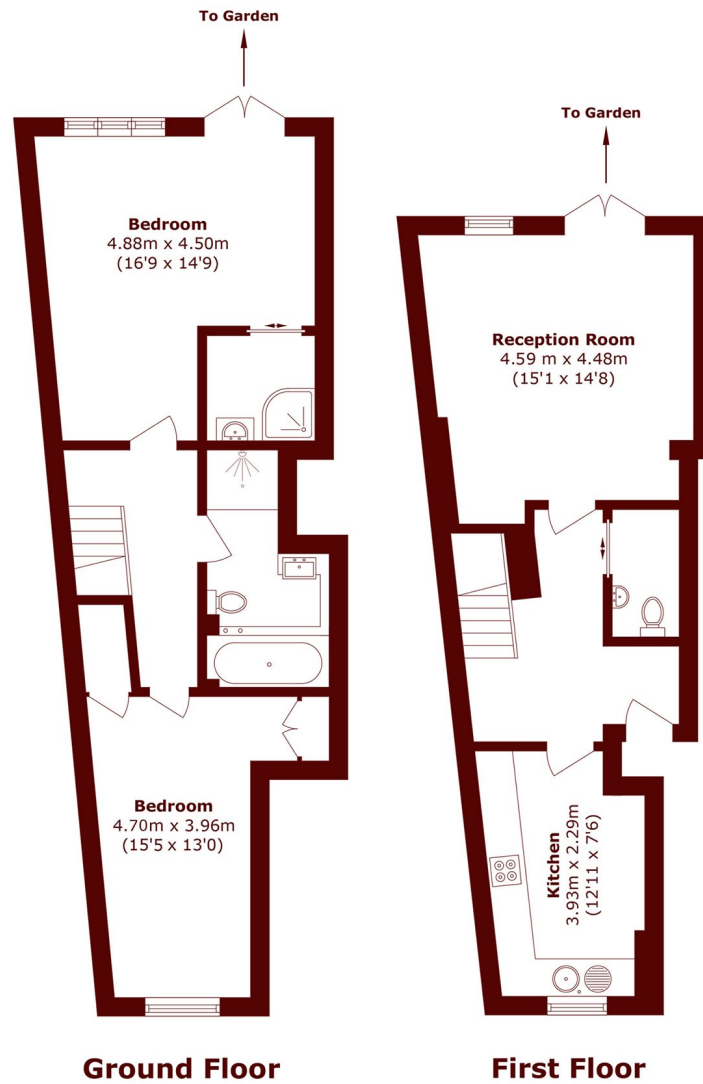

Total area (approx.): 89.8 sq. m (966.6 q. ft)

**Clapham**  
020 7501 3666

Energy Rating: C We aim to make our particulars both accurate and reliable. However, they are not guaranteed; nor do they form part of an offer or contract. If you require clarification on any points then please contact us, especially if you're traveling some distance to view. Please note that appliances and heating systems have not been tested and therefore no warranties can be given as to their good working order

**MARSH &  
PARSONS**