

Franklyn James



Schooner Close

Isle of Dogs, London, E14 3GG

£465,000

Situated within the sought-after riverside development of Schooner Close, this impressive split-level two-bedroom maisonette offers over 900 sq ft of beautifully presented living accommodation, moments from the heart of Canary Wharf.

Arranged over two floors, the property is accessed via a private first-floor entrance leading to a bright and spacious second-floor living area. The generous reception room is flooded with natural light and provides ample space for both relaxing and dining, while floor-to-ceiling patio doors open onto a private balcony. A separate fitted kitchen features integrated appliances, a gas hob, and an adjoining utility area, creating a practical and well-designed living environment.

The upper floor comprises two well-proportioned double bedrooms, both enhanced by large skylight windows that fill the rooms with natural light. A spacious family bathroom and excellent built-in storage complete the accommodation.

Ideally positioned on the Isle of Dogs, the property enjoys easy access to the open green spaces of Mudchute Park and Farm, scenic riverside walks, and a range of local amenities. Excellent transport connections are available via Mudchute, Crossharbour and Island Gardens DLR stations, providing swift access to Canary Wharf, the Jubilee Line, and Central London.

This superb duplex apartment presents an excellent opportunity for first-time buyers, professionals, or investors seeking a spacious home in a well-connected riverside setting.

- Chain-Free
- Split Level Maisonette
- Off-Road Parking
- Private Balcony

■ Close to Mudchute, Island Gardens, & Cross Harbour DLR stations

- 970 year lease

Viewing

Please contact our Limehouse Sales Office on 02077911777 if you wish to arrange a viewing appointment for this property or require further information.



Floor Plan

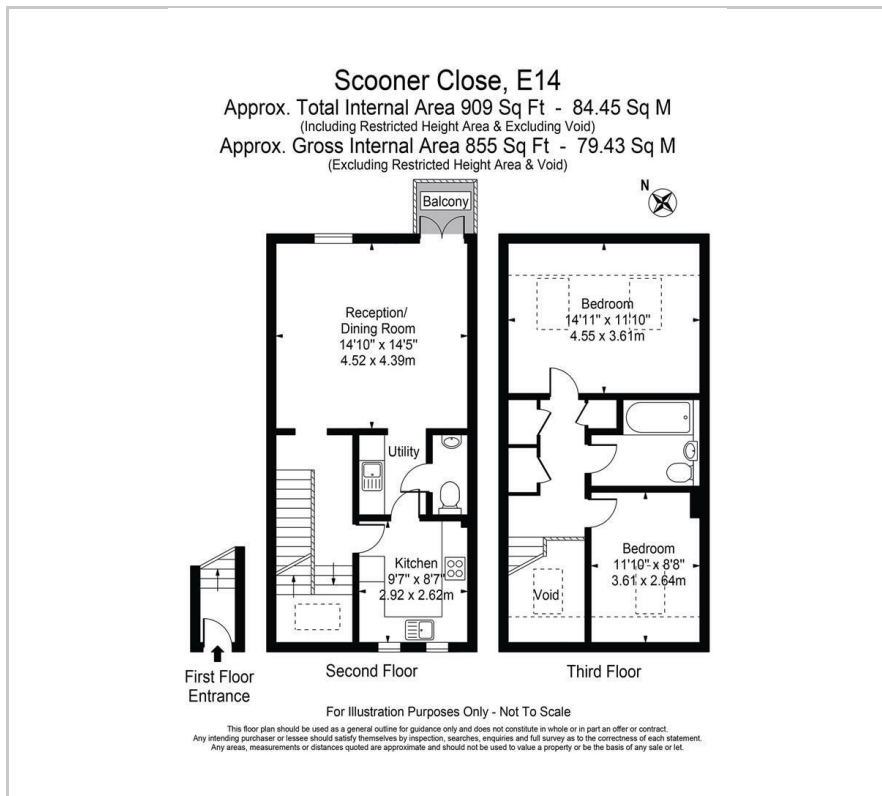

Area Map



Energy Efficiency Graph

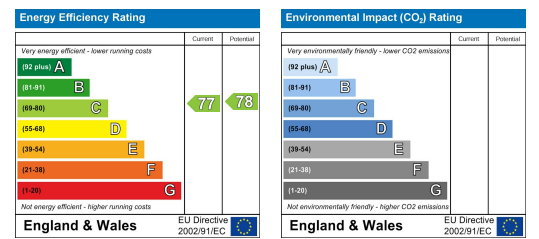

These particulars, whilst believed to be accurate are set out as a general outline only for guidance and do not constitute any part of an offer or contract. Intending purchasers should not rely on them as statements of representation of fact, but must satisfy themselves by inspection or otherwise as to their accuracy. No person in this firm's employment has the authority to make or give any representation or warranty in respect of the property.