



Connells

Fairway Road
Basingstoke



Property Description

Located on the modern and highly sought-after Fairway Road in Basingstoke, this three-bedroom townhouse offers spacious and versatile accommodation arranged over three floors, ideal for modern family living.

The ground floor comprises an entrance hallway with a convenient downstairs WC, a separate lounge featuring useful understairs storage, and a contemporary kitchen/diner to the rear. The kitchen/diner provides an excellent space for entertaining and benefits from French doors opening onto the private rear garden.

To the first floor is a bright and spacious reception room with French doors leading to a brick-built balcony, creating an additional outdoor seating area. This floor also includes a well-proportioned bedroom and a modern family bathroom.

The top floor offers two further bedrooms, including a generous main bedroom with access to a Jack & Jill en-suite bathroom, providing both convenience and privacy.

Externally, the property benefits from a full enclosed rear garden and allocated parking.



Area

Gillies Meadow is a modern development built by David Wilson homes in 2018 within the popular Rooksdown location. Close by are lovely country walks and Weybrook Park Golf Course.

Rooksdown - The property is local to convenience stores, schools, a cafe, Doctors Surgery and pharmacy. There are plenty of parks and open spaces close by, providing opportunity for walks and fresh air. The Basingstoke Town Centre is just under three miles away, housing the Festival Place Shopping Centre and The Malls with a variety of shops, restaurants, bars, and entertainment facilities. There are bus stops nearby with regular services into the Town Centre, and the Basingstoke Train Station has a direct line to London Waterloo. Also the M3, A33 and A339 are all easily accessible via car, offering plenty of travel links.







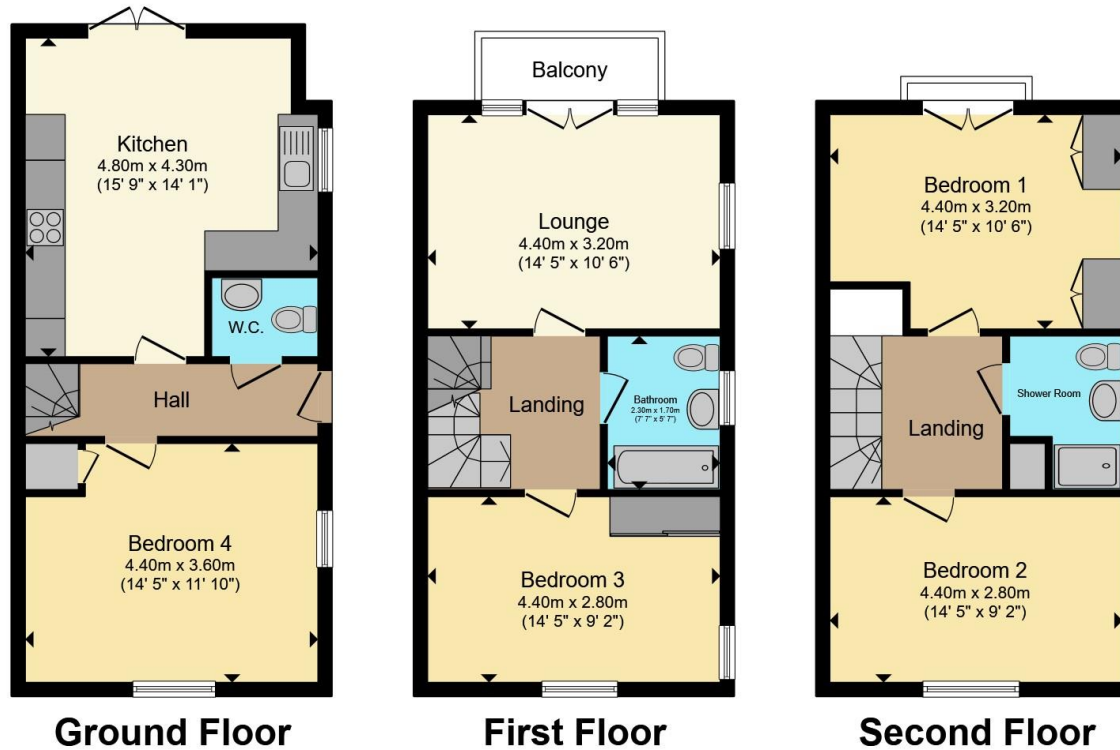

Total floor area 117.5 m² (1,265 sq.ft.) approx
 This floor plan is for illustrative purposes only. It is not drawn to scale. Any measurements, floor areas (including any total floor area), openings and orientation are approximate. No details are guaranteed, they cannot be relied upon for any purpose and they do not form part of any agreement. No liability is taken for any error, omission or misstatement. A party must rely upon its own inspection(s). Powered by www.propertybox.io



To view this property please contact Connells on

T 01256 464566
E basinstoke@connells.co.uk

1 Wote Street
 BASINGSTOKE RG21 7NE

EPC Rating: B Council Tax Band: E

Tenure: Freehold

view this property online connells.co.uk/Property/BTK314810



1. MONEY LAUNDERING REGULATIONS Intending purchasers will be asked to produce identification documentation at a later stage and we would ask for your co-operation in order that there will be no delay in agreeing the sale. 2. These particulars do not constitute part or all of an offer or contract. 3. The measurements indicated are supplied for guidance only and as such must be considered incorrect. Potential buyers are advised to recheck measurements before committing to any expense. 4. We have not tested any apparatus, equipment, fixtures, fittings or services and it is in the buyers interest to check the working condition of any appliances.

Connells Residential is registered in England and Wales under company number 1489613, Registered Office is Cumbria House, 16-20 Hockliffe Street, Leighton Buzzard, Bedfordshire, LU7 1GN. VAT Registration Number is 500 2481 05.

See all our properties at www.connells.co.uk | www.rightmove.co.uk | www.zoopla.co.uk

Property Ref: BTK314810 - 0004