





**POOLE
TOWNSEND**

Lowther Crescent, Walney, Barrow-in-furness, LA14 3RT

£230,000

 3  1  2



- Versatile Three Bedroom Home
- Single Garage
- Ideally Located To Local Amenities
- Dining Area With Access To The Garden
- Three Comfortable Bedrooms
- Driveway Parking For Multiple Cars
- Lovely Enclosed Garden
- Well Proportioned Rooms
- Open Plan Kitchen-Breakfast Room
- Designed For Ease And Modern Family Living



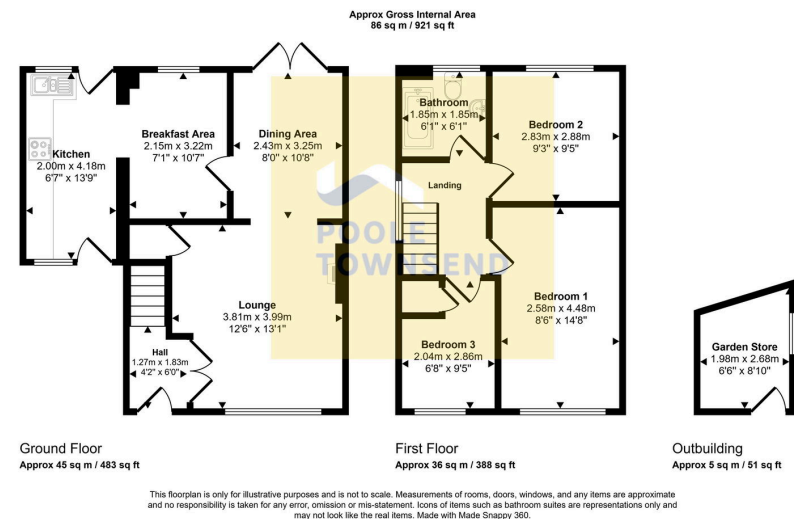

Discover this beautifully presented home, featuring versatile living spaces, driveway parking for multiple cars, a single garage, and a lovely enclosed garden, all ideally located for convenience and local amenities. With extended accommodation, this property offers a well-proportioned lounge, a dining area with garden access, an open-plan kitchen-breakfast room, and three comfortable bedrooms, designed for ease and modern family living.

Visit us at
www.pooletownsend.co.uk
enquiries@pooletownsend.co.uk

We are open
 Monday – Friday 9.00 – 5.00
 Saturday 9.00 – 1.00

Barrow 01229 811811
 Ulverston 01229 588111
 Grange 015395 33316
 Kendal 01539 734455
 Milnthorpe 015395 62044