



Keith
Ashton

Park Road,
Brentwood



69 PARK ROAD Brentwood, CMI 4 4TU

We are delighted to present to the market this impressive, detached family home, set within a generous plot and offering spacious, well-appointed accommodation arranged over three floors. The property provides well-balanced living space, ideally suited to both everyday family life and entertaining.

Perfectly positioned just 0.4 miles from Brentwood High Street, and within easy reach of highly regarded local schools and the mainline station, this home is ideally located for families and commuters alike.

- DETACHED FAMILY HOME
- LESS THAN A MILE TO BRENTWOOD STATION
- FOUR BEDROOMS
- LARGE REAR GARDEN
- TWO BATHROOMS
- EASY REACH OF HIGHLY REGARDED SCHOOLS
- STUDY
- JUST 0.45 MILES FROM THE HIGH STREET

Guide Price £995,000



Description

The internal layout begins with a welcoming entrance hall leading into a comfortable lounge, featuring a charming fire surround and a front-facing bow window that allows for plenty of natural light. To the rear, a bright and well-appointed kitchen is fitted with a range of eye and base level units, along with integrated appliances. Windows and a stable door provide views over and access to the rear garden.

The kitchen flows seamlessly into a breakfast area and also provides access to a more formal dining space, complete with French doors opening directly onto the garden. This area opens into a spacious sitting room, creating an impressive open-plan living and dining space ideal for both everyday family living and entertaining. A lobby area off the kitchen gives access to a ground floor shower room, completing the accommodation on this level.

To the first floor, the landing leads to two well-proportioned double bedrooms, a contemporary shower room, and a dedicated study, perfect for home working. The second floor offers two further bedrooms, both benefiting from useful eaves storage.

Externally, the rear garden is generously sized and thoughtfully landscaped, featuring a paved patio area leading onto an artificial lawn, bordered by mature hedging. This extends to a further section of garden, predominantly laid to lawn and again enclosed by established hedges and trees. To the front, a large block-paved driveway provides ample off-street parking and leads to the garage.



GROUND FLOOR
962 sq.ft. (89.4 sq.m.) approx.

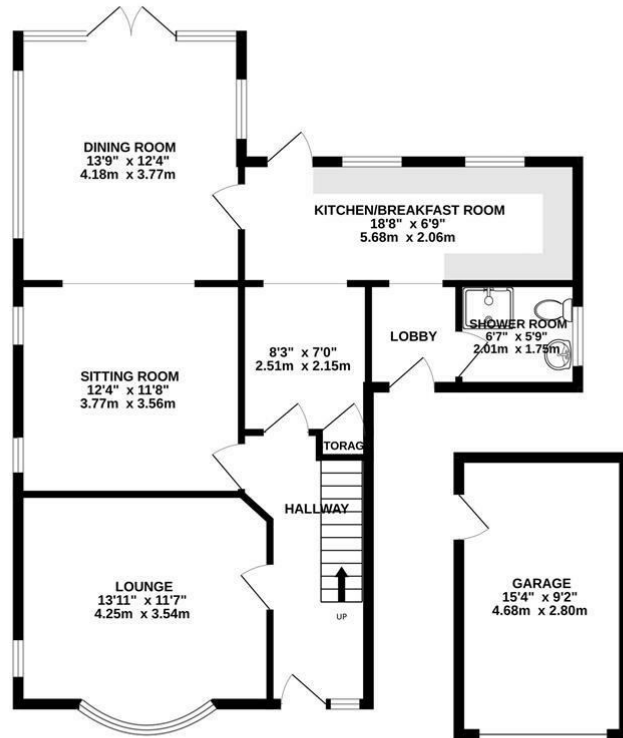

1ST FLOOR
452 sq.ft. (42.0 sq.m.) approx.

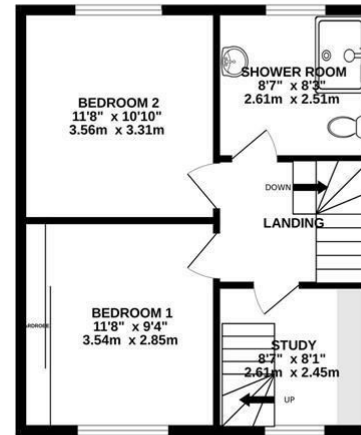

2ND FLOOR
310 sq.ft. (28.8 sq.m.) approx.

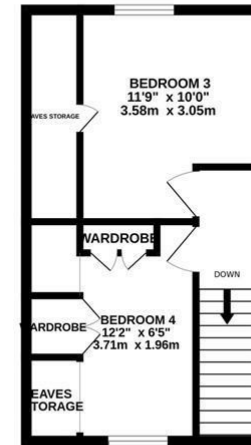

TOTAL FLOOR AREA : 1724 sq.ft. (160.2 sq.m.) approx.
Measurements are approximate. Not to scale. Illustrative purposes only
Made with Metropix ©2026

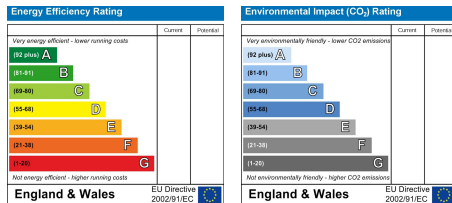

SERVICES:

Local Authority: Brentwood
Council tax band: F
Post code: CM14 4TU

VIEWING:

Strictly by prior arrangement with Keith Ashton Estate Agents

OPENING HOURS:

Monday to Friday: 8.45AM - 6.30PM | Saturdays: 9AM - 5.30PM | Sundays: 10AM - 2PM

MORTGAGE INFORMATION: We offer the additional facility of an in-house Independent Financial Adviser who will access all mortgage lenders with the purpose of providing you with the benefit of choice. For quotations or comparables please call 01277 260858 or visit our interactive website at www.mortgagebusiness.net



We the Agent have not tested any apparatus, fittings or services for this property. The plot size is intended merely as a guide and has not been officially measured or verified by the Agent. Photographs are for illustration only and may depict items which are not for sale or included in the sale of the property. As part of the service we offer we may recommend ancillary services to you which we believe may help you with your property transaction. We wish to make you aware, that should you decide to use these services we will receive a referral fee. For full and detailed information please visit 'terms and conditions' on our website www.keithashton.co.uk

Brentwood
Tel. 01277 260858

Village Office
Tel. 01277 375757

Lettings Office
Tel. 01277 202200

Explore more @ www.keithashton.co.uk