

BRUNTON

RESIDENTIAL



£110PPPW HEATON ROAD, HEATON, NEWCASTLE UPON TYNE

£2,860 Per Month

BRUNTON

RESIDENTIAL





BRUNTON
RESIDENTIAL



BRUNTON

RESIDENTIAL



*****360 Virtual Tour*** - Available 12th August 2026 - / £2,860pcm / £110pppw - Bills package available - 6 Large Double Bedrooms - 3 Shower rooms - Additional WC - Newly refurbished - Great Standard Fixtures & Fittings - Close to Both Uni's - Popular Student Location - Must Be Seen - Furnished**

BRUNTON

RESIDENTIAL



BRUNTON

RESIDENTIAL



BRUNTON

RESIDENTIAL

TENURE :

LOCAL AUTHORITY :

COUNCIL TAX BAND : A

EPC RATING : C

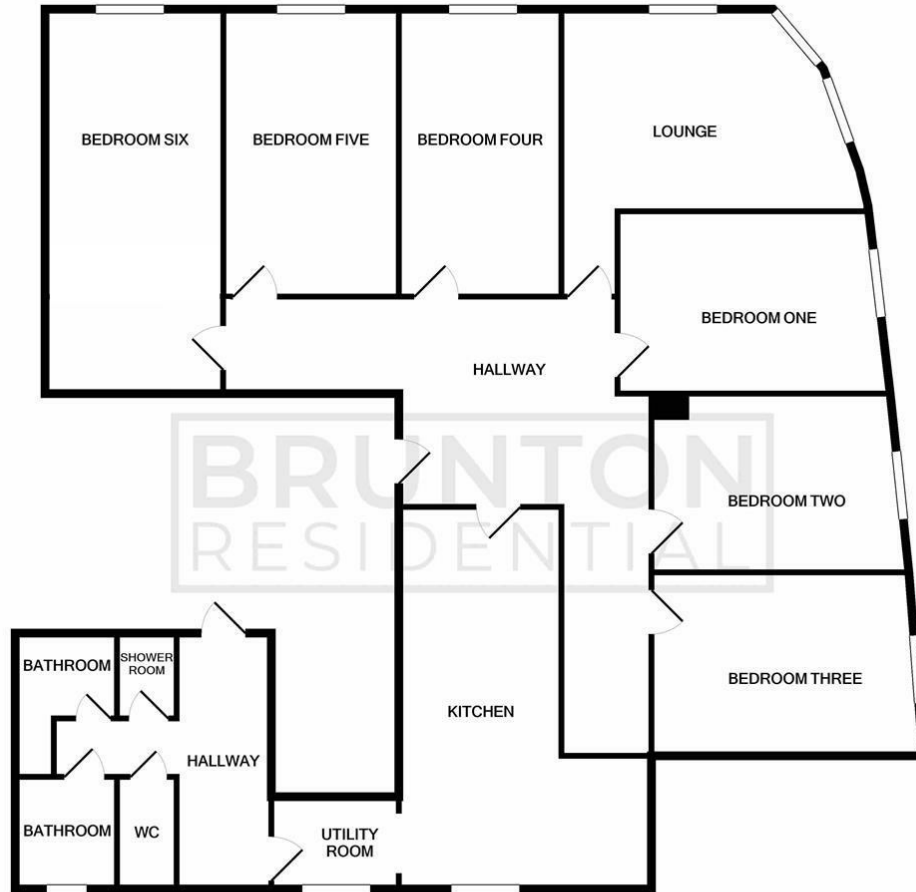

BRUNTON
RESIDENTIAL

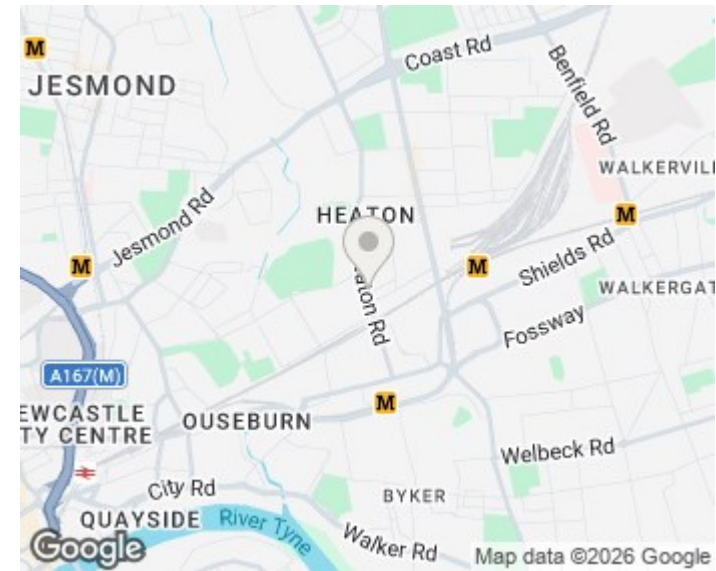

TOTAL APPROX. FLOOR AREA 1909 SQ.FT. (177.3 SQ.M.)
 Whilst every attempt has been made to ensure the accuracy of the floor plan contained here, measurements of doors, windows, rooms and any other items are approximate and no responsibility is taken for any error, omission, or mis-statement. This plan is for illustrative purposes only and should be used as such by any prospective purchaser. The services, systems and appliances shown have not been tested and no guarantee as to their operability or efficiency can be given
 Made with Metropix ©2020

| Energy Efficiency Rating | | Current | Potential |
|---------------------------------------------|---|-------------------------|-----------|
| Very energy efficient - lower running costs | | | |
| (92 plus) | A | | |
| (81-91) | B | | |
| (69-80) | C | 72 | 77 |
| (55-68) | D | | |
| (39-54) | E | | |
| (21-38) | F | | |
| (1-20) | G | | |
| Not energy efficient - higher running costs | | | |
| England & Wales | | EU Directive 2002/91/EC | |

| Environmental Impact (CO ₂) Rating | | Current | Potential |
|-----------------------------------------------------------------|---|-------------------------|-----------|
| Very environmentally friendly - lower CO ₂ emissions | | | |
| (92 plus) | A | | |
| (81-91) | B | | |
| (69-80) | C | 67 | 73 |
| (55-68) | D | | |
| (39-54) | E | | |
| (21-38) | F | | |
| (1-20) | G | | |
| Not environmentally friendly - higher CO ₂ emissions | | | |
| England & Wales | | EU Directive 2002/91/EC | |