



## Raphael Drive

Watford, WD24 4GX

£1,500



Well Presented This ground-floor maisonette is located in a quiet cul-de-sac off Radlett Road. The accommodation includes an entrance hall, a spacious lounge/dining room with direct access to its own private garden area, and a modern fitted kitchen complete with appliances, two bedrooms and bathroom. The property is convenient located, less than half a mile from Watford Junction Station and Watford town centre. The M1 and M25 motorways are also just a few minutes away.





## Area Map



## Floor Plans

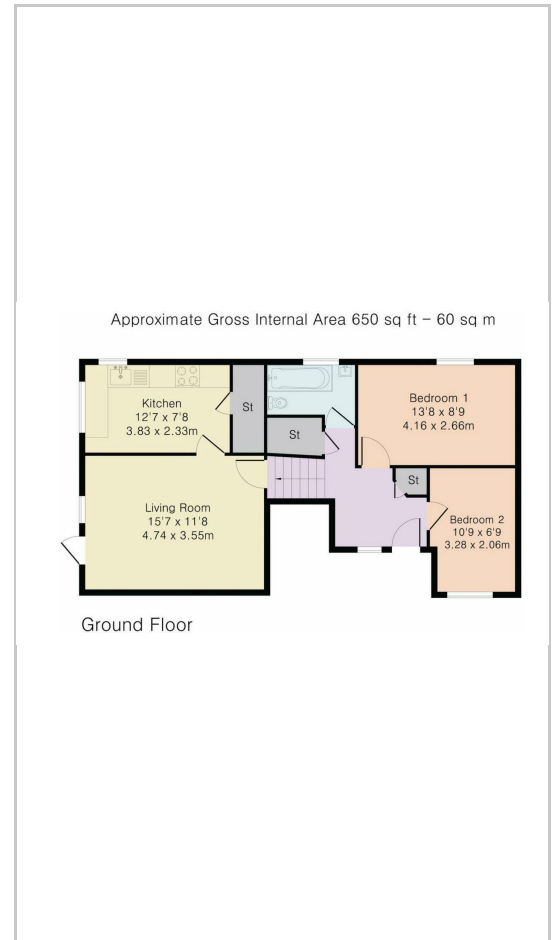

## Energy Efficiency Graph

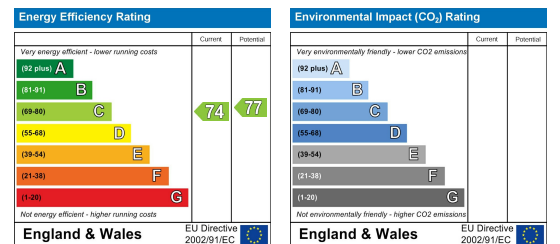

These particulars, whilst believed to be accurate are set out as a general outline only for guidance and do not constitute any part of an offer or contract. Intending purchasers should not rely on them as statements of representation of fact, but must satisfy themselves by inspection or otherwise as to their accuracy. No person in this firm's employment has the authority to make or give any representation or warranty in respect of the property.