

BELVOIR!

Property is personal



£300,000

Packwood Crescent

Northampton, NN6 0FA

PROPERTY SUMMARY

Belvoir Estate Agents are delighted to offer for sale this modern three bedroom semi detached house located in the popular village of Earls Barton. The well presented accommodation briefly comprises entrance hall, cloakroom, lounge, kitchen/diner, first floor landing, bedroom one with ensuite, two further bedrooms and a bathroom. The property further benefits from gas radiator central heating, upvc double glazing, driveway providing off road parking for two vehicles and a good sized rear garden.

3



2



2









Packwood Crescent, Earls Barton

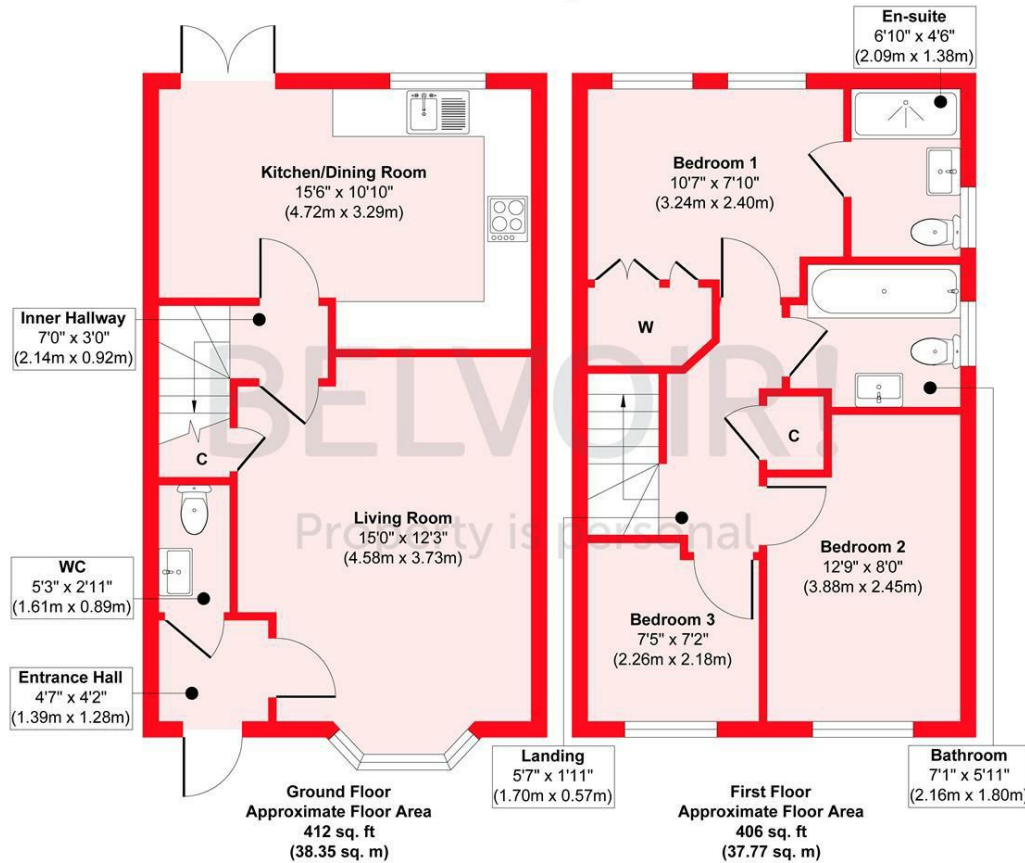

Approx. Gross Internal Floor Area 818 sq. ft / 76.12 sq. m

Illustration for identification purposes only, measurements are approximate, not to scale.

Produced by Elements Property

LOCAL AUTHORITY

Wellingborough

TENURE

Freehold

COUNCIL TAX BAND

C

VIEWINGS

By prior appointment only

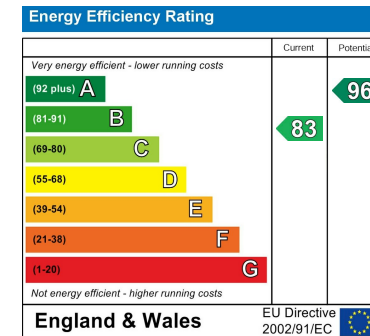

Agents Note: Whilst every care has been taken to prepare these particulars, they are for guidance purposes only. All measurements are approximate and are for general guidance purposes only and whilst every care has been taken to ensure their accuracy, they should not be relied upon and potential buyers/tenants are advised to recheck the measurements

BELVOIR!

Property is personal

OFFICE ADDRESS

East Hunsbury Local Centre Butts
Road
Northampton
Northamptonshire
NN4 0UE

OFFICE DETAILS

01604 701701
northampton@belvoir.co.uk
www.belvoirnorthampton.com