



Judd Street, WC1H

£2,145 Per calendar month

Well presented one bedroom flat in an art deco portered block. There is lots of natural into the property from the large windows, wood floors throughout and an open plan modern feel throughout.

Clare Court is a listed art deco block on but set back from Judd Street in central Bloomsbury. Russell Square and Kings Cross underground stations are both nearby. The Brunswick Centre is on the doorstep with Waitrose, cafes and restaurants in abundance.

Features

- UCL Nearby
- Wood Floors
- Portered Building
- Modern Bathroom
- Modern Open Plan
- Lovely Art Deco Block

Judd Street,
London, WC1H

CLARE COURT

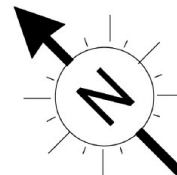

Bathroom
7'9" x 4'11"
2.36 x 1.50m

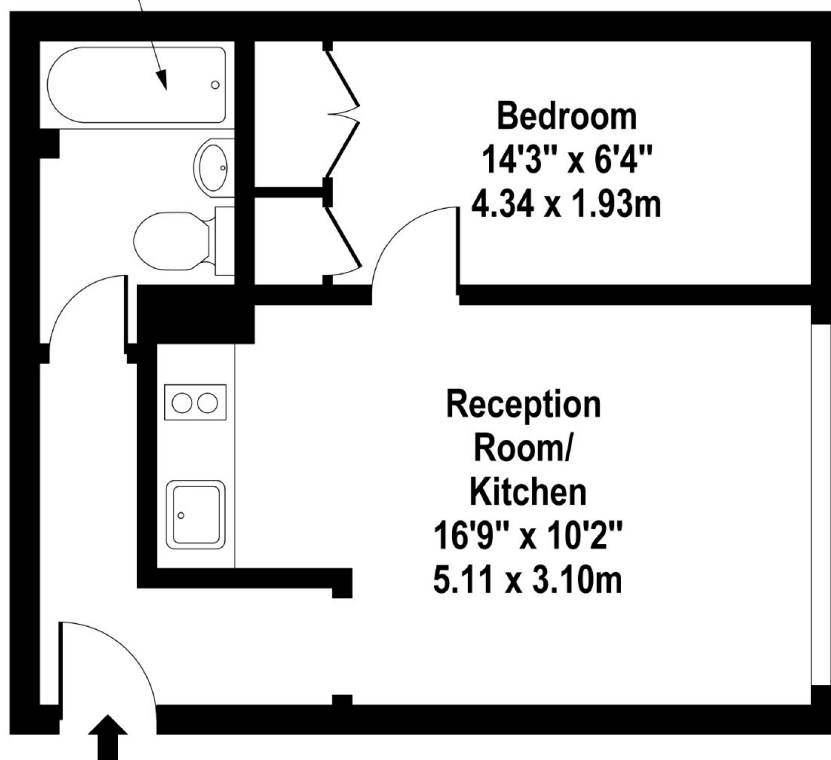

Ground Floor

Approx Gross Internal Area **335 Sq Ft - 31.12 Sq M**

Whilst every attempt has been made to ensure the accuracy of the floorplan shown, all measurements, positioning fixtures, fittings and any other data shown are an approximate interpretation for illustrative purposes only and are not to scale. No responsibility is taken for any error, omission, mis-statement or use of data shown.

Dexters

Bloomsbury
55-56 Coram Street
London
WC1N 1HB
Lettings
020 7833 4488

Energy Rating: D. We aim to make our particulars both accurate and reliable. However they are not guaranteed; nor do they form part of an offer or contract. If you require clarification on any points then please contact us, especially if you're traveling some distance to view. Please note that appliances and heating systems have not been tested and therefore no warranties can be given as to their good working order.

 **RICS** | Regulated
Estate Agent
and Letting Agent

dexters.co.uk